

# Panasonic FK 系列 铝电解电容器, 表面贴装型 (接上页)

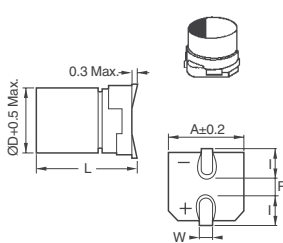

| 额定 W.V. (VDC) | 标称电容 (μF) | tan δ ≤ 指定值 (120Hz, +20°C) | 阻抗 (Ω) | 最大漏电流 (μA) | 尺寸代码 | 最大纹波电流 (在 100kHz 及 105°C 时) (mA rms) | Digi-Key 零件编号 | 剪切带价格        |       |       | 带卷    |        | Panasonic 零件编号 |              |
|---------------|-----------|----------------------------|--------|------------|------|--------------------------------------|---------------|--------------|-------|-------|-------|--------|----------------|--------------|
|               |           |                            |        |            |      |                                      |               | 1            | 50    | 100   | 数量    | 价格     |                |              |
| 63            | 4.7       | 0.08                       | 3.00   | 3.0        | C    | 50                                   | PCE3478CT-ND  | .57          | 17.11 | 29.95 | 1,000 | 121.21 | EEV-FK1J4R7R   |              |
|               | 10        | 0.08                       | 1.50   | 6.0        | D    | 80                                   | PCE3479CT-ND  | .67          | 20.16 | 35.28 | 1,000 | 142.80 | EEV-FK1J100P   |              |
|               | 22        | 0.08                       | 1.20   | 13.9       | D8   | 120                                  | PCE3524CT-ND  | .92          | 27.48 | 48.09 | 900   | 185.49 | EEV-FK1J220XP  |              |
|               | 33        | 0.08                       | 1.20   | 13.9       | E    | 120                                  | PCE3480CT-ND  | .86          | 27.50 | 49.50 | 1,000 | 220.00 | EEV-FK1J220P   |              |
|               | 33        | 0.08                       | 0.65   | 20.8       | F    | 250                                  | PCE3481CT-ND  | 1.11         | 35.62 | 64.12 | 500   | 169.20 | EEV-FK1J330P   |              |
|               | 47        | 0.08                       | 0.65   | 29.6       | F    | 250                                  | PCE3482CT-ND  | 1.11         | 35.62 | 64.12 | 500   | 169.20 | EEV-FK1J470P   |              |
|               | 68        | 0.08                       | 0.35   | 42.8       | G    | 400                                  | PCE3525CT-ND  | 1.17         | 39.65 | 72.00 | 500   | 188.00 | EEV-FK1J680P   |              |
|               | 100       | 0.08                       | 0.35   | 63.0       | G    | 400                                  | PCE3483CT-ND  | 1.17         | 39.65 | 72.00 | 500   | 187.83 | EEV-FK1J101P   |              |
|               | 80        | 3.3                        | 0.08   | 5.00       | 3.0  | C                                    | 25            | PCE3487CT-ND | .57   | 17.11 | 29.95 | 1,000  | 121.21         | EEV-FK1K3R3R |
|               |           | 4.7                        | 0.08   | 3.00       | 3.8  | D                                    | 40            | PCE3488CT-ND | .67   | 20.16 | 35.28 | 1,000  | 142.80         | EEV-FK1K4R7P |
| 10            |           | 0.08                       | 2.40   | 8.0        | D8   | 60                                   | PCE3527CT-ND  | .92          | 27.48 | 48.09 | 900   | 185.49 | EEV-FK1K100XP  |              |
| 10            |           | 0.08                       | 2.40   | 8.0        | E    | 60                                   | PCE3489CT-ND  | .86          | 27.50 | 49.50 | 1,000 | 220.00 | EEV-FK1K100P   |              |
| 22            |           | 0.08                       | 1.30   | 17.6       | F    | 130                                  | PCE3490CT-ND  | 1.11         | 35.62 | 64.12 | 500   | 169.20 | EEV-FK1K220P   |              |
| 33            |           | 0.08                       | 1.30   | 26.4       | F    | 130                                  | PCE3491CT-ND  | 1.11         | 35.62 | 64.12 | 500   | 169.20 | EEV-FK1K330P   |              |
| 47            |           | 0.08                       | 0.70   | 37.6       | G    | 200                                  | PCE3492CT-ND  | 1.17         | 39.65 | 72.00 | 500   | 187.83 | EEV-FK1K470P   |              |
| 22            |           | 0.07                       | 1.30   | 22.0       | F    | 130                                  | PCE3502CT-ND  | 1.10         | 35.14 | 63.25 | 500   | 166.92 | EEV-FK2A220P   |              |
| 33            |           | 0.07                       | 0.70   | 33.0       | G    | 200                                  | PCE3503CT-ND  | 1.15         | 38.84 | 70.52 | 500   | 183.96 | EEV-FK2A330    |              |

# Panasonic FP 系列 铝电解电容器, 表面贴装型 - 高温回流 (260°C)



技术规格: • 工作温度范围: -55°C ~ 105°C • 电容公差: ±20% (120Hz, 20°C) • 漏电流: I ≤ 0.01CV 或 3 (μA), 在 20°C 施加 2 分钟的额定工作电压后测得的较大值 • 低温特性: 阻抗比 (120Hz)  
焊接: 回流焊 (I.R. 或 I.R. + 热空气, 不允许 VPS)

参照指定数值:

| 阻抗 120Hz   | 额定工作电压 |     |     |     |     |
|------------|--------|-----|-----|-----|-----|
|            | 6.3V   | 10V | 16V | 25V | 35V |
| -25°C/20°C | 2      | 2   | 2   | 2   | 2   |
| -40°C/20°C | 3      | 3   | 3   | 3   | 3   |
| -55°C/20°C | 4      | 4   | 4   | 3   | 3   |

| 罐尺寸 - mm (尺寸代码)                       | 峰值温度  | 持续时间 (温度 >255°C) | 持续时间 (温度 >230°C) | 回流频率 |
|---------------------------------------|-------|------------------|------------------|------|
| ø4 ~ ø6.3, ø8 x 10.2 (B, C, D, D8, F) | 260°C | 5 秒              | 60 秒             | 2±   |
| ø8 x 6.2, ø10 x 10.2 (E, G)           | 260°C | 5 秒              | 60 秒             | 1    |

| 尺寸代码 | 尺寸 - mm |      |      |     |           |
|------|---------|------|------|-----|-----------|
|      | øD      | L    | A    | W   | P         |
| B    | 4.0     | 5.8  | 4.3  | 1.8 | 0.65 ±0.1 |
| C    | 5.0     | 5.8  | 5.3  | 2.2 | 0.65 ±0.1 |
| D    | 6.3     | 5.8  | 6.6  | 2.6 | 0.65 ±0.1 |
| D8   | 8.0     | 6.2  | 8.3  | 3.4 | 0.65 ±0.1 |
| E    | 8.0     | 10.2 | 8.3  | 3.4 | 0.90 ±0.2 |
| G    | 10.0    | 10.2 | 10.3 | 3.5 | 0.90 ±0.2 |

† 电容必须恢复至室温之后才能进行第二次回流焊

| 额定 W.V. (VDC) | 标称电容 (μF) | tan δ ≤ 指定值 (120Hz, 20°C) | ESR (Ω) | 最大漏电流 (μA) | 尺寸代码 | 最大纹波电流 (在 100kHz 及 105°C 时) (mA rms) | Digi-Key 零件编号 | 剪切带价格 |       |       | 带卷     |                | Panasonic 零件编号 |
|---------------|-----------|---------------------------|---------|------------|------|--------------------------------------|---------------|-------|-------|-------|--------|----------------|----------------|
|               |           |                           |         |            |      |                                      |               | 1     | 50    | 100   | 数量     | 价格             |                |
| 6.3           | 22        | 0.26                      | 0.85    | 3.0        | B    | 160                                  | PCE4510CT-ND  | .66   | 18.84 | 31.40 | 2,000  | 112.00M        | EEE-FPJ220AR   |
|               | 47        | 0.26                      | 0.36    | 3.0        | C    | 240                                  | PCE4511CT-ND  | .60   | 17.95 | 31.42 | 1,000  | 126.00         | EEE-FPJ470AR   |
|               | 47        | 0.26                      | 0.85    | 3.0        | B    | 160                                  | PCE4512CT-ND  | .69   | 19.80 | 33.00 | 2,000  | 117.00M        | EEE-FPJ470UAR  |
|               | 100       | 0.26                      | 0.26    | 6.3        | D    | 300                                  | PCE4513CT-ND  | .71   | 21.19 | 37.09 | 1,000  | 148.00         | EEE-FPJ101AP   |
|               | 100       | 0.26                      | 0.36    | 6.3        | C    | 240                                  | PCE4514CT-ND  | .63   | 18.94 | 33.14 | 1,000  | 132.00         | EEE-FPJ101UAR  |
|               | 220       | 0.26                      | 0.26    | 13.8       | D    | 300                                  | PCE4515CT-ND  | .71   | 21.19 | 37.09 | 1,000  | 148.00         | EEE-FPJ221AP   |
|               | 330       | 0.26                      | 0.18    | 20.7       | E    | 500                                  | PCE4516CT-ND  | .90   | 28.88 | 51.98 | 1,000  | 228.00         | EEE-FPJ331AP   |
|               | 330       | 0.26                      | 0.16    | 20.7       | D8   | 600                                  | PCE4517CT-ND  | .96   | 29.90 | 50.57 | 900    | 192.60         | EEE-FPJ331XAP  |
|               | 470       | 0.26                      | 0.08    | 29.6       | F    | 850                                  | PCE4518CT-ND  | 1.05  | 35.57 | 64.58 | 500    | 166.00         | EEE-FPJ471AP   |
|               | 1000      | 0.26                      | 0.08    | 63.0       | F    | 850                                  | PCE4430CT-ND  | 1.05  | 35.34 | 64.17 | 500    | 164.50         | EEE-FPJ102AP   |
| 10            | 1500      | 0.26                      | 0.06    | 94.5       | G    | 1190                                 | PCE4431CT-ND  | 1.23  | 41.40 | 75.18 | 500    | 192.50         | EEE-FPJ152AP   |
|               | 1800      | 0.26                      | 0.08    | 113.4      | G    | 850                                  | PCE4432CT-ND  | 1.35  | 45.56 | 82.73 | 500    | 212.00         | EEE-FPJ182UAR  |
|               | 22        | 0.19                      | 0.85    | 3.0        | B    | 160                                  | PCE4519CT-ND  | .66   | 18.84 | 31.40 | 2,000  | 112.00M        | EEE-FPIA220AR  |
|               | 33        | 0.19                      | 0.36    | 3.3        | C    | 240                                  | PCE4520CT-ND  | .60   | 17.95 | 31.42 | 1,000  | 126.00         | EEE-FPIA330AR  |
|               | 33        | 0.19                      | 0.85    | 3.3        | B    | 160                                  | PCE4521CT-ND  | .69   | 19.80 | 33.00 | 2,000  | 117.00M        | EEE-FPIA330UAR |
|               | 150       | 0.19                      | 0.26    | 15.0       | D    | 300                                  | PCE4522CT-ND  | .71   | 21.19 | 37.09 | 1,000  | 148.00         | EEE-FPIA151AP  |
|               | 220       | 0.19                      | 0.18    | 22.0       | E    | 500                                  | PCE4523CT-ND  | .90   | 28.88 | 51.98 | 1,000  | 228.00         | EEE-FPIA221AP  |
|               | 220       | 0.19                      | 0.16    | 22.0       | D8   | 600                                  | PCE4524CT-ND  | .96   | 29.90 | 50.57 | 900    | 192.60         | EEE-FPIA221XAP |
|               | 330       | 0.19                      | 0.08    | 33.0       | F    | 850                                  | PCE4525CT-ND  | 1.05  | 35.57 | 64.58 | 500    | 166.00         | EEE-FPIA331AP  |
|               | 470       | 0.19                      | 0.08    | 47.0       | F    | 850                                  | PCE4526CT-ND  | 1.05  | 35.57 | 64.58 | 500    | 166.00         | EEE-FPIA471AP  |
| 16            | 680       | 0.19                      | 0.08    | 68.0       | F    | 850                                  | PCE4433CT-ND  | 1.05  | 35.34 | 64.17 | 500    | 164.50         | EEE-FPIA681AP  |
|               | 1000      | 0.19                      | 0.06    | 100.0      | G    | 1190                                 | PCE4434CT-ND  | 1.23  | 41.40 | 75.18 | 500    | 192.50         | EEE-FPIA102AP  |
|               | 1200      | 0.19                      | 0.08    | 120.0      | G    | 850                                  | PCE4435CT-ND  | 1.35  | 45.56 | 82.73 | 500    | 212.00         | EEE-FPIA122UAR |
|               | 10        | 0.16                      | 0.85    | 3.0        | B    | 160                                  | PCE4527CT-ND  | .66   | 18.84 | 31.40 | 2,000  | 112.00M        | EEE-FP1C100AR  |
|               | 22        | 0.16                      | 0.36    | 3.5        | C    | 240                                  | PCE4528CT-ND  | .60   | 17.95 | 31.42 | 1,000  | 126.00         | EEE-FP1C220AR  |
|               | 22        | 0.16                      | 0.85    | 3.5        | B    | 160                                  | PCE4529CT-ND  | .69   | 19.80 | 33.00 | 2,000  | 117.00M        | EEE-FP1C220UAR |
|               | 47        | 0.16                      | 0.26    | 7.5        | D    | 300                                  | PCE4530CT-ND  | .71   | 21.19 | 37.09 | 1,000  | 148.00         | EEE-FP1C470AP  |
|               | 47        | 0.16                      | 0.36    | 7.5        | C    | 240                                  | PCE4531CT-ND  | .63   | 18.94 | 33.14 | 1,000  | 132.00         | EEE-FP1C470UAR |
|               | 68        | 0.16                      | 0.26    | 10.8       | D    | 300                                  | PCE4532CT-ND  | .71   | 21.19 | 37.09 | 1,000  | 148.00         | EEE-FP1C680AP  |
|               | 100       | 0.16                      | 0.26    | 16.0       | D    | 300                                  | PCE4533CT-ND  | .71   | 21.19 | 37.09 | 1,000  | 148.00         | EEE-FP1C101AP  |
| 25            | 100       | 0.16                      | 16.0    | D8         | 600  | PCE4534CT-ND                         | .96           | 29.90 | 50.57 | 900   | 192.60 | EEE-FP1C101XAP |                |
|               | 150       | 0.16                      | 0.16    | 24.0       | D8   | 600                                  | PCE4535CT-ND  | .96   | 29.90 | 50.57 | 900    | 192.60         | EEE-FP1C151XAP |
|               | 220       | 0.16                      | 0.18    | 35.2       | E    | 500                                  | PCE4536CT-ND  | .90   | 28.88 | 51.98 | 1,000  | 228.00         | EEE-FP1C221AP  |
|               | 220       | 0.16                      | 0.16    | 35.2       | D8   | 600                                  | PCE4537CT-ND  | .96   | 29.90 | 50.57 | 900    | 192.60         | EEE-FP1C221XAP |
|               | 330       | 0.16                      | 0.08    | 52.8       | F    | 850                                  | PCE4538CT-ND  | 1.05  | 35.57 | 64.58 | 500    | 166.00         | EEE-FP1C331AP  |
|               | 470       | 0.16                      | 0.08    | 75.2       | F    | 850                                  | PCE4436CT-ND  | 1.05  | 35.34 | 64.17 | 500    | 164.50         | EEE-FP1C471AP  |
|               | 680       | 0.16                      | 0.06    | 108.8      | G    | 1190                                 | PCE4437CT-ND  | 1.23  | 41.40 | 75.18 | 500    | 192.50         | EEE-FP1C681AP  |
|               | 820       | 0.16                      | 0.08    | 131.2      | G    | 850                                  | PCE4438CT-ND  | 1.35  | 45.56 | 82.73 | 500    | 212.00         | EEE-FP1C821UAR |
|               | 10        | 0.14                      | 0.85    | 3.0        | B    | 160                                  | PCE4539CT-ND  | .66   | 18.84 | 31.40 | 2,000  | 112.00M        | EEE-FP1E100AR  |
|               | 22        | 0.14                      | 0.36    | 5.5        | C    | 240                                  | PCE4540CT-ND  | .60   | 17.95 | 31.42 | 1,000  | 126.00         | EEE-FP1E220AR  |
| 35            | 33        | 0.14                      | 0.26    | 8.2        | D    | 300                                  | PCE4541CT-ND  | .71   | 21.19 | 37.09 | 1,000  | 148.00         | EEE-FP1E330AP  |
|               | 33        | 0.14                      | 0.36    | 8.2        | C    | 240                                  | PCE4542CT-ND  | .63   | 18.94 | 33.14 | 1,000  | 132.00         | EEE-FP1E330UAR |
|               | 47        | 0.14                      | 0.26    | 11.7       | D    | 300                                  | PCE4543CT-ND  | .71   | 21.19 | 37.09 | 1,000  | 148.00         | EEE-FP1E470AP  |
|               | 68        | 0.14                      | 0.26    | 17.0       | D    | 300                                  | PCE4544CT-ND  | .71   | 21.19 | 37.09 | 1,000  | 148.00         | EEE-FP1E680AP  |
|               | 100       | 0.14                      | 0.18    | 25.0       | E    | 500                                  | PCE4545CT-ND  | .90   | 28.88 | 51.98 | 1,000  | 228.00         | EEE-FP1E101AP  |
|               | 100       | 0.14                      | 0.16    | 25.0       | D8   | 600                                  | PCE4546CT-ND  | .96   | 29.90 | 50.57 | 900    | 192.60         | EEE-FP1E101XAP |
|               | 150       | 0.14                      | 0.08    | 37.5       | F    | 850                                  | PCE4547CT-ND  | 1.05  | 35.57 | 64.58 | 500    | 166.00         | EEE-FP1E151AP  |
|               | 220       | 0.14                      | 0.08    | 55.0       | F    | 850                                  | PCE4548CT-ND  | 1.05  | 35.57 | 64.58 | 500    | 166.00         | EEE-FP1E221AP  |
|               | 470       | 0.14                      | 0.06    | 117.5      | G    | 1190                                 | PCE4440CT-ND  | 1.23  | 41.40 | 75.18 | 500    | 192.50         | EEE-FP1E471AP  |
|               | 560       | 0.14                      | 0.08    | 140.0      | G    | 850                                  | PCE4441CT-ND  | 1.35  | 45.56 | 82.73 | 500    | 212.00         | EEE-FP1E561UAR |
| 100           | 10        | 0.12                      | 0.85    | 3.5        | B    | 160                                  | PCE4549CT-ND  | .69   | 19.80 | 33.00 | 2,000  | 117.00M        | EEE-FP1V100UAR |
|               | 22        | 0.12                      | 0.36    | 7.7        | C    | 240                                  | PCE4550CT-ND  | .60   | 17.95 | 31.42 | 1,000  | 126.00         | EEE-FP1V220AR  |
|               | 33        | 0.12                      | 0.26    | 11.5       | D    | 300                                  | PCE4551CT-ND  | .71   | 21.19 | 37.09 | 1,000  | 148.00         | EEE-FP1V330AP  |
|               | 47        | 0.12                      | 0.26    | 16.4       | D    | 300                                  | PCE4552CT-ND  | .71   | 21.19 | 37.09 | 1,000  | 148.0          |                |