



WAKEFIELD
Thermal Solutions

"Thermal Management Solutions and Aluminum Extrusions since 1957"

THERMAL MANAGEMENT SOLUTIONS FOR DC/DC CONVERTERS

Product Designation • Order Guide

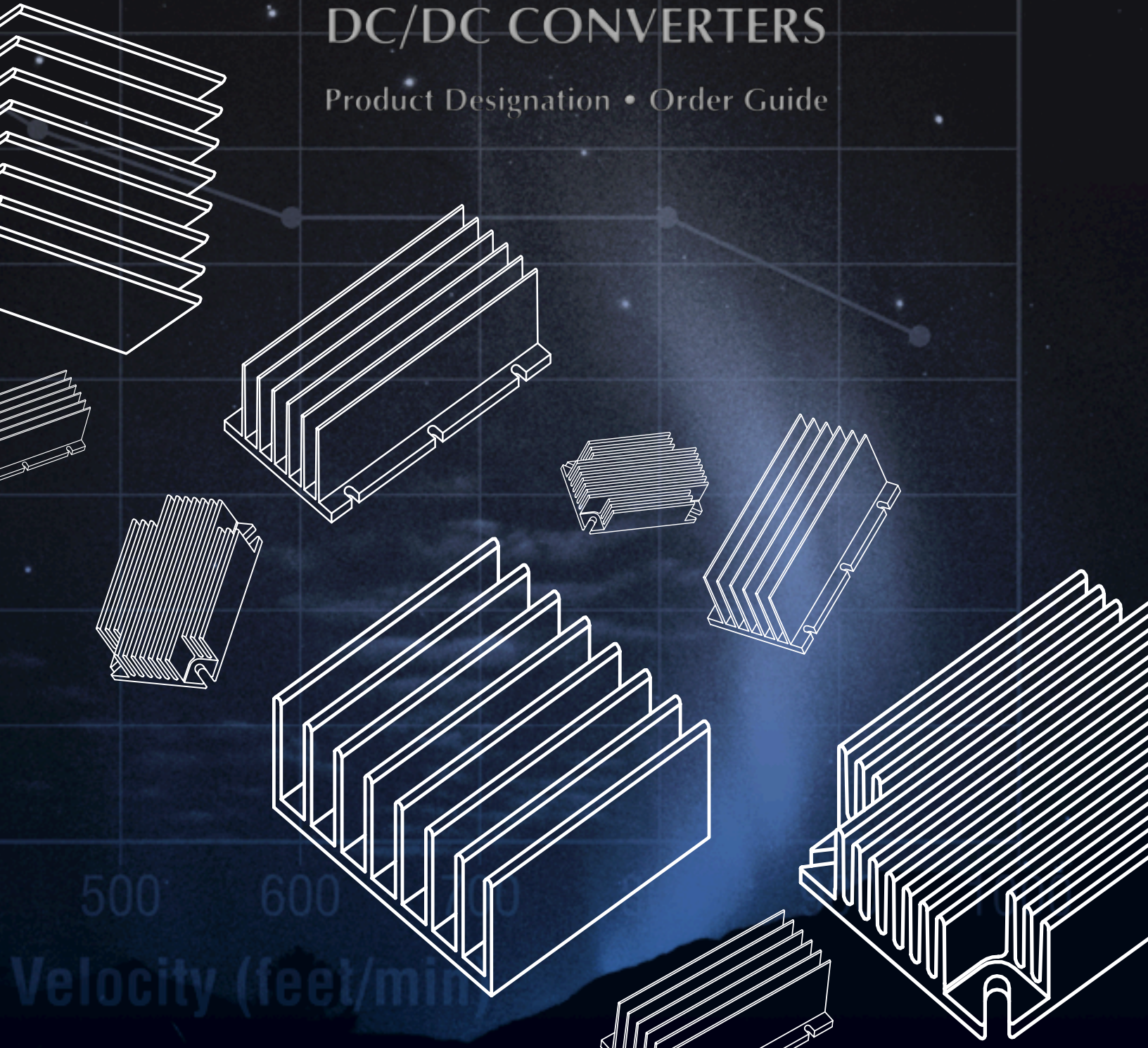

500

600

700

800

900

1000

Velocity (feet/min)

Extruded Heat Sinks for DC/DC Converters

Series 537 and 547: Heat sinks for "Quarter-Brick" DC/DC Devices

QUARTER-BRICK

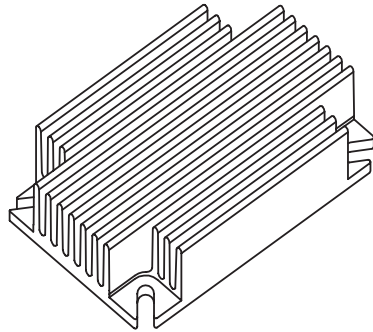

- Mounting slots accommodate two hole patterns: 1.86" x 1.03" and 2.00" x 1.20", fitting the vast majority of quarter brick converters on the market.
- Designed for optimum use in forced convection applications.
- Vertical and horizontal fin configurations available in a variety of fin heights.
- Black anodize finish standard.
- Integral thermal interface pad option eliminates need to order and install pad separately.
- Ordering a single part number with the hardware kit option provides everything necessary to keep your converter cool.

PRODUCT DESIGNATION

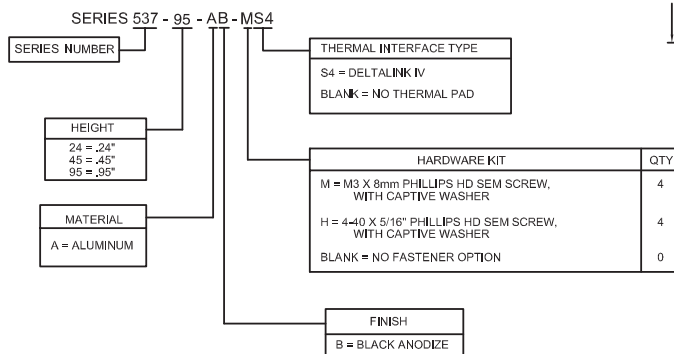

537 SERIES DIMENSIONS

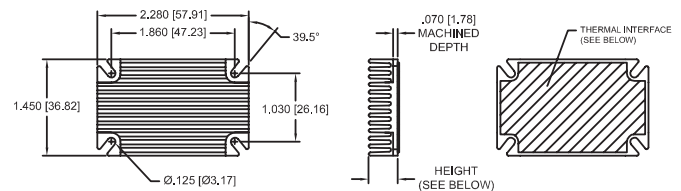

547 SERIES DIMENSIONS

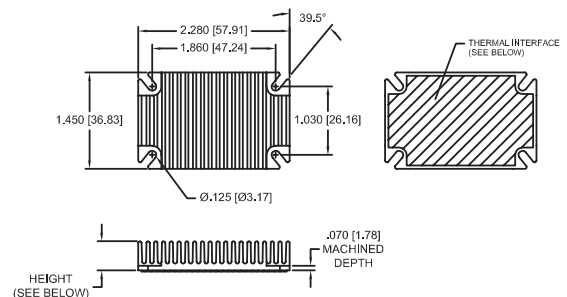

SERIES 537 AND 547 Heat Sinks for "Quarter Brick" DC/DC Converters

Standard P/N	Footprint Dimensions in. (mm)	Height in. (mm)	Fin Orientation	Number of fins	Forced Convection Thermal Resistance at 300 ft/min (C/W)
537-95AB	2.28 (57.9) x 1.45 (36.8)	0.95 (24.1)	Horizontal	8	2.1
537-45AB	2.28 (57.9) x 1.45 (36.8)	0.45 (11.4)	Horizontal	13	2.3
537-24AB	2.28 (57.9) x 1.45 (36.8)	0.24 (6.1)	Horizontal	14	4.2
547-95AB	1.45 (36.8) x 2.28 (57.9)	0.95 (24.1)	Vertical	11	2.2
547-45AB	1.45 (36.8) x 2.28 (57.9)	0.45 (11.4)	Vertical	20	2.1
547-24AB	1.45 (36.8) x 2.28 (57.9)	0.24 (6.1)	Vertical	22	3.5

Material: Aluminum, Black Anodize

All trademarks and tradenames used in this publication are for identification purposes only and may be trademarks of their respective companies.
All specifications subject to change without notification.

Extruded Heat Sinks for DC/DC Converters

Series 557, 558 and 559: Heat sinks for "Full-Brick" DC/DC Devices

FULL-BRICK

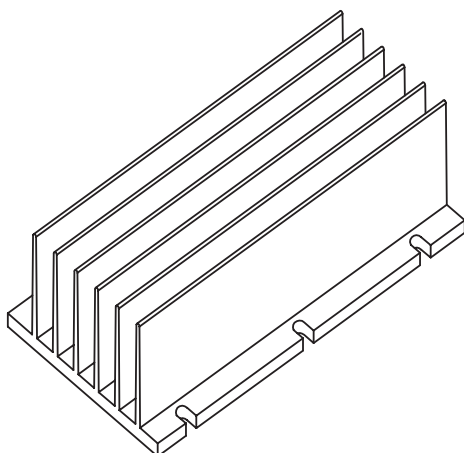

- Standard mounting hole pattern mates with Vicor DC/DC converters.
- Aluminum extruded fin construction keeps DC/DC converter modules cool in both forced and natural convection applications.
- Three fin heights, two flow direction options.
- Black anodize finish standard.
- Integral thermal interface pad option eliminates need to order and install pad separately.
- Ordering a single part number with the hardware kit option provides everything necessary to keep your converter cool.

557 SERIES DIMENSIONS

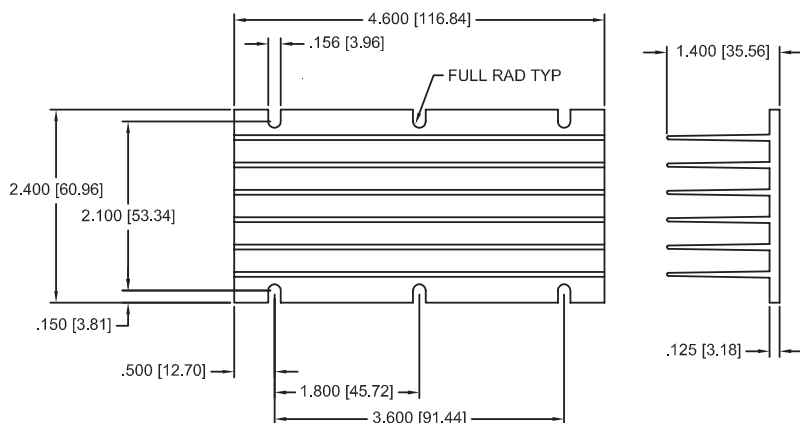

PRODUCT DESIGNATION

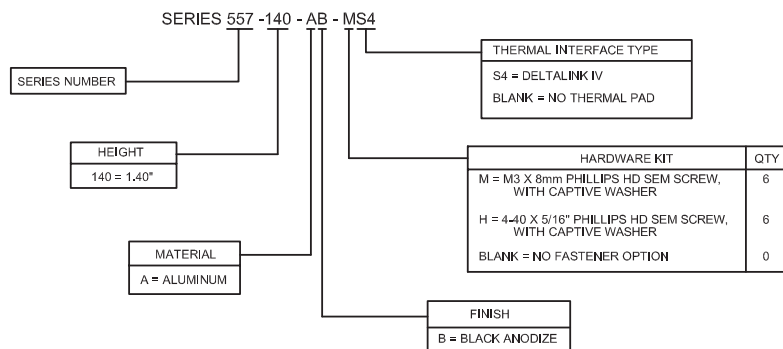

All trademarks and tradenames used in this publication are for identification purposes only and may be trademarks of their respective companies.
All specifications subject to change without notification.

Extruded Heat Sinks for DC/DC Converters (con't.)

Series 557, 558 and 559: Heat sinks for "Full-Brick" DC/DC Devices

FULL-BRICK (con't)

PRODUCT DESIGNATION

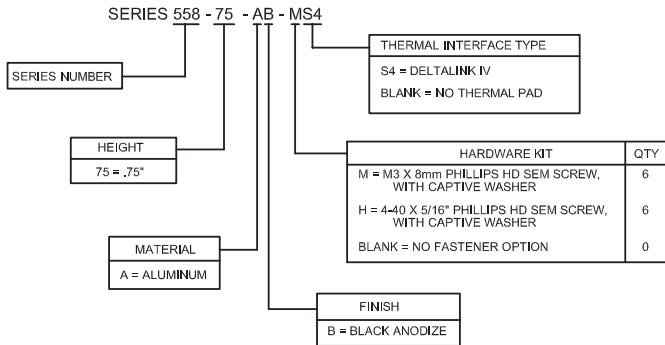

558 SERIES DIMENSIONS

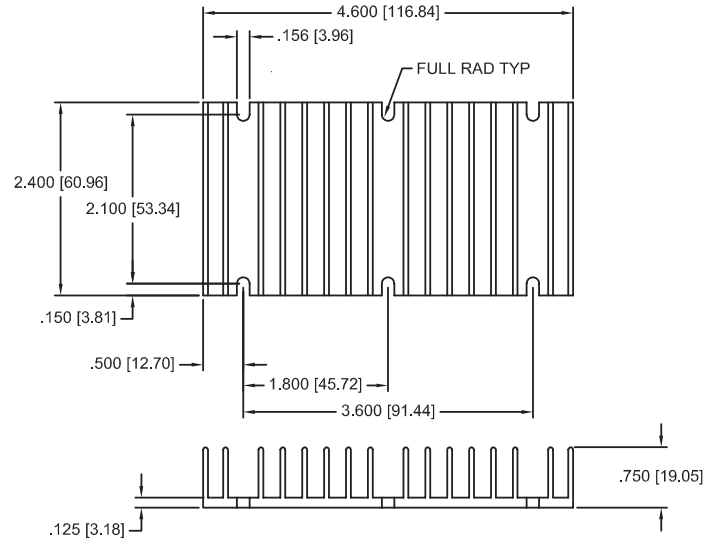

PRODUCT DESIGNATION

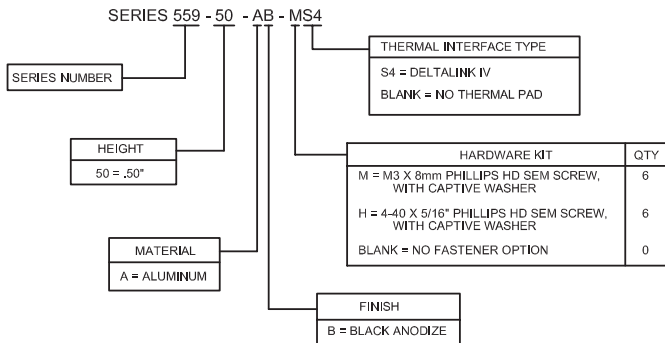

559 SERIES DIMENSIONS

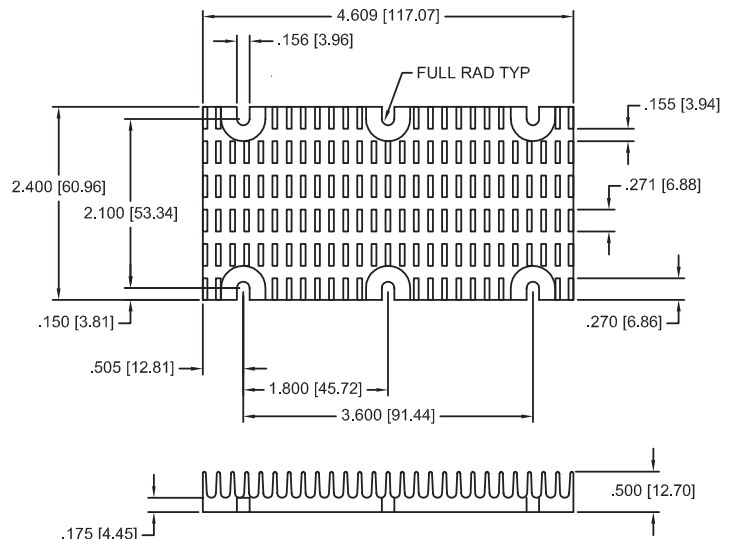

SERIES 557, 558 AND 559

Heat Sinks for "Full Brick" DC/DC Converters

Standard P/N	Footprint Dimensions in. (mm)	Height in. (mm)	Fin Orientation	Number of fins	Forced Convection Thermal Resistance at 300 ft/min (C/W)	Natural Convection Power Dissipation (W) 40°C Rise Heat Sink to Ambient
557-140AB	4.60 (116.8) x 2.40 (61.0)	1.40 (35.6)	Horizontal	6	1.3	14
558-75AB	2.40 (61.0) x 4.60 (116.8)	.75 (19.1)	Vertical	16	1.8	12
559-50AB	2.40 (61.0) x 4.60 (116.8)	.50 (12.7)	Vertical	27	2.2	10

Material: Aluminum, Black Anodize

All trademarks and tradenames used in this publication are for identification purposes only and may be trademarks of their respective companies.
All specifications subject to change without notification.

Extruded Heat Sinks for DC/DC Converters

Series 517, 527, 518 and 528: Heat sinks for "Half-Brick" DC/DC Devices

HALF-BRICK

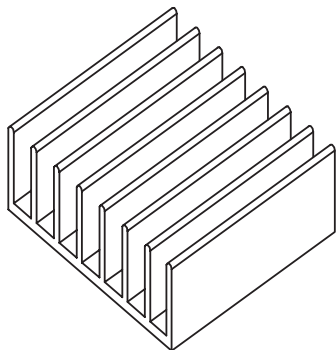

- Standard mounting hole patterns mate with the majority of "half-brick" DC/DC converters on the market.
- Aluminum extruded fin construction keeps DC/DC converter modules cool in both forced and natural convection applications.
- Vertical and horizontal fin configurations available in a variety of fin heights.
- Black anodize finish standard.
- Integral thermal interface pad option eliminates need to order and install pad separately.
- Ordering a single part number with the hardware kit option provides everything necessary to keep your converter cool.

517/527 SERIES DIMENSIONS

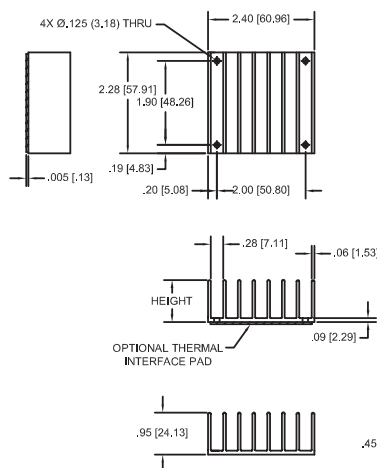

518/528 SERIES DIMENSIONS

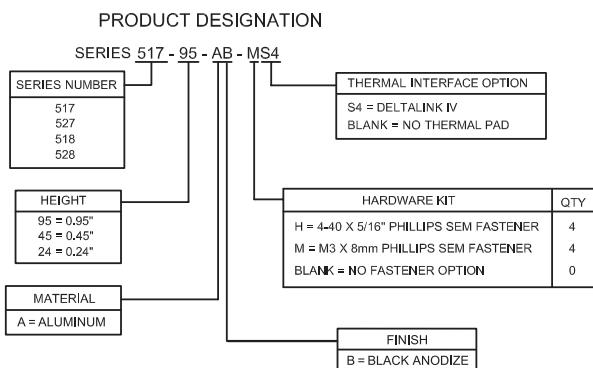
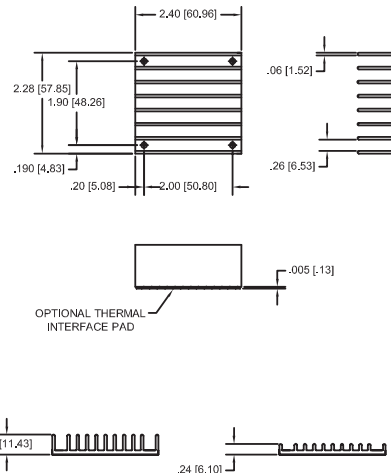

SERIES 517, 527, 518 AND 528 Heat Sinks for "Half Brick" DC/DC Converters

Standard P/N	Footprint Dimensions in. (mm)	Height in. (mm)	Fin Orientation	Number of fins	THERMAL PERFORMANCE	
					Natural Convection Power Dissipation (Watts) 60°C Rise Heat Sink to Ambient	Forced Convection Thermal Resistance at 300 ft/min (C/W)
517-95AB	2.28 (57.9) x 2.40 (61.0)	0.95 (24.1)	Horizontal	8	11W	2.1
527-45AB	2.28 (57.9) x 2.40 (61.0)	0.45 (11.4)	Horizontal	11	7W	2.3
527-24AB	2.28 (57.9) x 2.40 (61.0)	0.24 (6.1)	Horizontal	11	5W	4.2
518-95AB	2.40 (61.0) x 2.28 (57.9)	0.95 (24.1)	Vertical	8	11W	2.2
528-45AB	2.40 (61.0) x 2.28 (57.9)	0.45 (11.4)	Vertical	11	7W	2.1
528-24AB	2.40 (61.0) x 2.28 (57.9)	0.24 (6.1)	Vertical	11	5W	3.5

Material: Aluminum, Black Anodize

All trademarks and tradenames used in this publication are for identification purposes only and may be trademarks of their respective companies. All specifications subject to change without notification.

Thermal Resistance ($^{\circ}\text{C}/\text{W}$)

0.45

0.40

0.35

0.30

0.25

0.20

0.15

0.10

0.05

0.00



WAKEFIELD
Thermal Solutions

"Thermal Management Solutions and Aluminum Extrusions since 1957"



33 Bridge Street • Pelham, New Hampshire 03076
t: 603-635-2800 • f: 603-635-1900
w: www.wakefield.com

ISO 9001:2000
and
QS 9000 REGISTERED

Part # - DC Shapes 2004