

# Amphenol® RF

Global RF Solutions

## FEATURES & BENEFITS

**Broadband performance with low reflection DC to 6 GHz**

**Quick connect/disconnect snap-on mating reduces installation time**

**Conforms to European CECC 22000 specifications**

**Available in straight and right angle plugs and printed circuit board connectors**

## APPLICATIONS

Antennas  
Cable Assemblies  
Instrumentation  
Satcom  
Base Stations  
Components  
PCMCIA Cards  
Telecom  
Broadband Communications  
GPS  
Radio Boards



# MMCX Connectors

# MMCX Connectors

MMCX (also called MicroMate™), is a micro-miniature connector series with a lock-snap mechanism allowing for 360 degrees rotation enabling flexibility in PCB layouts. MMCX connectors conform to the European CECC 22000 specification.

The micromate family of products is a 6 GHz 50  $\Omega$  interconnect system and is Amphenol's smallest RF connector line. A range of connectors are available including surface mount, edge card, and cable connectors.

## Specification

### Electrical

Impedance	50 $\Omega$
Frequency Range	0-6 GHz
VSWR	1.3 max. DC to 3 GHz 1.4 max. 3-6 GHz
Insulation resistance	500 M $\Omega$ min

### Mechanical

Mating	Female contact holding force 0.15 N min Measured with a $\varnothing$ 0.475 pin gauge
--------	---

### Environmental

Temperature Range	- 40°C to +90°C
-------------------	-----------------

JACK

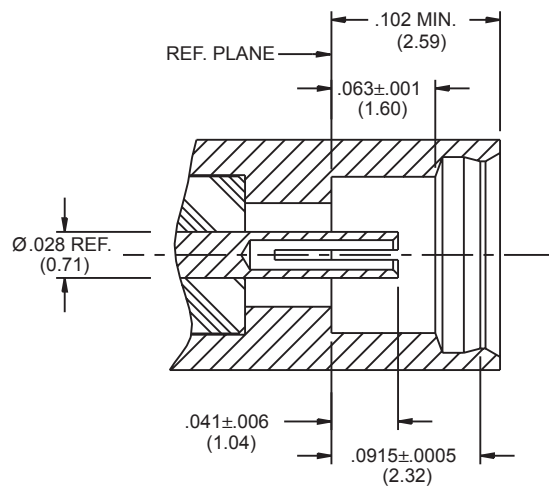

PLUG

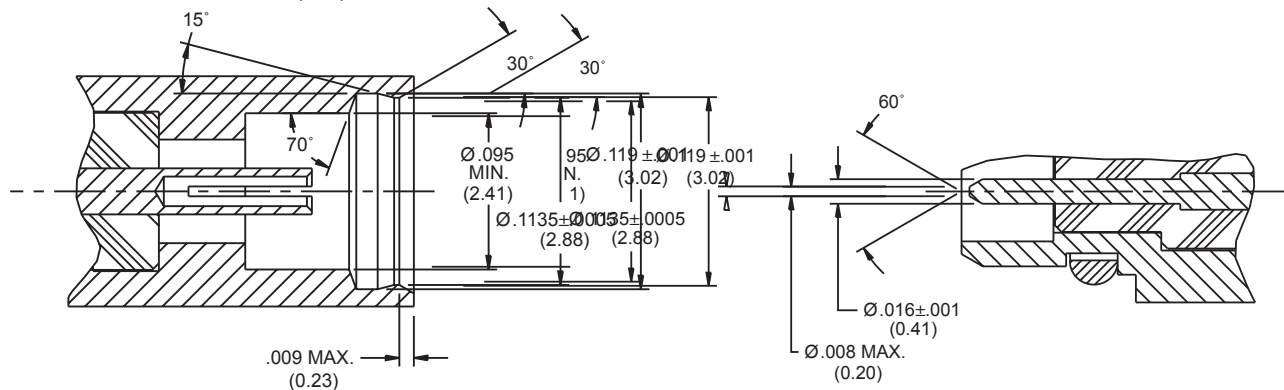
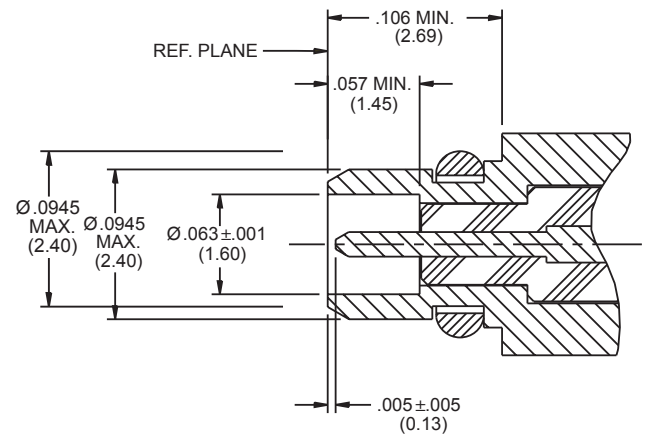

Rev. C