



PRECI-DIP is since a long time well established in the telecommunication market. We have developed numerous products for all kind of telecom applications. In this fast moving market, requirements are constantly changing. One of the trends in this market is the miniaturization of the components.

The requests for small interconnect components are increasing and this has led PRECI-DIP to develop innovative solutions and rethink the conception of our connectors. We are pleased to present three miniature products developed to achieve great performances while requiring a minimum space.

The first one is a 3-way battery connector for a cell phone. The low profile contacts with a height of 2.7 mm and 2.55 mm (center pin) have a stroke of 0.6 mm and show a very low and constant electrical resistance. The connector can stand more than 40,000 cycles and represents an optimal choice for battery connection in confined space.

The second product is an ultra-miniature spring-loaded contact developed for a Mil/Aero application. The big challenge here was to make a spring-loaded contact with a narrow barrel diameter. Whereas the common SLCs have an outer diameter of 1.8 mm, this new ultra-miniature SLC is only 0.97 mm in diameter. Mechanical and electrical performances are ensured and are comparable to SLCs of a larger size. This new contact can easily be assembled into a connector.

The third product is one of our latest developments. The trend to use board-to-board connectors with double-effect contacts is constantly increasing. Moreover, our customers are also looking for fine pitch high density connectors. With this in mind, we have developed this connector from a new generation. The ultra-thin contacts are the perfect choice for dense arrangements. This product can be used in various applications and can be customized to meet your specifications.

1. 3-WAY ULTRA-LOW SPRING-LOADED CONNECTOR

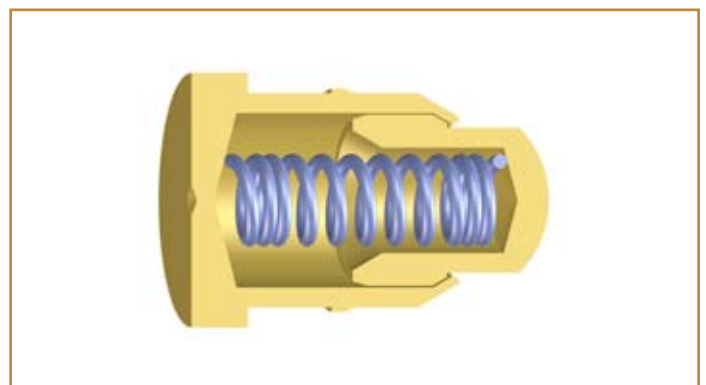
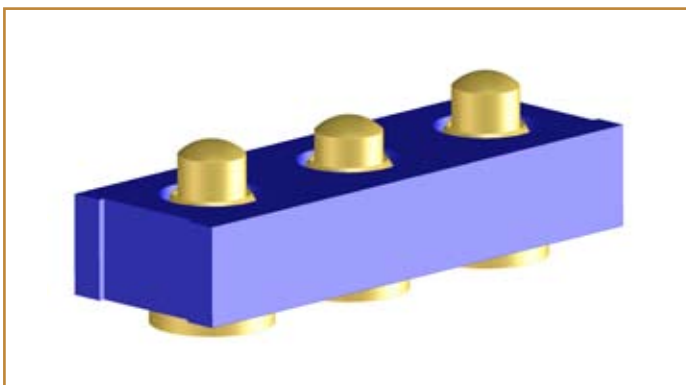

1.1 APPLICATIONS

connector for cell phone battery connection

1.2 FEATURES

3 pins
center pin: 2.55 mm height
contacts at both ends: 2.7 mm height

2. ULTRA-MINIATURE SPRING-LOADED CONTACT

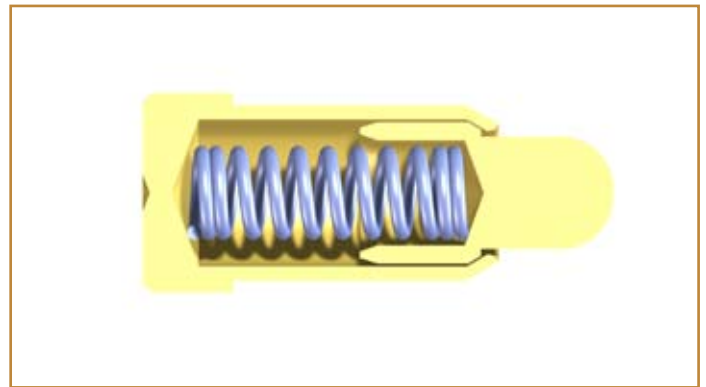

2.1 APPLICATIONS

Ultra-miniature SLC for various telecom applications

2.2 FEATURES

Total height: 2.6 mm
Base diameter: 1.1 mm
Body diameter: 0.97 mm
Piston diameter: 0.62 mm
Stroke: 0.6 mm

3. ADVANCED DESIGN, BOARD-TO-BOARD SPACER WITH DOUBLE EFFECT HIGH RELIABILITY SLCs

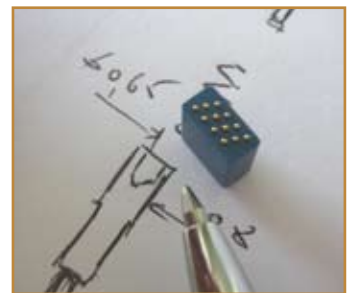
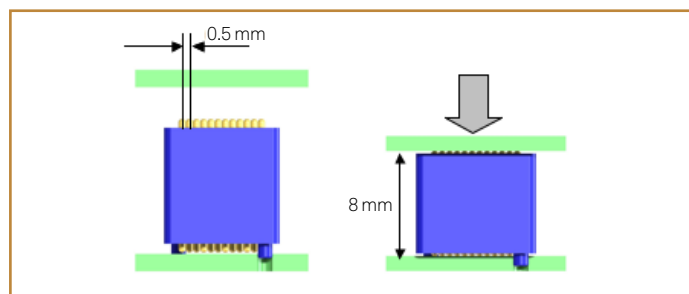

Double-effect SLCs with contact pressure on both sides

3.1 APPLICATIONS

Board-to-board connection in a high-density configuration

3.2 FEATURES

Contacts: patented clip-in-line design
Board spacing: 8 mm
Pitch spacing: 0.5 x 1 mm
High density: 12 contacts on a 4 x 8 mm area
Conceptual design (machined insulator): can be customized in shape and pin count