



EVERLIGHT ELECTRONICS CO.,LTD.

Device Number : DLE-033-252 REV: 1.2

5.0mm Round Type LED Lamps

PART NO. : 333HD/E

ECN : _____ Page: 1/4

■ Features :

- Popular T-1 3/4 diameter package.
- Choice of various viewing angles.
- Available on tape and reel.
- Reliable and robust.

■ Descriptions :

- The series is specially designed for applications requiring higher brightness
- The LED lamps are available with different colors, intensities, epoxy colors, etc.

■ Applications :

- TV set
- Monitor
- Telephone
- Computer

■ Package Dimensions:

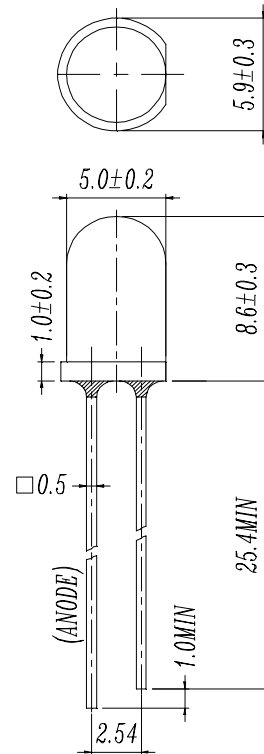

■ Notes :

- 1.All dimensions are in millimeters.
- 2.An epoxy meniscus may extend about 1.5mm(0.059") down to the lead.
- 3.Tolerances unless dimension ± 0.25 mm.

| PART NO. | Chip | | Lens Color |
|----------|----------|---------------|--------------|
| | Material | Emitted Color | |
| 333HD/E | GaP | Bright Red | Red Diffused |

OFFICE : NO. 25,Lane 76,Sec.3, Chung Yang Rd., Tucheng 236, Taipei, Taiwan, R.O.C.

TEL. : 886-2-2267-2000,2267-9936

FAX : 886-2-2267-6244,22676189,22676306

<http://www.everlight.com>



EVERLIGHT ELECTRONICS CO.,LTD.

Device Number : DLE-033-252 REV: 1.2

5.0mm Round Type LED Lamps

PART NO. : 333HD/E

ECN : Page: 2/4

■ Absolute Maximum Ratings at Ta = 25°C

| Parameter | Symbol | Rating | Unit |
|--|----------|-------------|------|
| Forward Current | IF | 15 | mA |
| Operating Temperature | Topr | -40 to +85 | °C |
| Storage Temperature | Tstg | -40 to +100 | °C |
| Soldering Temperature | Tsol | 260 ± 5 | °C |
| Power Dissipation | Pd | 45 | mW |
| Peak Forward Current(Duty 1/10 @ 1KHz) | IF(Peak) | 50 | mA |
| Reverse Voltage | VR | 5 | V |

■ Electronic Optical Characteristics :

| Parameter | Symbol | Min. | Typ. | Max. | Unit | Condition |
|------------------------------|--------|------|------|------|------|-----------|
| Luminous Intensity | Iv | 1.0 | 2.0 | / | mcd | IF= 10 mA |
| Viewing Angle | 2θ 1/2 | / | 45 | / | deg | IF= 10 mA |
| Peak Wavelength | λ p | / | 697 | / | nm | IF= 10 mA |
| Dominant Wavelength | λ d | / | 650 | / | nm | IF= 10 mA |
| Spectrum Radiation Bandwidth | Δ λ | / | 90 | / | nm | IF= 10 mA |
| Forward Voltage | VF | 1.5 | 2.0 | 2.4 | V | IF= 10 mA |
| Reverse Current | IR | / | / | 10 | μ A | VR= 5 V |



EVERLIGHT ELECTRONICS CO.,LTD.

Device Number : DLE-033-252 REV: 1.2

5.0mm Round Type LED Lamps

PART NO. : 333HD/E

ECN : _____ Page: 3/4

■ Typical Electro-Optical Characteristic Curves:

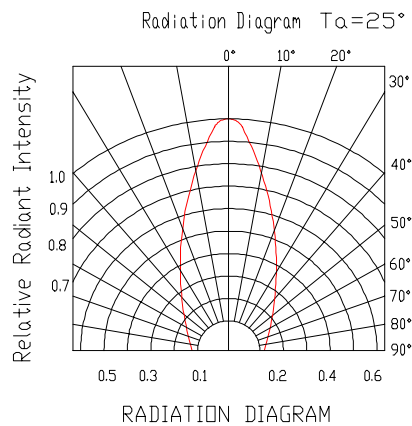
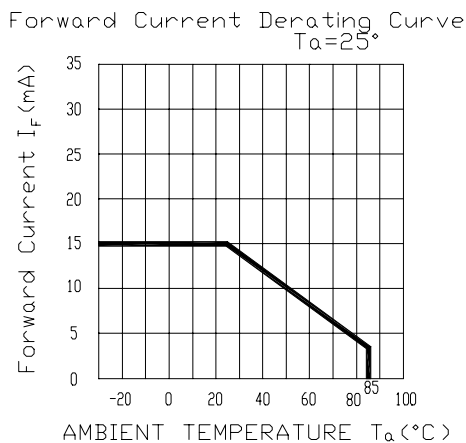
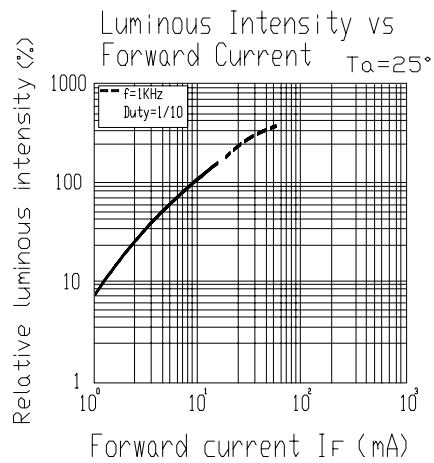
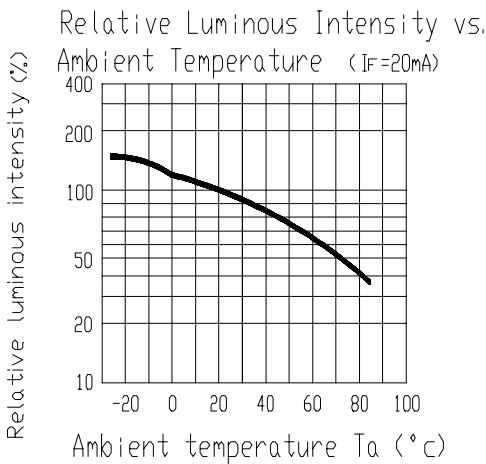
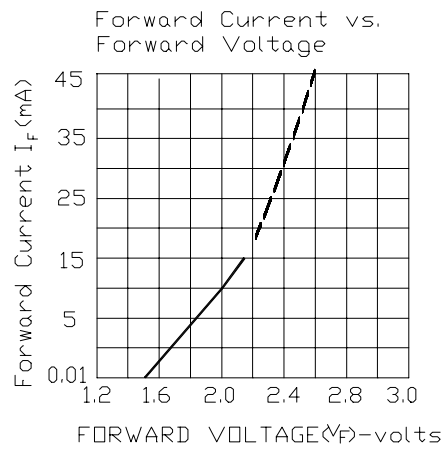
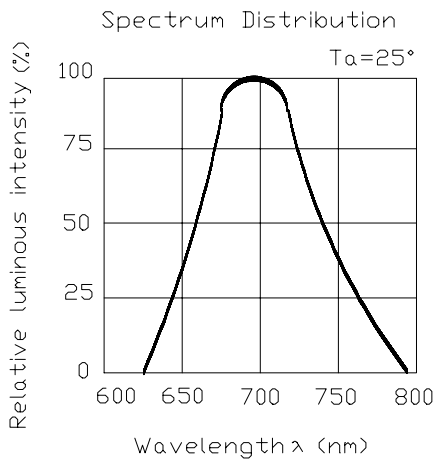



EVERLIGHT ELECTRONICS CO.,LTD.

Device Number : DLE-033-252 REV: 1.2

5.0mm Round Type LED Lamps

PART NO. : 333HD-E ECN : _____ Page: 4/4

■ Reliability test items and conditions:

| No | Item | Test Conditions | Test Hours/Cycle | Sample Size | Ac/Re |
|----|----------------------------------|---|------------------|-------------|-------|
| 1 | Solder Heat | TEMP : 260°C ± 5 °C | 5 SEC | 76 PCS | 0/1 |
| 2 | Temperature Cycle | H : +85°C 30min § 5 min L : -55°C 30min | 50 CYCLES | 76 PCS | 0/1 |
| 3 | Thermal Shock | H : +100°C 5min § 10 sec L : -10°C 5min | 50 CYCLES | 76 PCS | 0/1 |
| 4 | High Temperature Storage | TEMP : 100°C | 1000 HRS | 76 PCS | 0/1 |
| 5 | Low Temperature Storage | TEMP : -55°C | 1000 HRS | 76 PCS | 0/1 |
| 6 | DC Operating Life | TEMP : 25°C If=20mA | 1000 HRS | 76 PCS | 0/1 |
| 7 | High Temperature / High Humidity | 85°C /85% RH | 1000 HRS | 76 PCS | 0/1 |