

1. Rated load: 20V 4A ;
2. Contact Resistance: ≤0.03Ω;
3. Insulation Resistance: ≥100MΩ (500VDC);
4. Voltage withstand: AC500V(50Hz)/min;
5. Insertion force: 3~30N;
6. life: 5,000次。

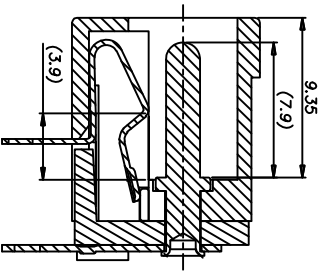

SECTION A-A

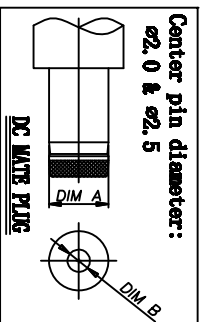

Model No.	Center pin	Center pin
PIN	φ2.0	φ2.5
DIM A	φ5.5±0.05	φ5.5±0.05
DIM B	φ2.05±0.18	φ2.55±0.18

SCHMATIC	Symbol
Model	DC-005B-5A
Center Pin	2.0 2.5

	MATERIAL	PLATING
center pin	Brass	CuSn
terminal 1	Brass	Tin
terminal 2	Phosphor copper	Tin
terminal 3	Brass	Tin
	plastic	PBT

ΔX	ΔX	ΔX	MARK	DESCRIPTION	DATE	REVISED	APPROVED	UNSPECIFIED TOLERANCES	DSND	DATE	SCALE: N/A	MODEL TYPE:
									DWN	DATE	VIEW:	DC POWER JACK
									CHKD	DATE	UNIT: mm	PART NO.:
									APPD	DATE	SIZE: A4	DWG NO.:
									XKB INDUSTRIAL PRECISION CO., LIMITED			
									WEIGHT	SHEET	REVISION	
									1.0g	1/1	A0	