

SEC A-A

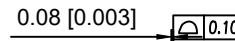
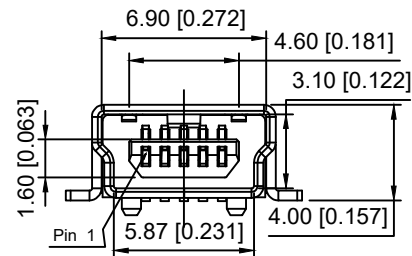
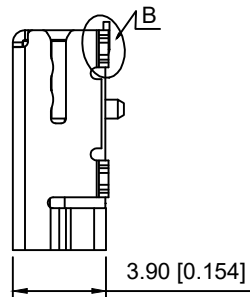
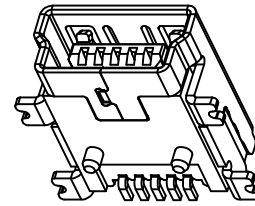
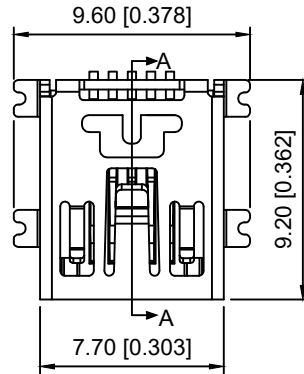

SURFACE OF SHELL PAD

DETAIL B  
SCALE 2/1

Material  
 Housing Material: LCP, UL94V-0, black  
 Contact Terminal: Phosphor bronze, T=0.25mm  
 Metallic Shell: Brass, T=0.4mm  
 Plating  
 Contact Terminal  
 Underplating: Nickel all over  
 Contact Plating: 1 $\mu$  gold  
 Solder Tail: Bright Tin  
 Metallic Shell  
 Underplating: Nickel 50 $\mu$  all over  
 Metallic Shell: Matte Tin 50 $\mu$  all over  
 Electrical  
 Voltage Rating: 30VDC  
 Current Rating: 1A  
 Contact Resistance: 50m $\Omega$  Max  
 Insulation resistance: 100M $\Omega$  Min (Apply 100 VDC)  
 Dielectric withstanding voltage: No discharge or flash (100V AC is applied for 1 minute)  
 Mechanical  
 Durability: 5,000 cycles  
 Mating Force: 35N (3.57KgF) Max  
 Unmating Force: Initial - 7N (0.71KgF) Min., 5001st cycle - 3N (0.31KgF) Min.  
 Environmental and Processing  
 Operating Temperature: -50°C to +85°C

U213-05XN-4BH82

1:Au 1U"  
 6:Au 30U"

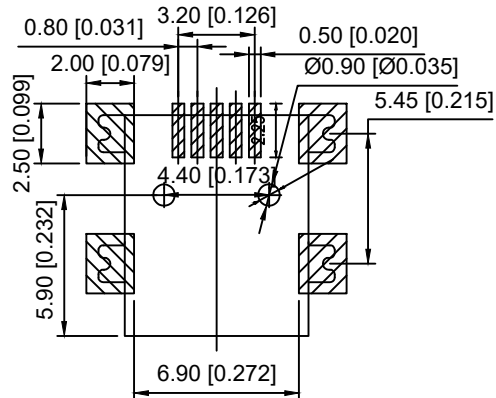

RECOMMENDED PCB LAYOUT

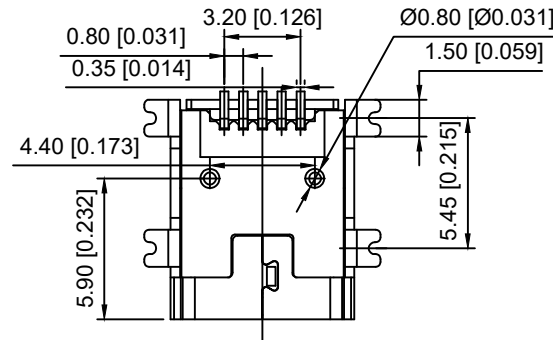

DSND		DATE		SCALE: N/A	MODEL TYPE: MINI USB
DWN		DATE		VIEW:	PART NO.:
CHKD		DATE		UNIT: mm/in	DWG NO.:
APPD		DATE		SIZE: A4	U213-05XN-4BH82
				XKB INDUSTRIAL PRECISION CO., LIMITED	WEIGHT 1.0g
					SHEET 1/1
					REVISION A0

					ANGLAR	±5°
Δx					L ≤ 4	±0.2
Δx					4 < L ≤ 16	±0.3
Δx					16 < L ≤ 63	±0.4
MARK	DESCRIPTION	DATE	REVISED	APPROVED	L > 63	±0.5
REVISIONS					UNSPECIFIED TOLERANCES	
www.xk-dg.cn www.helloxkb.com www.helloxkb.cn						