

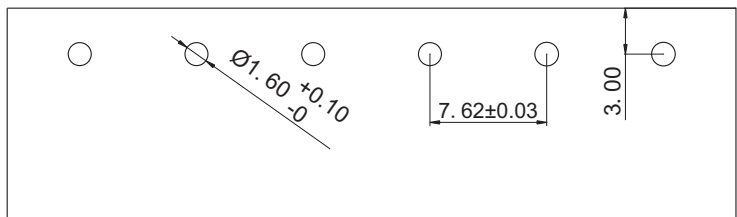

慈溪市科发电子有限公司

CIXI KEFA ELECTRONICS CO., LTD.

产品规格书



PCB Layout

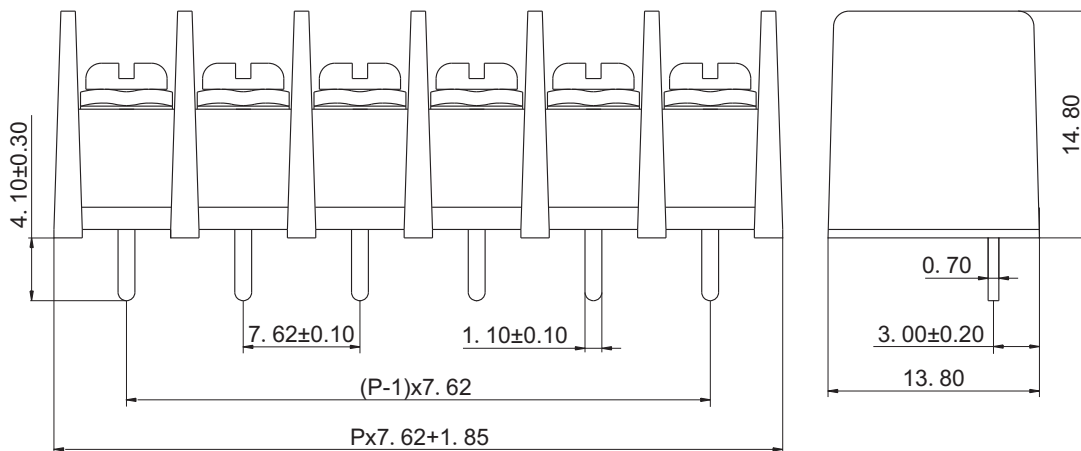

linear dimension(Tolerances Standard GB/T 14486-2008)								—		
variable range	to 6	over 6 to 10	over 10 to 30	over 30 to 60	over 60 to 100	over 100 to 160	over 160 to	to 10	over 10 to 100	over 100 to
tolerance	±0.20	±0.30	±0.50	±0.70	±1.00	±1.30	±1.60	0.10	0.30	0.60

认证			
电气性能	UL	IEC	
参考标准	300V	250V	
额定电压	20A	24A	
额定电流	22-12 AWG	2.5mm ²	
使用线径	AC2000V/1Min		
耐电压			

机械性能	
扭力距	8.0Kg.cm
温度范围	-40℃—+105℃

尺寸	
间距	7.62mm
极数	2P-24P

材质及电镀	
塑体	PA66 UL94V-0
焊针	黄铜 镀锡
螺丝	M3 钢 镀镍

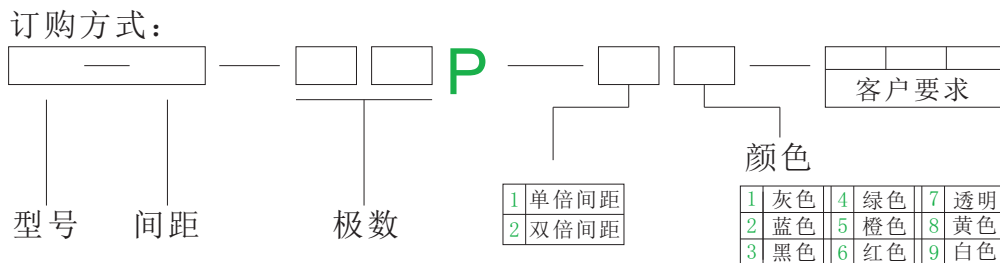

慈溪市科发电子有限公司
CIXI KEFA ELECTRONICS CO., LTD.

NAME KF25S-7.62