

RECOMMENDED P.C.B. LAYOUT (T:1.00mm)
TOLERANCE UNSPECIFIED ±0.05mm

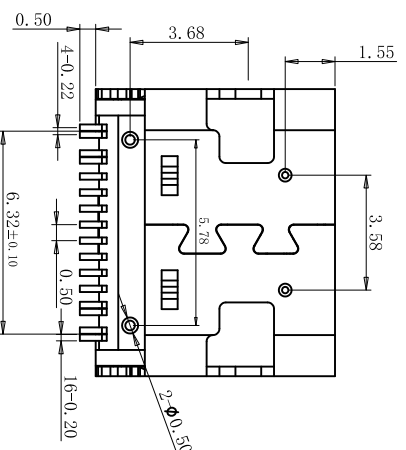

- SPECIFICATIONS:
- ELECTRICAL CHARACTERISTICS:
 - CONTACT RESISTANCE: 30m MAX. Ω
 - DIELECTRIC WITHSTANDING VOLTAGE: 100V AC FOR ONE MINUTE.
 - INSULATION RESISTANCE: 100M MIN. Ω (MEASURED BY 500 VDC)
 - MECHANICAL CHARACTERISTICS:
 - INSERTION FORCE : 0.5-2.0N(REF.)
 - WITHDRAWAL FORCE : 0.8-2.0N(REF.)
 - LIFE TEST: 10,000 CYCLES.
 - TO CONFORM TO THE KROON HAZARDOUS SUBSTANCE FREE SPEC.

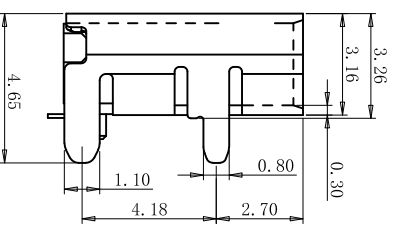
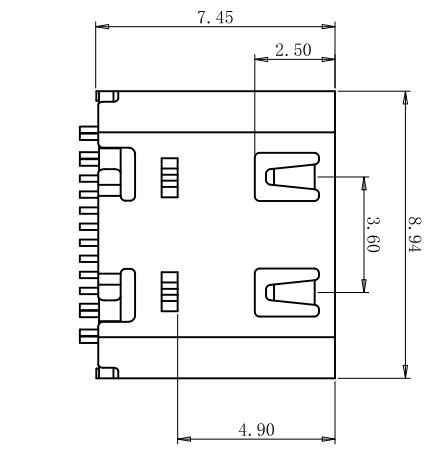
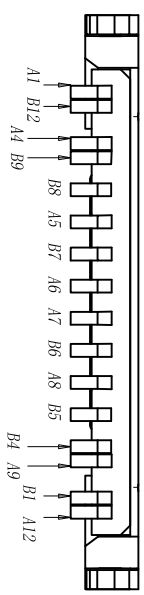
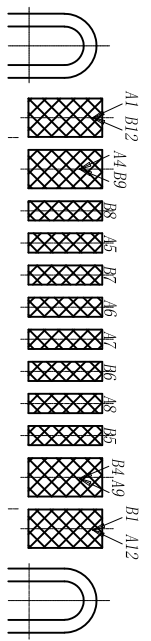
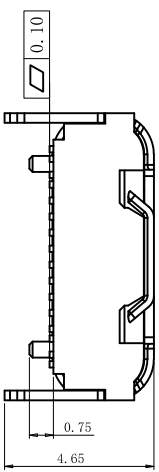

NO.	DESCRIPTION	MATERIAL	REMARKS	QTY
6	SHELL	STAINLESS STEEL.	NI Plated	1PCS
5	SHIELDING PLATE	STAINLESS STEEL.	---	1PCS
4	MD	HIGH TEMPERATURE PLASTIC	BLACK	1PCS
3	CONTACT	COPPER ALLOY	Au/NI Plated	1SET
2	CONTACT	COPPER ALLOY	Au/NI Plated	1SET
1	HOUSING	HIGH TEMPERATURE PLASTIC	BLACK	1PCS



G-Switch Electronic (Hongkong) CO., Ltd.

DESIGN	Bright Lee	DATE	2016.05.29	Mold code:	
CHECKED		DATE		GT-USB-7010C	
APPROVED		DATE			
http://www.dg-switch.com		REV.:	X1	SCALE:	4:1
TEL:0769-82388879		SIZE:	A4	SHEET:	1/1

