

4D Theater Seat

SANYO DENKI

Description

4D theater seats are part of a new entertainment presentation system that goes beyond 3D, giving viewers an immersive, sensory experience. These seats are sensor-equipped and programmed to match the exact movement on the screen. Special effects like gusts of air, bursts of mist, scents, lights, smoke, movement, and vibration make viewers feel like they are a part of the movie. A thrilling, theme park-like experience can now be realized at a movie theatre.

A fan is installed near the rear of the armrest to send air through a duct. For this reason, a high static pressure fan that can overcome pressure loss in the duct is required.



San Ace 97
9BMB type



SANYO DENKI Proposal

■ **9BMB24S201 / 97 x 33 mm / 24 V / Pulse sensor / 40,000 hours @ 60°C / 1 unit**

Purpose: Timed to match scenes with wind, the blower fan installed in the armrest blows air toward the seat through the duct.

Features

■ High static pressure

Blowers send out straight airflow with high static pressure. They are characterized by having higher static pressure than that of axial fans of similar size.

Blower

With its high static pressure, the Blower is ideal for localized cooling and suction applications.

Axial fan

Axial fans spread airflow wider making them ideal for cooling the entire enclosure of a device.



■ Blower shape and airflow

Blowers have a central inlet for drawing in air and an outlet for expelling it at a right angle.

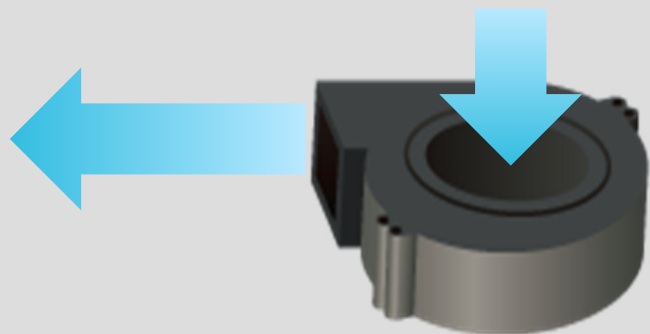

Merits

■ Contributes to the customer's design

4D theater seats are designed to perform multiple functions, limiting the installation location of the fans. In this application, high static pressure is required because air is sent to the opening via the duct inside the armrest. With a high performance blower, air can travel the necessary distance.

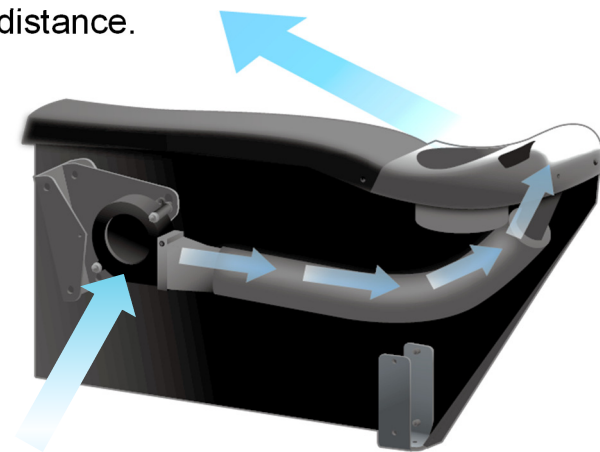

■ Improved space efficiency

Installation space is limited because the fans are installed in the armrests. The structure of the blower fan changes the wind angle by 90 degrees, making it possible to install the fan within the armrest.

Blower

Width: 33 mm
Type: 9BMB24S201

Axial fan with similar cooling performance

Width: 60 mm
Type: 9GA0624P1K03

