

MAPX	MODIFICATION	DATE
------	--------------	------

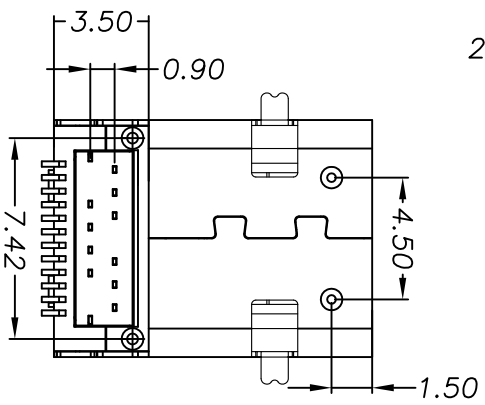

A1	GND	B12	GND
A2	SSTXP1	B11	SSRXP1
A3	SSTXN1	B10	SSRXN1
A4	VBUS	B9	VBUS
A5	CC1	B8	SBU2
A6	DP1	B7	DN2
A7	DN1	B6	DP2
A8	SBU1	B5	CC2
A9	VBUS	B4	VBUS
A10	SSRXN2	B3	SSTXN2
A11	SSRXP2	B2	SSTXP2
A12	GND	B1	GND
PIN	SIGNAL NAME	PIN	SIGNAL NAME

- 备注:
1. 材质:
 - 1.1 胶芯: LCP+30%G.F UL94V-0
 - 1.2 端子: 磷铜, T=0.12mm; 镍底, 镀金X_u"
 - 1.3 外壳: 不锈钢, T=0.30mm; 表面镀镍100μ" 或亮锡100μ"
 - 1.4 接地片: 不锈钢, T=0.10mm;
 - 1.5 卡片: 不锈钢, T=0.15mm;
 2. 主要特性:
 - 2.1 额定电流: 0.5A
 - 2.2 接触阻抗: 30mΩ MAX
 - 2.3 绝缘阻抗: 100MΩ MIN 250V DC
 - 2.4 耐压测试: 250V AC
 - 2.5 沾锡性: 温度250±5℃, 时间5±0.5s
 - 2.6 整体插入力: 3.57kgf MAX
整体拔出力: 1.02kgf MIN
 - 2.7 使用寿命: 10000次
 - 2.8 工作温度: -30℃~+80℃

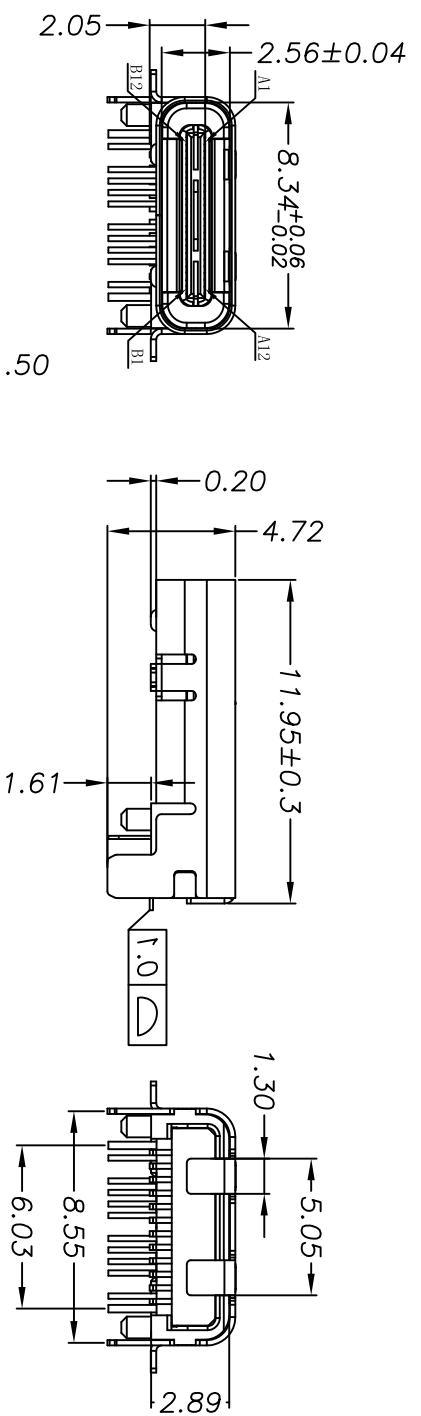
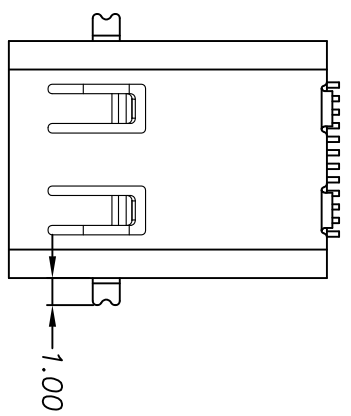
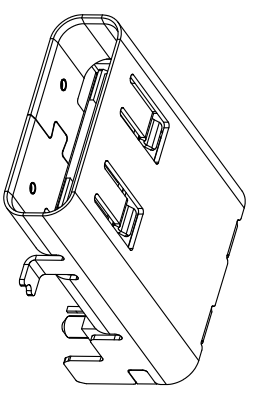
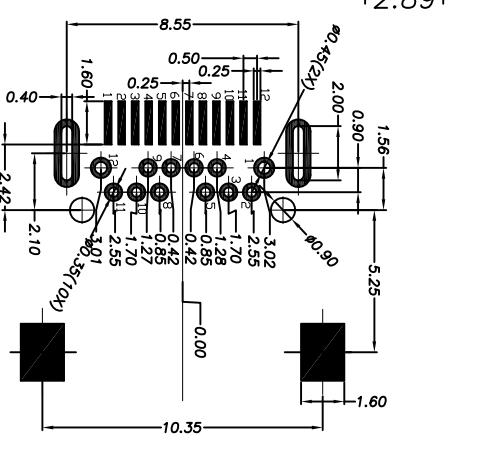

RECOMMENDED PCB LAYOUT(TOP VIEW)

产品图

公差一览表

TOLERANCE UNLESS OTHERWISE SPECIFIED	公差一览表
X ±0.15	X ±5°
X ±0.10	X ±2°
XX ±0.05	XX ±1°
XXX ±0.03	XXX ±0.5°

PRODUCT CHART DWG		制图		制图料号	
UNIT	MM	DRAWING	Gavin	PRODUCT PART NO.	
SCALE	1:1	CHECKED	郭治富	PRODUCT NO.	
DATE	2016-09-09	APPROVED	黄国荣	USB Type-C/F 母座11.95前插后贴	
DATE		VIEW		版本	AD

