

MAPX	MODIFICATION	DATE
------	--------------	------

NOTES:  
 1. HOUSING: SEE NOTES,  
 TERMINAL: SEE NOTES,  
 SHELL: SEE NOTES.

SPECIFICATION:  
 1. ELECTRICAL CHARACTERISTIC:  
 CONTACT RESISTANCE: 30MΩ MAX  
 DIELECTRIC WITHSTANDING VOLTAGE: 500V AC FOR 1MIN  
 INSULATION RESISTANCE: 1000MΩ MIN  
 2. MECHANICAL CHARACTERISTIC:  
 INSERTION FORCE: 35N(3.57KGF) MAX  
 EXTRACTION FORCE: 10~35N(1.02~3.57KGF) MIN  
 DURABILITY: 1500 CYCLES EXTRACTION FORCE:10~35N  
 3000 CYCLES MIN  
 5000 CYCLES EXTRACTION FORCE:3~35N

3. ENVIRONMENTAL:  
 OPERATING TEMPERATURE: -55°C~+85°C  
 4. Contact finish:  
 01:Selective Gold Flash  
 02:Selective Gold 3U"  
 03:Selective Gold 5U"  
 04:Selective Gold 15U"  
 05:Selective Gold 30U"

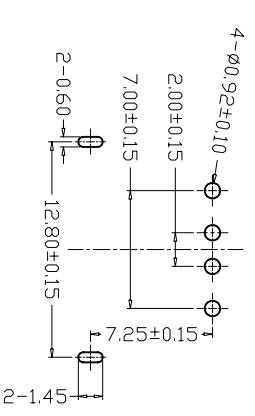

FRONT EDGE OF CONNECTOR  
PCB LAYOUT

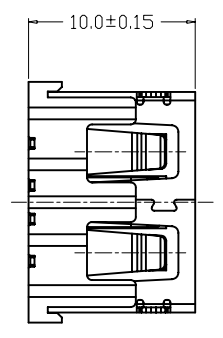
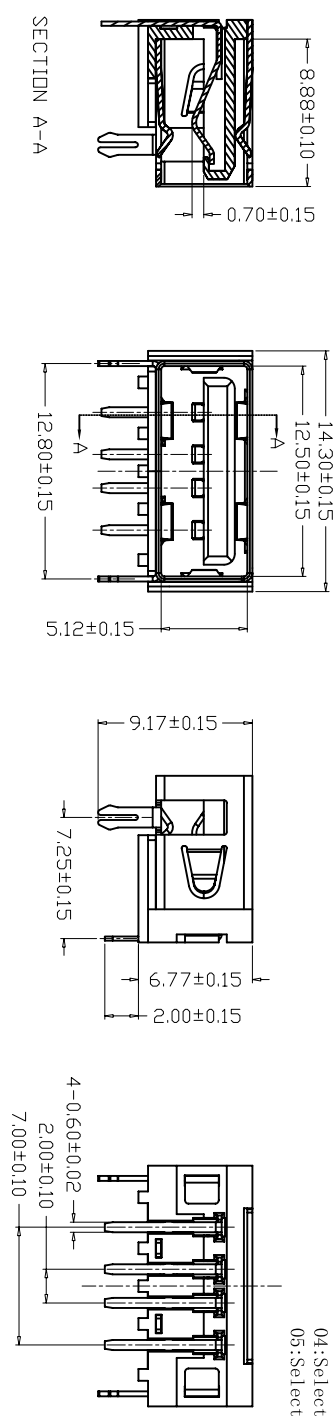

产品图		公差一览表	
PRODUCT CHART DWG		TOLERANCE UNLESS OTHERWISE	
X	±0.25	X	±5.°
X	±0.20	X	±2.°
XX	±0.15	XX	±1.°
.XXX	±0.10	.XXX	±0.5°

深圳市精拓金电子有限公司		制图料号	
DATE		PRODUCT PART NO	
2014.06.15	1:1	JTJ-USB AP 10.0-C-005	
审核	核准	产品名称	
APPD	APPD	USB A/F DIP 90° (10.0)无卷边	
		角法	
		VER	
		版本	
		AD	

