

|      |              |      |
|------|--------------|------|
| MAPX | MODIFICATION | DATE |
|------|--------------|------|

NOTES:  
 1. HOUSING: SEE NOTES, UL94V-0 .  
 TERMINAL: SEE NOTES.  
 SHELL: SEE NOTES.

SPECIFICATION:  
 1. ELECTRICAL CHARACTERISTIC:  
 CONTACT RESISTANCE: 30MΩ MAX  
 DIELECTRIC WITHSTANDING VOLTAGE: 500V AC FOR 1MIN  
 INSULATION RESISTANCE: 1000MΩ MIN  
 2. MECHANICAL CHARACTERISTIC:  
 INSERTION FORCE: 35N(3.57KGF) MAX  
 EXTRACTION FORCE: 10~35N(1.02~3.57KGF)/MIN  
 DURABILITY: 1500 CYCLES EXTRACTION FORCE: 10~35N  
 5000 CYCLES MIN

3. ENVIRONMENTAL:  
 OPERATING TEMPERATURE: -55°C+85°C  
 4. Contact finish:

- 01: Selective Gold Flash
- 02: Selective Gold 3U"
- 03: Selective Gold 5U"
- 04: Selective Gold 15U"
- 05: Selective Gold 30U"

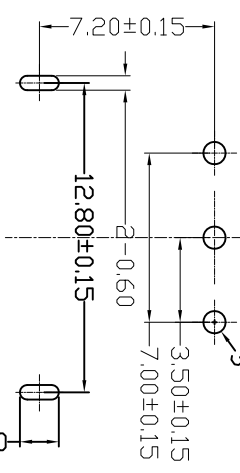

FRONT EDGE OF CONNECTOR  
 PCB LAYOUT (T=1.60mm)

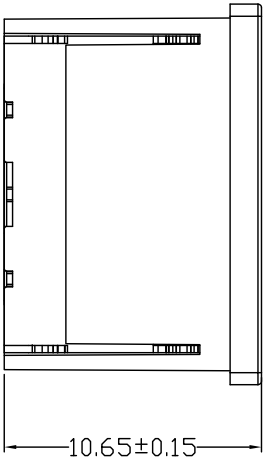
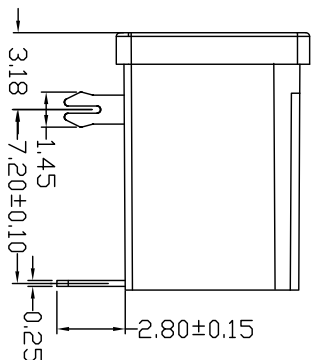
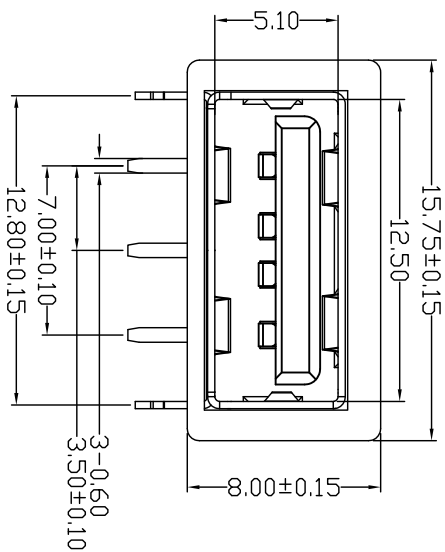
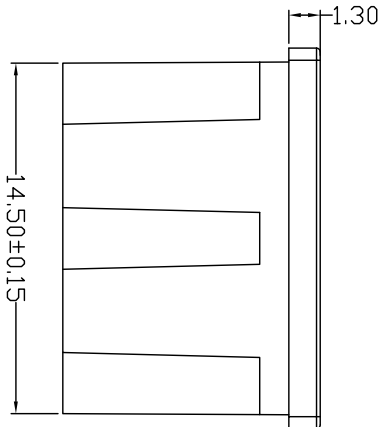

产品图  
 PRODUCT CHART DWG

深圳市精拓金电子有限公司

公差一览表

| TOLERANCE UNLESS OTHERWISE | 公差一览表     |
|----------------------------|-----------|
| X ±0.25                    | X ±5°     |
| X ±0.20                    | X ±2°     |
| XX ±0.15                   | XX ±1°    |
| XXX ±0.10                  | XXX ±0.5° |

|      |            |      |       |      |                          |
|------|------------|------|-------|------|--------------------------|
| 单位   | MM         | 制图   | Z-Y-B | 制料号  | JTJ-USB-10.6-002         |
| 比例   | 1:1        | 审核   |       | 产品名称 | USB A/F 封闭式90度 2/3短路正向成品 |
| 日期   | 2013.10.24 | 核准   |       | 角法   |                          |
| DATE |            | APPD |       | 版本   | AD                       |