

MAPX	MODIFICATION	DATE
------	--------------	------

NOTES:

1. HOUSING: SEE NOTES.  
 TERMINAL: SEE NOTES.  
 SELL: SEE NOTES.

SPECIFICATION:

- ELECTRICAL CHARACTERISTIC:  
 CONTACT RESISTANCE: 30MΩ MAX  
 DIELECTRIC WITHSTANDING VOLTAGE: 500V AC FOR 1MIN  
 INSULATION RESISTANCE: 1000MΩ MIN
- MECHANICAL CHARACTERISTIC:  
 INSERTION FORCE: 35N(3.57KGF) MAX  
 EXTRACTION FORCE: 10\*35N(1.02\*3.57KGF) MIN  
 DURABILITY: 1500 CYCLES EXTRACTION FORCE: 10\*35N  
 3000 CYCLES MIN  
 5000 CYCLES EXTRACTION FORCE: 3\*35N
- ENVIRONMENTAL:  
 OPERATING TEMPERATURE: -55°C~85°C
- Contact finish:  
 01: Selective Gold Flash  
 02: Selective Gold 30"  
 03: Selective Gold 50"  
 04: Selective Gold 150"  
 05: Selective Gold 300"

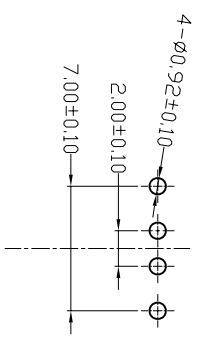
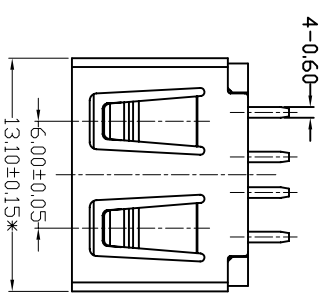

FRONT EDGE OF CONNECTOR  
PCB LAYOUT

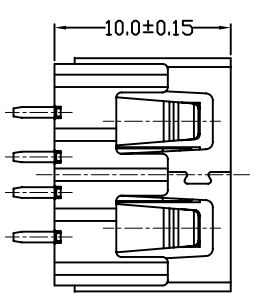
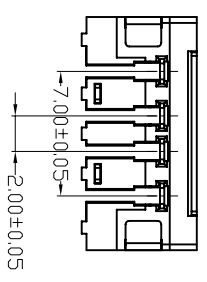
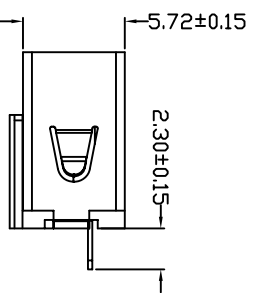
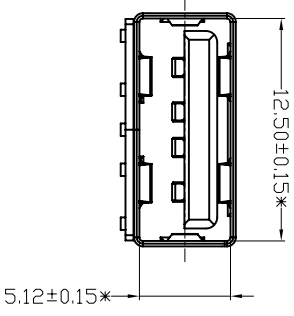
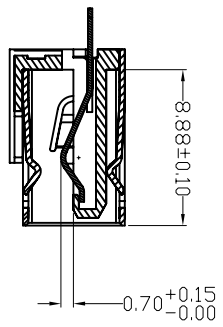

# 产品图

## 深圳市精拓金电子有限公司

公差一览表

TOLERANCE UNLESS OTHERWISE	公差
X: ±0.25	X: ±5°
X: ±0.20	X: ±2°
XX: ±0.15	XX: ±1°
XXX: ±0.10	XXX: ±0.5°

PRODUCT CHART DWG	单位	MM	制图	Z-Y-B	制图料号	JTJ-USB AF 10.0-C-009
	UNITS		DRAWING		PRODUCT PART NO	
	SCALE	1:1	审核		产品名称	USB A/F 180° (10.0)无卷边
	DATE	2012.06.15	核准		PRODUCT NO	
			APPD		角法	版本
					VIEW	VER
						AD