

Model : DB2ER-5.0/5.08

Pitch=5.0/5.08/7.62
Unit:mm
N=Poles

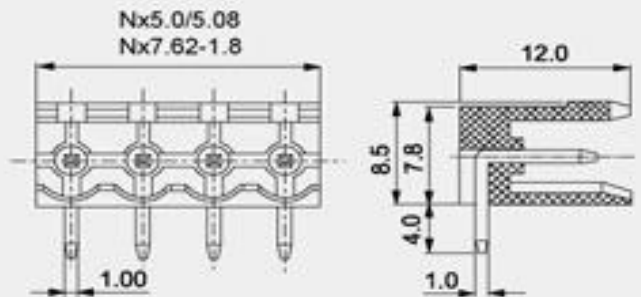

P.C.B. LAYOUT

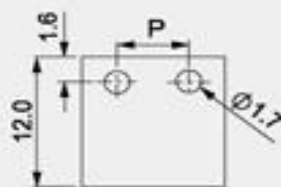

电气特性/Electrical Specification

额定参数/Rated	300V, 15A (320V, 20A)
接触电阻/Contact resistance	20mΩ Max.
绝缘电阻/Insulation resistance	5000MΩ Min.
抗电强度/Dielectric strength	2500VAC Min. for 60 seconds

机械特性/Mechanical Specification

使用温度/Temp range	-40℃ ~ +105℃
瞬时温度/MAX Soldering	+260℃, 5s

部件材质/Part & Material

塑件/Body	PA66, UL94V-0
端子/Terminal	黄铜, 镀锡/Brass, Tin plating

包装形式/Packing: 采取标准纸箱包装/Standard carton

订购方式/Ordering Information

产品型号/Part No. — — P — — R
 端子间距/Pitch 极数/Poles 颜色/Color 客户需求/Customer Request
 02~24

灰色/Grey	1	绿色/Green	4	透明/Transp.	7
蓝色/Blue	2	橙色/Orange	5	黄色/Yellow	8
黑色/Black	3	红色/Red	6	白色/White	9