

3M™ Mini D Ribbon (MDR) Connectors

.050" Plastic Shielded Junction Shell for Round Cable

103 Series



- Durable two piece plastic over two piece metal junction shell for straight round cable (compatible with 101XX-6000 EC plug)
- Quick release latching
- Contacts: 50, 68 and 80
- Regulatory Information: Visit 3M.com/regs or contact your 3M representative to find the RoHS compliance status of the 3M part you are interested in.

Date Modified: July 15, 2019

TS-0534-C
Sheet 1 of 2

Physical

Outer Shell

Material: Copolyester Elastomer
Flammability: UL 94V-0
Color: See Ordering Information

Inner Shell

Material: Steel, .02 [0.5] Thick
Plating: Nickel
Marking: 3M Logo

UL File No.: E68080

3M™ Mini D Ribbon (MDR) Connectors

.050" Plastic Shielded Junction Shell for Round Cable

103 Series

CONTACT QTY.	DIMENSIONS					
	A	B	C	D	E	F
50	1.66 [42.3]	1.96 [49.9]	1.57 [40.0]	.68 [17.4]	SEE ORDERING INFO.	.48 [12.4]
68	2.11 [53.6]	2.41 [61.3]	2.02 [51.4]	.68 [17.4]		.48 [12.4]
80	2.41 [61.2]	2.67 [67.8]	2.33 [59.1]	.79 [20.2]		.54 [13.6]

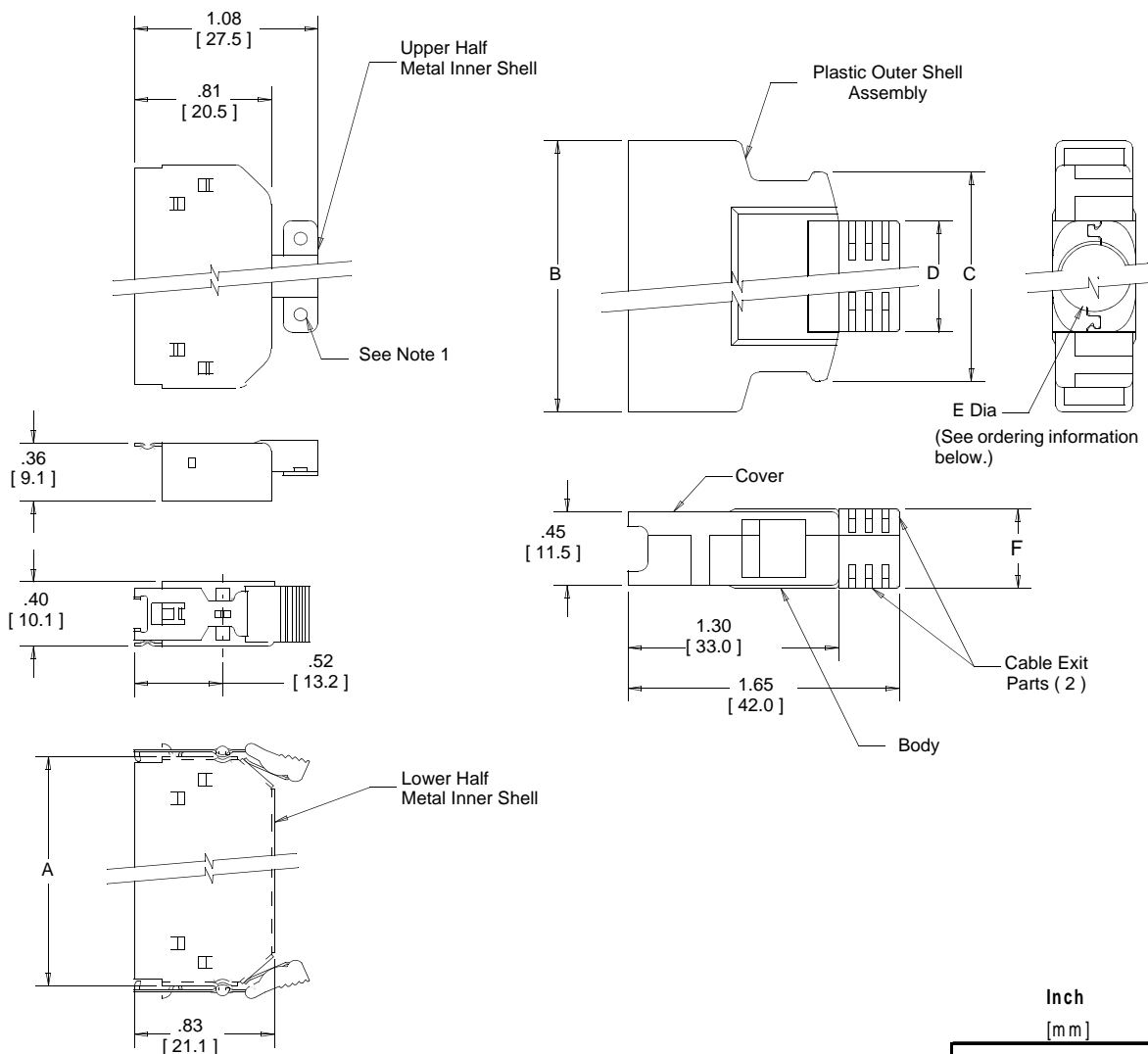

Inch [mm]			
Tolerance Unless Noted			
	.0	.00	.000
inch	±.1	±.01	±.005

Note:

1. Part number includes a cable clamp and two M2.6 screws. These parts are not shown.
2. Panel thickness (including washers) 2.0 mm max.

[] Dimensions for Reference Only

Ordering Information

103XX-3280-00X-X (RIA E1 & C1 apply)

Contact Quantity (See Table)

Cable Exit Inside Diameter of Bushing (Dim E)
 0 = 10.0 mm Ø
 1 = 11.0 mm Ø

Shell Color
 0 = Beige (Standard)
 3 = Gray (Special Order - 50 pos. only)
 6 = Black (Special Order - 80 pos. only)

TS-0534-C
 Sheet 2 of 2

Regulatory: For regulatory information about this product, visit 3M.com/regs or contact your 3M representative.

Technical Information: The technical information, recommendations and other statements contained in this document are based upon tests or experience that 3M believes are reliable, but the accuracy or completeness of such information is not guaranteed.

Product Use: Many factors beyond 3M's control and uniquely within user's control can affect the use and performance of a 3M product in a particular application. Given the variety of factors that can affect the use and performance of a 3M product, user is solely responsible for evaluating the 3M product and determining whether it is fit for a particular purpose and suitable for user's method of application.

Warranty, Limited Remedy, and Disclaimer: Unless an additional warranty is specifically stated on the applicable 3M product packaging or product literature, 3M warrants that each 3M product meets the applicable 3M product specification at the time 3M ships the product. 3M MAKES NO OTHER WARRANTIES OR CONDITIONS, EXPRESS OR IMPLIED, INCLUDING, BUT NOT LIMITED TO, ANY IMPLIED WARRANTY OR CONDITION OF MERCHANTABILITY OR FITNESS FOR A PARTICULAR PURPOSE OR ANY IMPLIED WARRANTY OR CONDITION ARISING OUT OF A COURSE OF DEALING, CUSTOM OR USAGE OR TRADE.

If the 3M product does not conform to this warranty, then the sole and exclusive remedy is, at 3M's option, replacement of the 3M product or refund of the purchase price.

Limitation of Liability: Except where prohibited by law, 3M will not be liable for any loss or damage arising from the 3M product, whether direct, indirect, special, incidental or consequential, regardless of the legal theory asserted, including warranty, contract, negligence or strict liability.

3M Business Center
Electronics Materials Solutions Division
13011 McCallen Pass Bldg. C
Austin, TX 78753-5380
1-800-225-5373
www.3M.com/interconnect



Electronics Materials Solutions Division
Interconnect Solutions
<http://www.3M.com/interconnect>

Please recycle. Printed in USA. ©
3M 2019. All rights reserved.
RIA-2217B-E

3M is a trademark of 3M Company.

Mouser Electronics

Authorized Distributor

Click to View Pricing, Inventory, Delivery & Lifecycle Information:

[3M:](#)

[3601/16-100](#) [3601/34-100](#) [90211/100](#) [90211/26](#) [90211/50](#) [90211/68](#) [90211/20SF](#) [90211/40](#) [90211/80](#) [10380-3280-000-1](#) [10380-3280-000-0](#) [10350-3280-000-0](#) [10350-3280-000-1](#) [10368-3280-000-0](#) [90211/36-100SF](#) [90211/36-100](#) [3601/34-300](#) [3601/34 \(100'\)](#)