

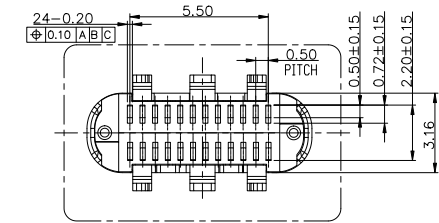

NOTES:

- 1.MATERIAL:
 MOLDING: LCP UL94 V-0
 CONTACT: COPPER ALLOY.
 GOLD PLATING ALL OVER 50u" Min NICKEL
 AND 100u" Min Tin ALL OVER 50u" Min NICKEL
 ON SOLDER AREA
 SHELL: SUS304-H,T=0.30±0.03mm
 50u" NICKEL PLATING OVER ALL.
 SHILD: SUS304-H,T=0.12±0.03mm
- 2.MECHANICAL:
 INSERTION: 5~20N.
 EXTRACTION: 8~20N AFTER TEST .
 DURABILITY: 5000 CYCLES
- 3.ELECTRICAL:
 CURRENT: 5A FOR VBUS;
 1.25A FOR GND PIN.
 0.25A FOR OTHER.
 VOLTAGE: 20 V MAX
 WITHSTANDING VOLTAGE: 100V AC R.M.S
 CONTACT RESISTANCE: 40mΩ MAX.
 INSULATION RESISTANCE: 100MΩ MIN.
- 4.ENVIRONMENTAL
 TEMPERATURE RANGE -55°C ~ +85°C

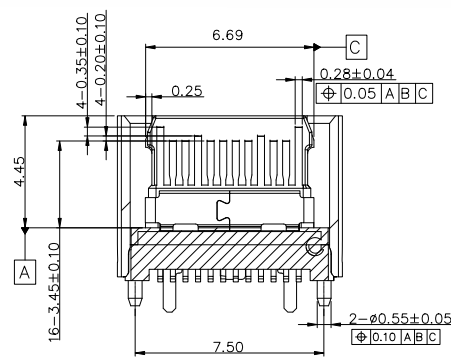
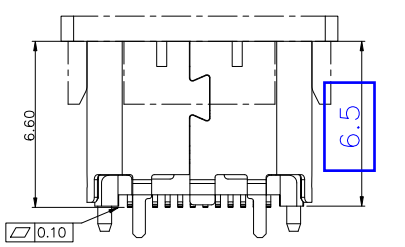
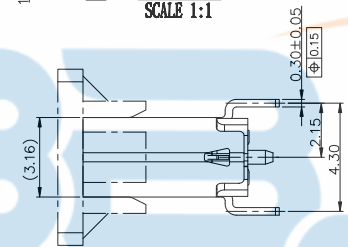
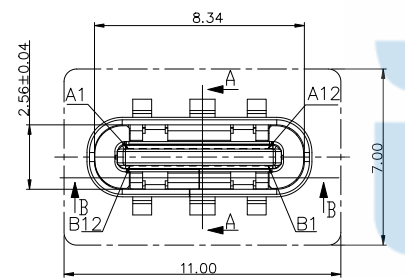
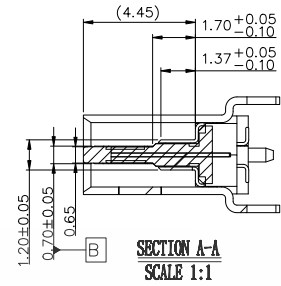
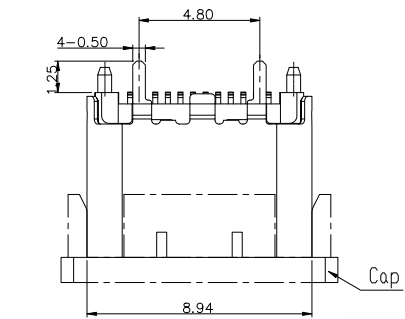

TOLERANCE UNSPECIFIED	
.	±0.50
.0	±0.35
.00	±0.25
.000	±0.15
ANGLE	±3.00°
CUSTOMER DRAWING	

深圳市步步精科技有限公司

TITLE: TYPE-C 24P 母座 直立式 H=6.5

DRAWN BY:	HMY	SIZE: A4	UNIT: mm.	PART NO. :	UC.01.62-16-0004
CHECKED BY:	LYX	SCALE: 1:1	PROJECTION	REV. : A	
APPROVED BY:	LJP	DWG . PATH	0285-1	SHEET: 1/2	

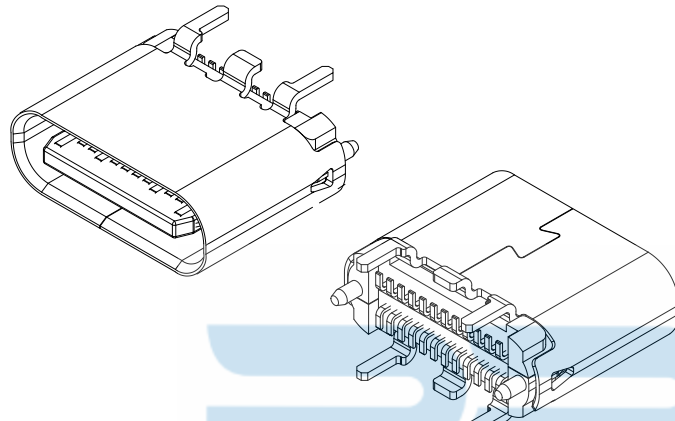

USB TYPE-C 24PIN FULL-FEATURED
RECEPTACLE INTERFACE PIN ASSIGNMENTS

PIN	Signal Name	PIN	Signal Name
A1	GND	B12	GND
A2	SSTXp1	B11	SSRXp1
A3	SSTXn1	B10	SSRXn1
A4	VBUS	B9	VBUS
A5	CC1	B8	SBU2
A6	Dp1	B7	Dn2
A7	Dn1	B6	Dp2
A8	SBU1	B5	CC2
A9	VBUS	B4	VBUS
A10	SSRXn2	B3	SSTXn2
A11	SSRXp2	B2	SSTXp2
A12	GND	B1	GND

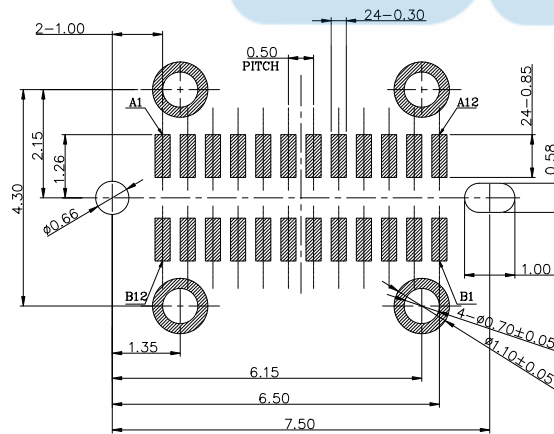

RECOMMENDED P.C.B. LAYOUT (T:1.00mm)
TOLERANCE UNSPECIFIED ±0.05mm
SCALE: 2:1



TOLERANCE UNSPECIFIED		<h2 style="text-align: center;">深圳市步步精科技有限公司</h2> <p style="text-align: center;">TITLE: TYPE-C 24P 母座 直立式 H=6.5</p>	
.	±0.50		
.0	±0.35		
.00	±0.25		
.000	±0.15		
ANGLE ±3.00°		DRAWN BY: HMY	
CUSTOMER DRAWING		SIZE: A4	UNIT: mm
		PART NO.	UC.01.62-16-0004
CHECKED BY: LYX	SCALE: 1:1	PROJECTION	REV.: A
APPROVED BY: LJP	DWG. PATH	0285-1	SHEET: 2/2



出料方向
PULL OUT DIRECTEON

NOTES

1. 帶子引導長度
LEAD TAPE LENGTH
出料方向
PULL OUT DIRECTEON

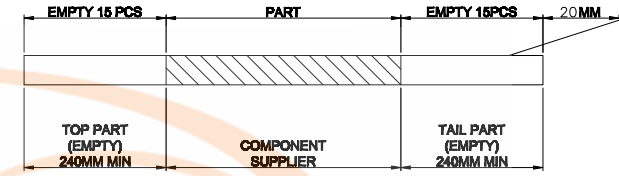
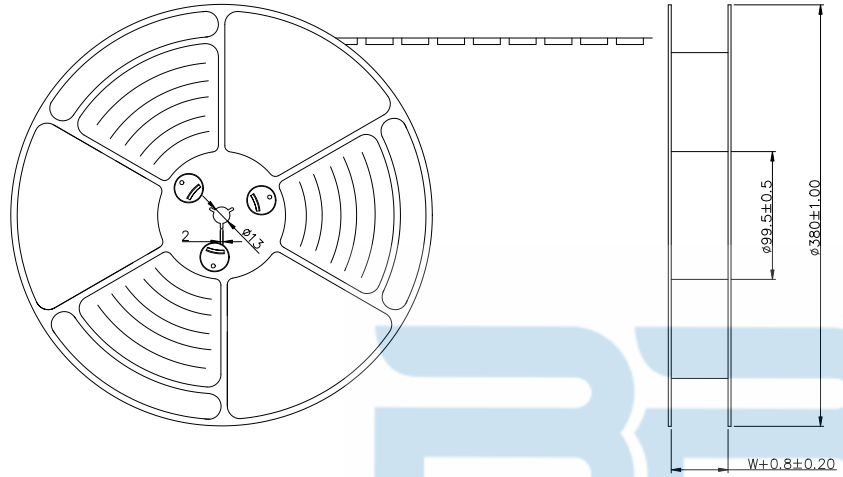

2. 出貨運輸過程中一定注意：
THIS REQUIREMENT SHOULD BE APPLIED AT SHIPMENT：
卷帶在運輸過程中不能散開
PEELING OFF SHOULD NOT BE ALLOWED DURING TRANSPORTATION

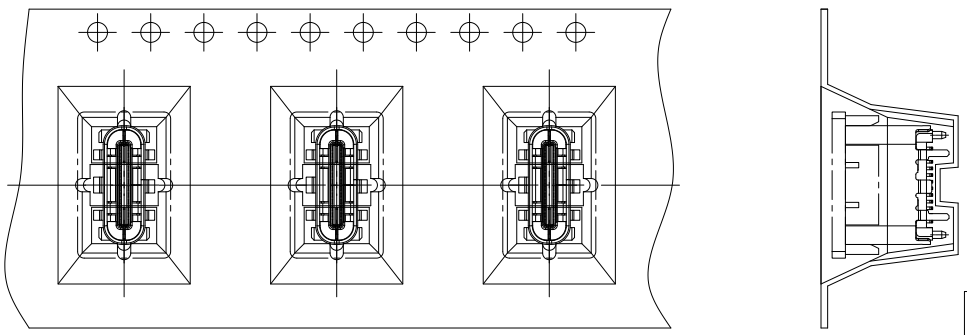

TOLERANCE UNSPECIFIED		深圳市步步精科技有限公司 TITLE: TYPE-C 24P 母座 直立式 H=6.5			
.	±0.50				
.0	±0.35	DRAWN BY:	HMY	SIZE:A4	UNIT:mm.
.00	±0.25	CHECKED BY:	LYX	PART NO.	UC.01.62-16-0004
.000	±0.15	APPROVED BY:	LJP	SCALE: 1:1	PROJECTION
ANGLE	±3.00°			DWG . PATH	0285-1
CUSTOMER DRAWING					REV.: A
					SHEET:3/4



at small positioning hole of the carrier tape side).
 標籤黏貼處 (朝捲裝包材的小定位孔一側)

Location of label sticking (label)

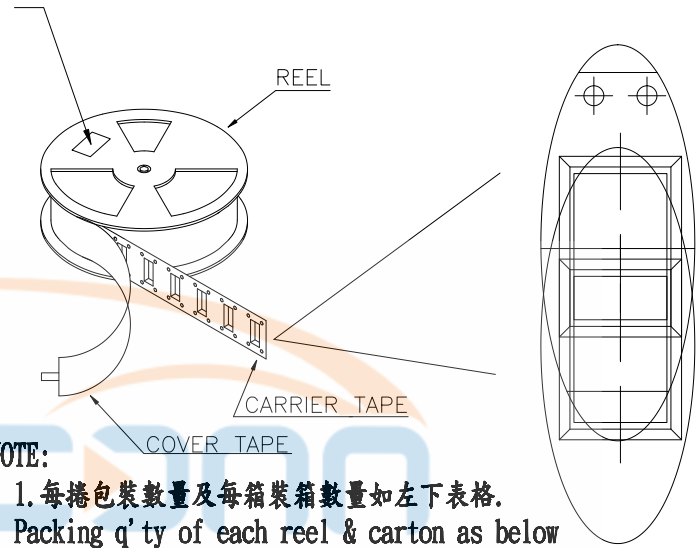
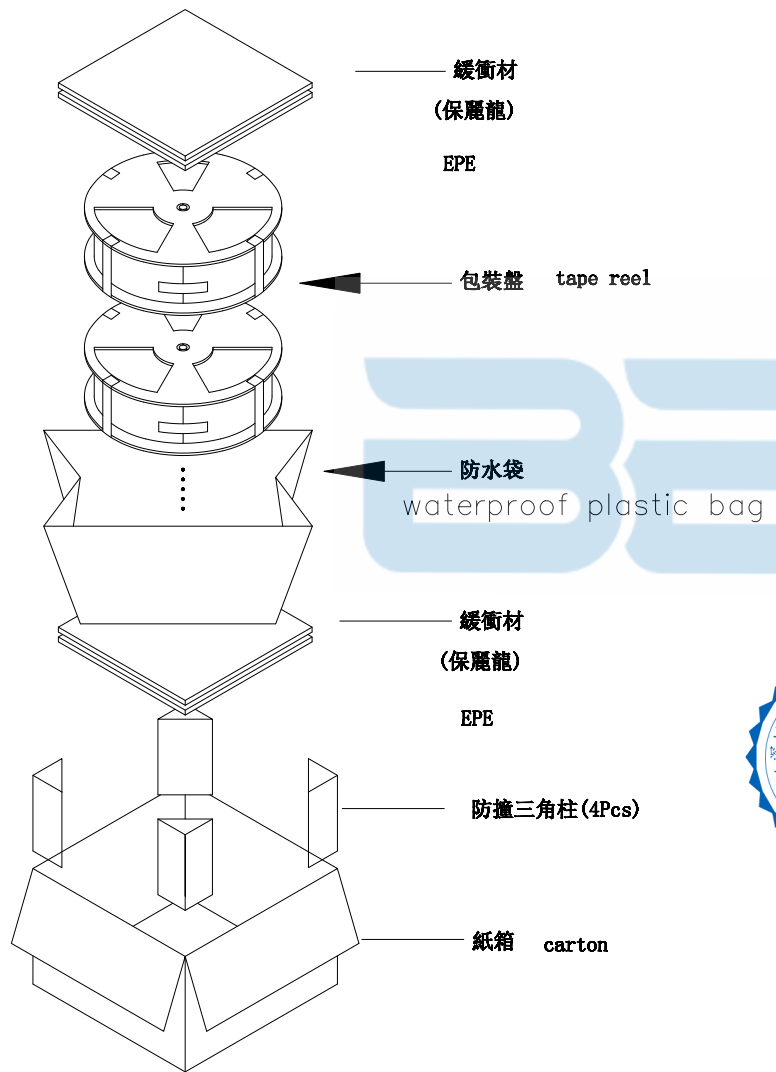

- NOTE:**
1. 每捲包裝數量及每箱裝箱數量如左下表格。
Packing q'ty of each reel & carton as below table shown.
 2. 以上膠帶覆蓋下包裝帶經包裝機熱熔包裝
Use cover tape to cover and hot melt machine to seal up.
 3. 每個紙箱放2個珍珠棉
Every carton use 2pcs EPE.
 4. 將裝滿產品的卷盤放入紙箱并以膠帶封口
Put reels in the carton and use adhesive tape to seal up.



TOLERANCE UNSPECIFIED	
.	±0.50
.0	±0.35
.00	±0.25
.000	±0.15
ANGLE	±3.00°
CUSTOMER DRAWING	

深圳市步步精科技有限公司
 TITLE: TYPE-C 24P 母座 直立式 H=6.5

DRAWN BY:	HMY	SIZE:A4	UNIT:mm.	PART NO.	UC.01.62-16-0004
CHECKED BY:	LYX	SCALE: 1:1	PROJECTION		REV.: A
APPROVED BY:	LJP	DWG . PATH	0285-1	SHEET:4/4	

產品料號 (PRODUCT No.)	包裝容量 (PACKING CAPACITY)			重量 WEIGHT (Kg)		
	PCS/REEL	REELS/CARTON	PCS/CARTON	N.W./PCS	N.W./BOX	G.W./BOX
	800	8	6400			