

## Description

The ESD5Z15V is an uni-directional TVS diode, utilizing leading monolithic silicon technology to provide fast re-sponse time and ultra low ESD clamping voltage, making this device an ideal solution for protecting voltage sensi-tive data and power line. The ESD5Z15V complies with the IEC 61000-4-2 (ESD) with  $\pm 30\text{kV}$  air and  $\pm 30\text{kV}$  con-tact discharge. It is assembled into an ultra-small SOD-523 lead-free package. The small size and high ESD surge protection make ESD5Z15V an ideal choice to pro-tect cell phone, digital cameras, audio players and many other portable applications.

## Features

- Protects one line
- Ultra low leakage: nA level
- Operating voltage: 15V
- Low clamping voltage
- Complies with following standards:
  - IEC 61000-4-2 (ESD) immunity test
    - Air discharge:  $\pm 30\text{kV}$
    - Contact discharge:  $\pm 30\text{kV}$
  - IEC61000-4-5 (Lightning) 11A (8/20 $\mu\text{s}$ )
- RoHS Compliant

## Mechanical Characteristics

- Package: SOD-523
- Case Material: “Green” Molding Compound.
- Lead Finish: Matte Tin
- Moisture Sensitivity: Level 3 per J-STD-020
- Terminal Connections: See Diagram Below
- Marking Information: See Below

## Applications

- Cellular Handsets and Accessories
- Personal Digital Assistants
- Notebooks, Desktops, Servers
- Portable Instrumentation
- Printers
- Analog Inputs
- Video equipment
- Communication systems
- Laser Diode Protection

## Marking Information



Bar denotes cathode

Details marking code reference customer approval list

## Dimensions and Pin Configuration

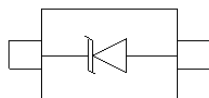

SOD-523 (Top View)

Circuit and Pin Schematic

## Ordering Information

Part Number	Packaging	Reel Size
ESD5V15V	3000/Tape & Reel	7 inch

**Absolute Maximum Ratings (T<sub>A</sub>=25°C unless otherwise specified)**

Parameter	Symbol	Value	Unit
Peak Pulse Power (8/20μs)	Ppk	350	W
Peak Pulse Current (8/20μs)	Ipp	11	A
ESD per IEC 61000-4-2 (Air)	VESD	±30	kV
ESD per IEC 61000-4-2 (Contact)		±30	
Operating Temperature Range	TJ	-55 to +125	°C
Storage Temperature Range	Tstg	-55 to +150	°C

**Electrical Characteristics (T<sub>A</sub>=25°C unless otherwise specified)**

Parameter	Symbol	Min	Typ	Max	Unit	Test Condition
Reverse Working Voltage	VRWM			15	V	
Breakdown Voltage	VBR	18			V	IT = 1mA
Reverse Leakage Current	IR			0.2	μA	VRWM = 15V
Clamping Voltage	VC			23	V	I <sub>PP</sub> = 1A (8 x 20μs pulse)
Clamping Voltage	VC			32	V	I <sub>PP</sub> = 11A (8 x 20μs pulse)
Junction Capacitance	CJ			80	pF	VR = 0V, f = 1MHz

**Typical Performance Characteristics ( $T_A=25^\circ\text{C}$  unless otherwise Specified)**

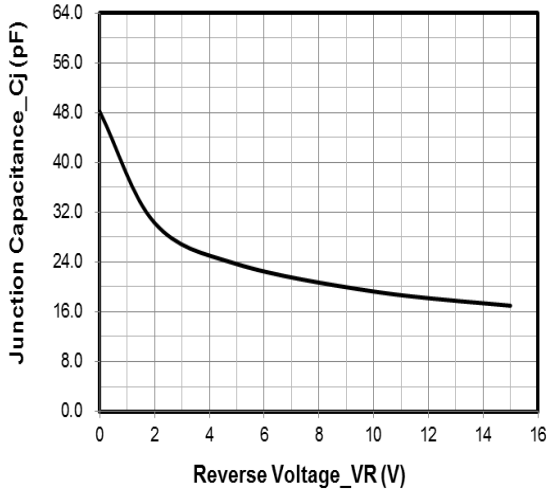

**Junction Capacitance vs. Reverse Voltage**

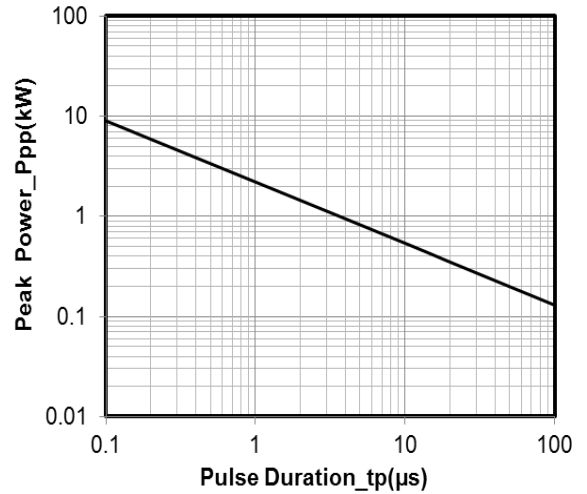

**Peak Pulse Power vs. Pulse Time**

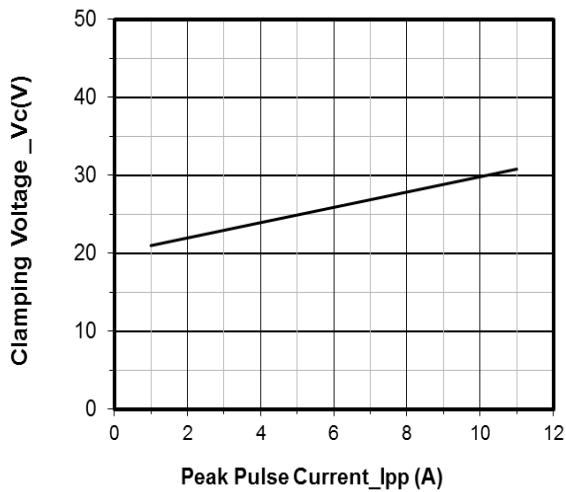

**Clamping Voltage vs. Peak Pulse Current**

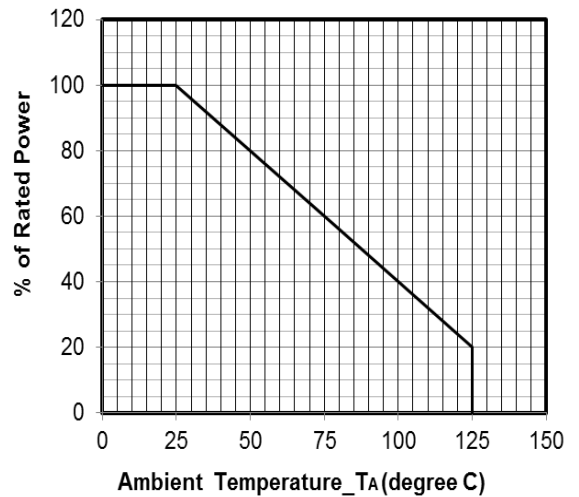

**Power Derating Curve**

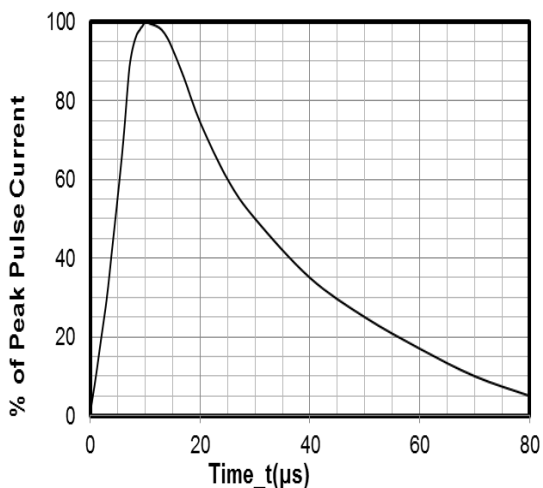

**8 X 20 $\mu\text{s}$  Pulse Waveform**

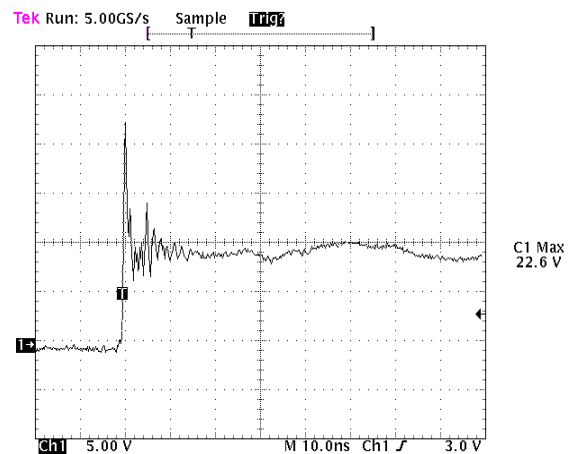

**Note: Data is taken with a 10x attenuator**  
**ESD Clamping Voltage**  
**+8 kV Contact per IEC61000-4-2**

### SOD-523 Package Outline Drawing

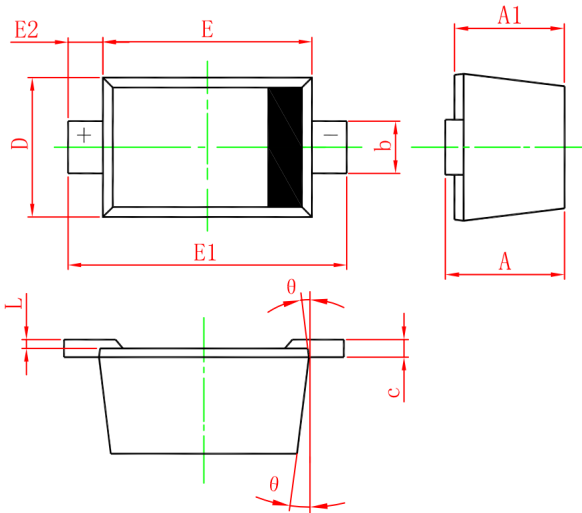

SYM	DIMENSIONS					
	MILLIMETERS			INCHES		
	MIN	NOM	MAX	MIN	NOM	MAX
A	0.51	--	0.77	0.020	--	0.031
A1	0.50	--	0.70	0.020	--	0.028
b	0.25	--	0.35	0.010	--	0.014
c	0.08	--	0.15	0.003	--	0.006
D	0.75	--	0.85	0.030	--	0.033
E	1.10	--	1.30	0.043	--	0.051
E1	1.50	--	1.70	0.059		0.067
E2	0.20REF			0.008REF		
L	0.01	--	0.07	0.001	--	0.003
Θ	7° REF			7° REF		

### Suggested Land Pattern

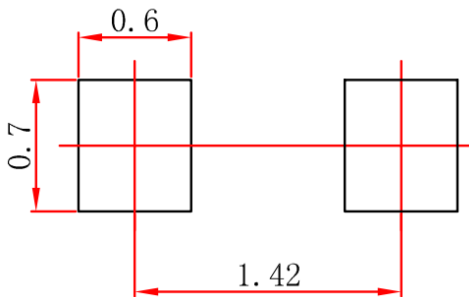

Unit: mm

### Contact Information

WPMTEK Incorporated Limited  
 Room 206-207,2nd Floor,Block 3,Minxing Industry Park,Minzhi  
 Longhua New District,Shenzhen  
 TEL: 86755-29308003      FAX: 86755-23739900

WPMtek Incorporated Limited (WPM) reserves the right to make changes to the product specification and data in this document without notice. WPM makes no warranty, representation or guarantee regarding the suitability of its products for any particular purpose, nor does WPM assume any liability arising from the application or use of any products or circuits, and specifically dis-claims any and all liability, including without limitation special, consequential or incidental damages.