

GMA3722H11-F42 硅微麦克风

详情说明

4.FREQUENCY RESPONSE CURVE

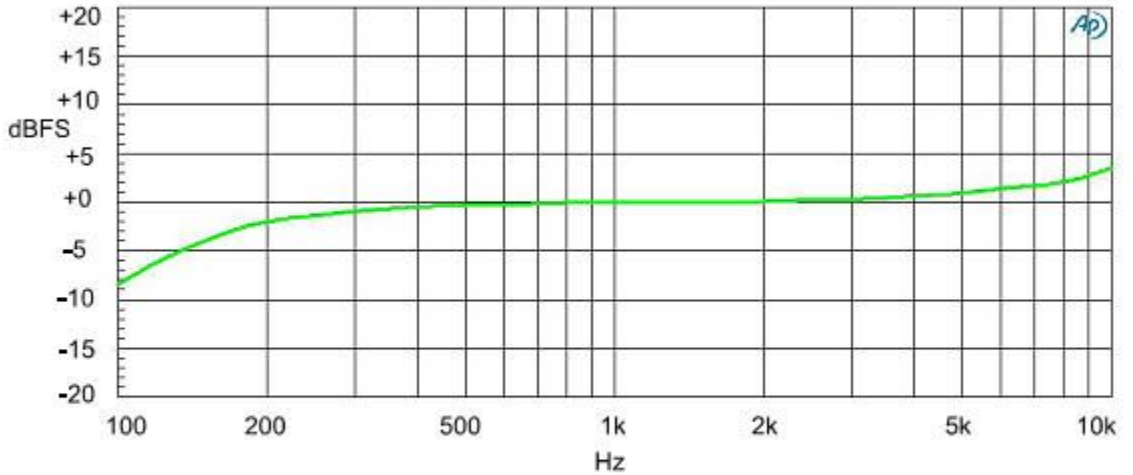
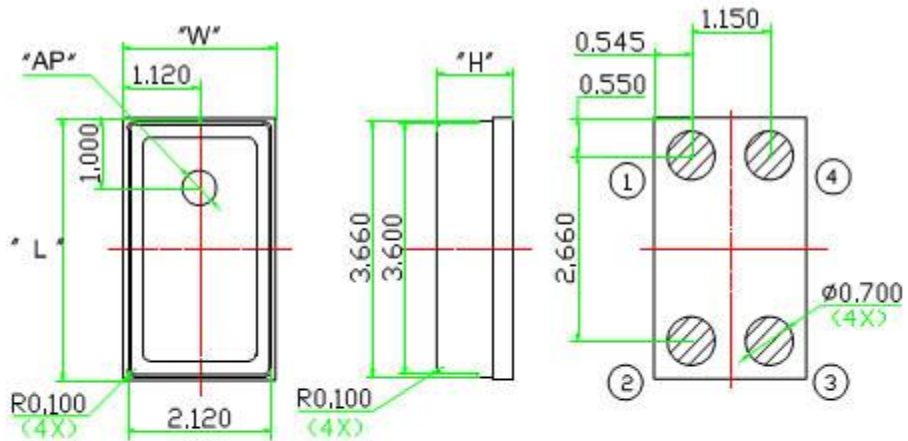

Figure 1. Typical free field frequency response(Normalized to 1 KHz)

5.MECHANICAL SPECIFICATIONS



ITEM	DIMENSION	TOLERANCE	UNITS
LENGTH(L)	3.760	±0.100	mm
WIDTH(W)	2.240	±0.100	mm
HEIGHT(H)	1.100	±0.100	mm
ACOUSTIC PORT(AP)	Φ0.500	±0.100	mm

PIN OUTPUT	
PIN#	FUNCTION
1	POWER(Vdd)
2	GROUND
3	GROUND
4	OUTPUT

PERFORMANCE					
Parameter	Conditions	Min	Typ	Max	Unit
Directivity		Omni-Directional			
Sensitivity	@1KHz (0 dB = 1V/Pa)	-45	-42	-39	dB
Signal-to-Noise Ratio	@1KHz (0 dB = 1V/Pa)		56		dB
Total Harmonic Distortion (THD) @ 100dB SPL	@1KHz		0.2	0.5	%
Total Harmonic Distortion (THD) @ 115dB SPL	@1KHz		0.5	1	%
Max Input Sound Pressure	@1KHz, THD < 10%		130		dB SPL
Power Supply Rejection (PSR)	217Hz, 100m Vpp square wave		-84	-79	dB
INPUT CHARACTERISTICS					
Power supply Voltage		1.6		3.6	V
Sensitivity Loss Across Power Supply Voltage	Change in sensitivity from 1.6V to 3.6V power supply voltage	No change			dB
Total Operation Current	1.6V-3.6V power supply voltage		160	200	uA
Standby Current	1.6V-3.6V power supply voltage			2	uA
OUTPUT CHARACTERISTICS					
LOAD Capacitance				100	pF
Output Impedance	@1KHz (0 dB = 1 V/Pa)			200	Ω