

型号 : SBT641

特点与用途/Features&Application

微型传感器，高度低，变形量小，圆柱外形，不锈钢材料，拉压双向，主要用于推、拉力计，各种工业测力及称重系统等。



The micro sensor, low altitude, the deformation is small
Two-way cylindrical shape, stainless steel materials, tension and compression
Mainly for the push, pull, all kinds of industrial weighing system and so on

安装尺寸/Mounting Dimension

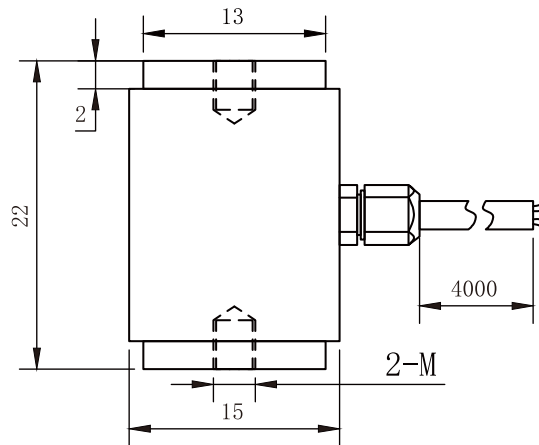

量程	M
10,20,50	M3
100,200,300,500	M4

受力方式/Load Direction

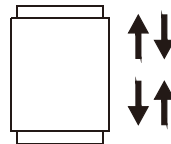

接线图/Wiring

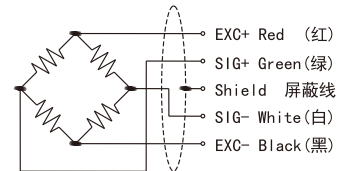

技术参数/Technical Parameters

参数	Specifications	技术指标/Technique
传感器量程	Rated load	20, 50, 100, 150, 200, 300, 500N
综合误差	Comprehensive error	≤ ±0.05%
非线性	Non-linearity	0.05%
灵敏度	Rated output	2.0 ± 10% mV/V
蠕变	Creep	±0.05% F.S. / 30min
零点输出	Zero balance	±2.0 F.S.
输入阻抗	Input resistance	350 ± 20 Ω
输出阻抗	Output resistance	350 ± 5 Ω
绝缘电阻	Insulation resistance	≥ 5000 MΩ / 100VDC
灵敏度温度影响	Temp. effect on span	±0.05% F.S. / 10°C
零点温度影响	Temp. effect on zero	±0.05% F.S. / 10°C
温度补偿范围	Compensated temp range	-10 ~ 60°C
使用温度范围	Use temp range	-20 ~ 80°C
激励电压	Excitation voltage	5 ~ 15V
安全过载范围	Safe overload	150% F.S.
极限过载范围	Ultimate overload	200% F.S.
防护等级	Defend grade	Ip66