

中型減速電機

MEDIUM GEAR MOTOR

100W-7500W

就是耐用！

德國技術 傳動未來

GERMAN TECHNOLOGY DRIVE IN
THE FUTURE

■ 型號命名
MODEL NAME

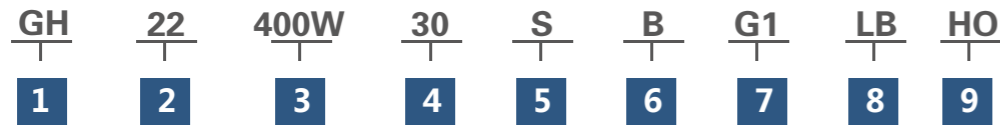

- 1** 1.機型代號1.Model Code TYPES:
GH:臥式安裝齒輪減速電機
GH:Horizontal Installation Gear Reducer Motor
GV:立式安裝齒輪減速電機
GV:Vertical Installation Gear Reducer Motor
GHM:臥式安裝直結型齒輪減速電機
GHM:Horizontal Installation Straight Gear Reducer Motor
GVM:立式安裝直結型齒輪減速電機
GVM:Vertical Installation Straight Gear Reducer Motor
GHD:臥式安裝雙轉型齒輪減速電機
GHD:Horizontal Installation Biax Reducer Motor
GVD:立式安裝雙轉型齒輪減速電機
GVD:Vertical Installation Biax Gear Reducer Motor
- 2** 出力軸Output shaft:18/22/28/32.....
- 3** 馬力CAPACITY:100W-3700W
- 4** 減速比RATIO:3,5,10...1800
- 5** S:附三相馬達220V、380V/50、60HZ-3PHASE
A:附單相馬達110V、220V/50、60HZ-1PHASE
- 6** B:斷電制動器BRAKEUNIT
AB:手釋放制動器WITH RELE ASE BRAKE UNIT
D:DC24V送電制動器DC24V BRAKE
- 7** 依出力軸看配盒方向
VIEW FROM OUTPUT SHAFT
G1:左方向LEFT(標準型) (STD)
G2:右方向RIGHT
G3:上方向UPPER
G4:下方向UPPER
- 8** 入線口方向WIREINLET
T:向上TOP
D:向下DOWN
F:向前FORWARD
B:向後BACK
L:向左LEFT
R:向右RIGHT
- 9** 透氣塞安裝位置選定
BREATHABLE PLUG IS MOUNTED POSMON OF THE SELECTED
GH機型安裝位置GH Model installation Location
HO標準(正立) H3(左側) H6(倒裝)
H9(右側) HU(軸向上) HD(軸向下)
GV機型安裝位置GV Model installation Location
VO標準(正立) V3(順轉90度) V6(順轉180度)
V9(逆轉90度) VU(軸向上) VD(軸向下)

配線盒方向選定 (TERMINAL BOX DIRECTION)

TYPE	G1-左方向 LEFT SIDE	G2-右方向 RIGHT SIDE	G3-上方向 UPPER SIDE	G4-下方向 LOWER SIDE
GH型 GH TYPE	G1	G2	G3	G4
GV型 GV TYPE	G1	G2	G3	G4
入線口方向 WIRE INLET DIRECTION	LD	RT	TL	DL
	LF	RB	TF	DB

■ 連接方式 WERING DIAGRAM

三相馬達/制動器接線方式 Three-phase motor / brake wiring

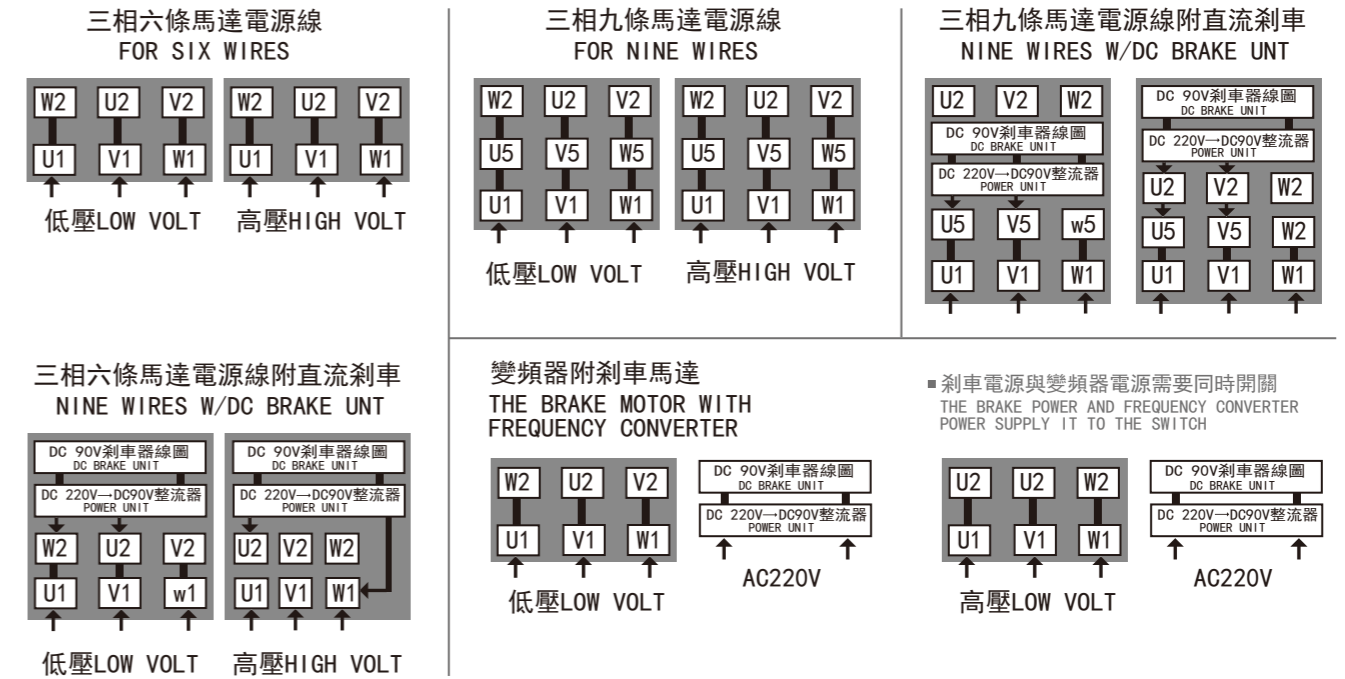

單相馬達/制動器接線方式 Single-phase motor / brake wiring

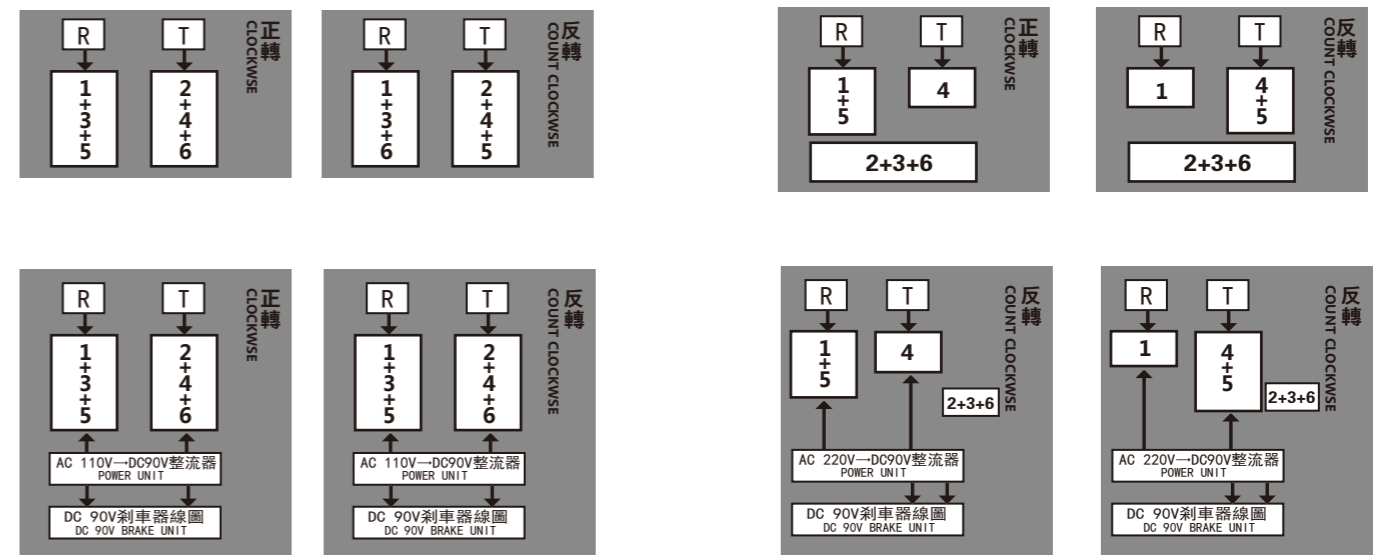

定速電機

調速電機

定速電磁制動電機

調速電磁制動電機

中型齒輪減速電機

行星減速機

鋁合金刀<減速機

■輸出扭矩表 OUTPUT TORQUE

標準型
NORMAL DUTY TYPE

減速比 RATIO	輸出轉速 OUTPUT RPM		輸出扭矩 OUTPUT TORQUE																		單位: KG.M Units: KG.M	
			0.1KW		0.2KW		0.4KW		0.75KW		1.5KW		2.2KW		3.7KW		5.5KW		7.5KW			
	50HZ	60HZ	50HZ	60HZ	50HZ	60HZ	50HZ	60HZ	50HZ	60HZ	50HZ	60HZ	50HZ	60HZ	50HZ	60HZ	50HZ	60HZ	50HZ	60HZ		
3	465	570	0.19	0.16	0.37	0.31	0.70	0.60	1.30	1.10	2.60	2.20	3.80	3.20	6.00	5.50	9.8	9	13.4	10.9		
5	300	360	0.31	0.26	0.62	0.52	1.20	1.00	2.20	1.90	4.50	3.80	6.72	5.60	11.0	10.1	16.4	13.3	22.4	18.2		
10	150	180	0.62	0.52	1.24	1.04	2.40	2.00	4.50	3.80	9.10	7.60	13.7	11.2	22.0	20.0	32.9	26.7	44.8	36.4		
15	100	120	0.91	0.76	1.80	1.50	3.60	3.00	6.80	5.70	13.5	11.3	20.1	16.8	32.6	29.8	50.3	40	67.3	54.6		
20	75	90	1.20	1.00	2.40	2.00	4.80	4.00	9.00	7.50	18.1	15.1	26.8	22.4	43.6	36.0	65.8	53.4	89.7	72.8		
25	60	72	1.40	1.20	3.00	2.50	6.00	5.00	11.2	9.40	22.6	18.9	33.6	28.0	53.9	49.5	82.3	66.7	122.2	91		
30	50	60	1.80	1.50	3.60	3.00	7.30	6.00	13.5	11.3	27.1	22.6	40.3	33.6	64.7	58.8	98.7	80.1	134.6	109.2		
40	37	45	2.20	1.90	4.60	3.90	9.30	7.80	17.5	14.6	34.9	29.1	52.0	43.4	86.3	78.4	131	106.8	179.5	145.6		
45	33	40	2.70	2.20	5.40	4.40	10.9	9.10	20.6	17.0	41.4	34.0	59.8	49.6	98.5	81.7	148.1	120.1	202	163.8		
50	30	36	2.80	2.40	5.70	4.80	11.6	9.70	21.9	18.3	43.6	36.4	65.1	54.3	107	97.0	164.4	133.5	244.4	182		
60	25	30	3.40	2.90	6.90	5.80	13.9	11.6	26.2	21.9	52.4	43.7	78.1	65.1	127	115	197.5	160.2	269.3	218.5		
70	21	25	4.30	3.60	8.00	6.80	16.2	13.5	31.5	26.3	62.4	52.0	92.5	77.1	155	125.7	230.4	180.9				
80	19	23	4.80	4.00	9.20	7.70	18.4	15.4	35.5	29.6	70.8	59.0	105	87.5	177.1	143.7	263.3	213.6				
90	17	20	5.20	4.40	10.3	8.60	20.7	17.3	39.3	32.8	77.1	64.3	113	94.3	199.3	161.6	296.3	240.3				
100	15	18	5.80	4.90	11.5	9.60	23.0	19.2	43.2	36.0	83.7	69.8	126	105	221.5	179.6	329.2	267				
120	12	15	6.90	5.80	13.8	11.5	27.7	23.1	51.8	43.2	101	83.7	150	145	265.7	215.5						
140	11	13	8.00	6.70	16.0	13.4	32.0	26.7	59.7	49.8	116	96.8										
160	9	11	9.10	7.60	18.3	15.3	36.3	30.3	68.0	56.7	132	110										
180	8	10	10.3	8.60	20.7	17.3	40.3	34.0	76.8	64.0	148	123										
200	7	9	11.6	9.70	22.9	19.1	43.2	36.0	82.8	69.0												

■尺寸表 DIMENSIONS

(1)立式三相標準IEC鋁殼(剎車)馬達
Vertical three-phase standard IEC aluminum (brake) motor

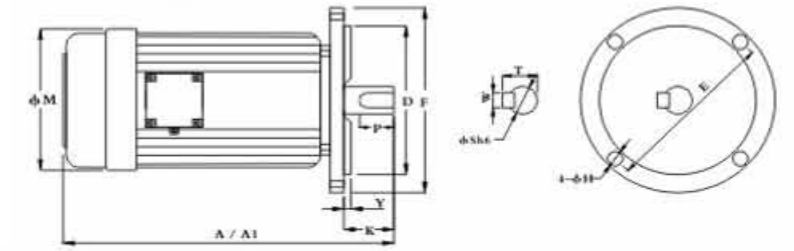

DIMENSIONS (M/M)

馬力 HP-4P	A	A1	D	E	F	H	K	M	P	S	T	W	Y	重量KG
100W 1/8HP	200	200	110	130	160	10	23	127	10	12.5	12.5	4	3	3.8
200W 1/4HP	220	220	110	130	160	10	23	127	10	12.5	12.5	4	3	5.5
400W 1/2HP	250	250	110	130	160	10	30	127	14	16	16	5	3	6.9
750W 1HP	295	295	130	165	200	12	40	159	25	21.5	21.5	6	3	10.6
1500W 2HP	350	370	130	165	200	12	50	190	32	27	27	8	3.5	16.5
2200W 3HP	384	410	180	215	250	14.5	60	220	40	31	31	8	4	28
3700W 5HP	400	426	180	215	250	14.5	60	220	40	31	31	8	4	34.5
5500W 7.5HP	447	487	230	265	300	15	80	250	60	41.5	41.5	10	4	45
7500W 10HP	487	527	230	265	300	15	90	250	60	41.5	41.5	10	4	55

備註: A1為三相帶剎車馬達尺寸
Remarks: A1 is the size of the three-phase motor with brake

●(2)GH臥式5.5KW、7.5KW附三相鋁殼(剎車)齒輪減速馬達
GH horizontal 5.5KW, 7.5KW attached to the-phase aluminum (brake) Gear Motors...

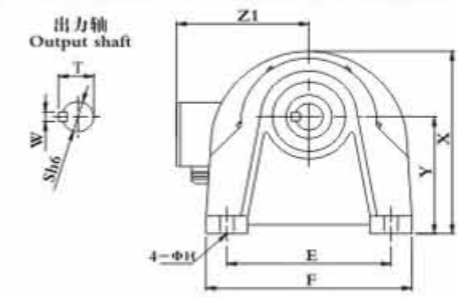
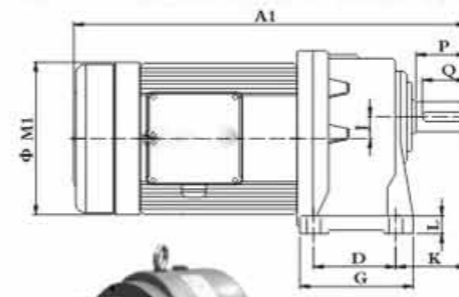

出力軸尺寸 OUTPUT SHAFT					
出力軸 SHAFT	鍵槽 KEYWAY			鍵 KEY	
SH6	P	W	T	Q	SPEC
Φ45	75	12	48.5	70	12*8*70
Φ50	80	14	54	75	14*9*75
Φ60	90	15	63.5	85	15*10*85

馬力 HP-4P	減速比 GEAR RATIO	本體 CODE	型號 TYPE	A1	A3	D	E	F	G	H	L	J	K	M1	X	Y	Z1	重量KG
5500W 7.5HP	5-10	7#	45	545	585	200	250	310	235	15	30	42.2	93	250	265	175	178	78
	11-30	7#	50	579	619	170	265	330	220	19	30	51.7	104	250	315	200	178	88
	31-60	7#	50	579	619	170	265	330	220	19	30	51.7	104	250	315	200	178	90
	61-100	7#	60	589	629	170	265	330	220	19	30	51.7	115	250	315	200	178	93
7500W 10HP	5-10	8#	50	619	659	170	265	330	220	19	30	51.7	104	250	315	200	178	99
	11-30	8#	60	629	669	170	265	330	220	19	30	51.7	115	250	315	200	178	103
	31-60	8#	60	629	669	170	265	330	220	19	30	51.7	115	250	315	200	178	110

備註: A3為三相帶剎車馬達尺寸
Remarks: A3 is the size of the three-phase motor with brake

■ 尺寸表
DIMENSIONS

(3)GH臥式附三相、單相鋁殼(剎車)齒輪減速馬達

GH horizontal attached single-phase three-phase,aluminum shell(brake) gear reducer motors

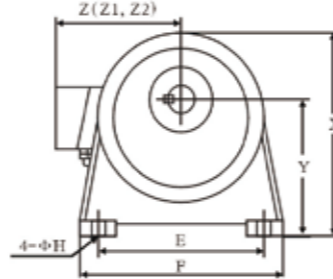
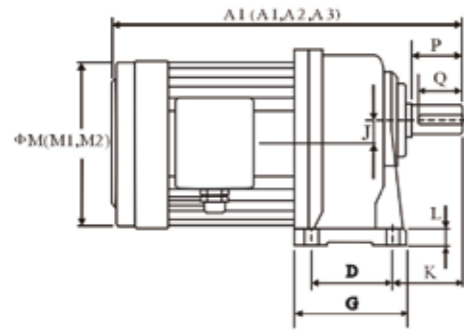

出力軸尺寸 OUTPUT SHAFT					
出力軸 SHAFT		鍵槽 KEYWAY			鍵 KEY
SH6	P	W	T	Q	SPEC
Φ18	30	5	20.2	25	5*5*25
Φ22	40	7	25	35	7*7*35
Φ28	45	7	31.1	40	7*7*40
Φ32	55	10	35.5	50	10*8*50
Φ40	65	10	43.5	60	10*8*60
Φ50	80	14	54	75	14*9*75

DIMENSIONS (M/M)

馬力 HP-4P	減速比 GEAR-RATIO	本體 CODE	型號 TYPE	A1	A2	A3	D	E	F	G	H	L	J	K	M1	M2	X	Y	Z1	Z2	重量 KG
100W 1/8HP	3-50	1#	18	253	273	257	40	110	135	65	9	10	16	45	127	127	132	88.5	116	116	5.3
	60-200	2#	22	287	307	291	65	130	163	90	11	15	18.2	56	127	127	152	97.5	116	116	6.9
		2#	*22	287	307	291	55	170	146	146	11	12	18.2	49	127	127	3.5	116	116	6.7	
200W 1/4HP	3-10	1#	18	273	293	277	40	110	135	65	9	10	16	45	127	127	132	88.5	116	116	6.7
	15-90	2#	22	307	327	311	65	130	163	90	11	15	18.2	56	127	127	152	97.5	116	116	8.6
		3#	28	333	353	377	90	140	180	122	11	15	20.8	65	127	127	180	116	116	116	11
400W 1/2HP	3-10	2#	22	327	346	331	65	130	163	90	11	15	18.2	56	127	159	152	97.5	116	133	11
	15-90	3#	28	353	372	357	90	140	180	122	11	15	20.8	65	127	159	180	116	116	133	14
		4#	32	388	407	392	130	170	215	160	13	25	30.2	76	127	159	210	138.5	116	133	26
750W 1HP	3-25	3#	28	382	415	382	90	140	180	122	11	15	20.8	65	159	190	180	116	133	145	15
	30-120	4#	32	417	449	417	130	170	215	160	13	25	30.2	76	159	190	210	138.5	133	145	28
		5#	40	444	476	444	150	210	260	185	15	25	42.2	85	159	190	248	160	133	145	42
1500W 2HP	4-25	4#	32	449		470	130	170	215	160	13	25	30.2	76	190		210	138.5	133		34
	30-120	5#	40	476		497	150	210	260	185	15	25	42.2	85	190		248	160	145		47
		6#	50	517		538	170	265	330	220	19	30	51.7	104	190		315	200	145		52
2200W 3HP	3-60	5#	40	482		508	150	210	260	185	15	25	42.2	85	217		248	160	153		48
	70-200	6#	50	523		549	170	265	330	220	19	30	51.7	104	217		315	200	153		55
3700W 5HP	3-10	5#	40	498		524	150	210	260	185	15	25	42.2	85	217		248	160	153		50
	15-180	6#	50	539		565	170	265	330	220	19	30	51.7	104	217		315	200	153		57

備註: A1、M1、Z1為三相馬達尺寸; A3為三相帶剎車馬達尺寸

Note:A1,M1,Z1,are the sizes of three-phase motors,A3 is the size of three-phase motors with brakes

A2、M2、Z2為單相馬達尺寸

A2、M2、Z2are the sizes of single-phase motors

■ 尺寸表
DIMENSIONS

(4)GV立式附三相、單相鋁殼(剎車)齒輪減速馬達

GV All cinemas with single-phase three-phase,vertical aluminum shell(brake) gear reducer motors

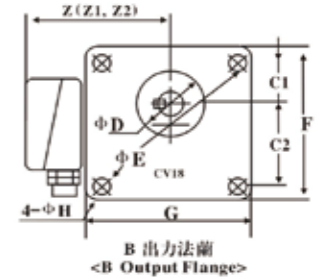
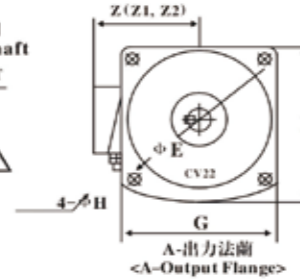
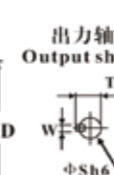
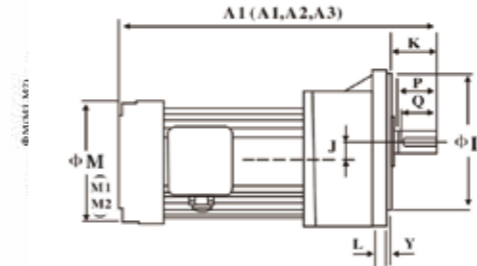

備註: 1.#本體 (型號為18) C1為33.5, C2為65.5
1.#本體 (型號為22) C1為40, C2為80



出力軸尺寸 OUTPUT SHAFT					
出力軸 SHAFT		鍵槽 KEYWAY			鍵 KEY
SH6	P	W	T	Q	SPEC
Φ18	30	5	20.2	25	5*5*25
Φ22	40	7	25	35	7*7*35
Φ28	45	7	31.1	40	7*7*40
Φ32	55	10	35.5	50	10*8*50
Φ40	65	10	43.5	60	10*8*60
Φ50	80	14	54	75	14*9*75

馬力 HP-4P	減速比 GEAR-RATIO	本體 CODE	型號 TYPE	A1	A2	A3	D	E	F	G	H	L	J	K	M1	M2	Y	Z1	Z2	重量 KG
100W 1/8HP	3-50	1#	*18	253	273	257	50	140	120	120	9	12	16	38	127	127	5	116	116	5.3
	60-200	2#	22	287	307	291	148	185	170	156	11	12	18.2	49	127	127	3.5	116	116	6.9
		2#	*22	287	307	291	55	170	146	146	11	12	18.2	49	127	127	3.5	116	116	6.7
200W 1/4HP	3-10	1#	*18	273	293	277	50	140	120	120	9	12	16	38	127	127	5	116	116	6.9
	15-90	2#	22	307	327	311	148	185	170	156	11	12	18.2	49	127	127	3.5	116	116	8.6
		3#	28	333	353	337	170	220	200	190	11	15	20.8	57	127	127	4	116	116	11
400W 1/2HP	3-10	2#	22	327	346	331	148	185	170	156	11	12	18.2	49	127	159	3.5	116	133	11
	15-90	2#	*22	327	346	331	55	170	146	146	11	12	18.2	49	127	127	3.5	116	133	11
		3#	28	353	372	357	170	220	200	190	11	15	20.8	57	127	159	4	116	133	14
750W 1HP	3-25	3#	28	382	415	382	170	220	200	190	11	15	20.8	57	159	190	4	133	145	15
	30-120	4#	32	417	449	417	185	255	240	225	13	17	30.2	67	159	190	4	133	145	28
		5#	40	444	476	444	230	310	300	275	15	20	42.2	79	159	190	5	133	145	42
1500W 2HP	4-25	4#	32	449		470	185	255	240	225	13	17	30.2	67	190		4	145		34
	30-120	5#	40	476		497	230	310	300	275	15	20	42.2	79	190		5	145		47
		6#	50	517		538	280	390	360	330	19	20	51.7	90	190		5	145		52
2200W 3HP	3-60	5#	40	482		508	230	310	300	275	15	20	42.2	79	217		5	153		48
	70-200	6#	50	523		549	280	390	360	330	19	20	51.7	90	217		5	153		55
3700W 5HP	3-10	5#	40	498		524	230	310	300	275	15	20	42.2	79	217		5	153		50
	15-180	6#	50	539		565	280	390	360	330	19	20	51.7	90	217		5	153		57

備註: A1、M1、Z1為三相馬達尺寸; A3為三相帶剎車馬達尺寸

Note:A1,M1,Z1,are the sizes of three-phase motors,A3 is the size of three-phase motors with brakes

A2、M2、Z2為單相馬達尺寸

A2、M2、Z2are the sizes of single-phase

*屬於B型號出力法蘭*BELONG TO B TYPE OUTPUT FLANGE

■ 尺寸表
DIMENSIONS

(5)GH臥式高速比附三相、單相鋁殼(剎車)齒輪減速馬達

GH horizontal high-speed opponent single-phase three-phase, aluminum shell(brake) gear reducer motors

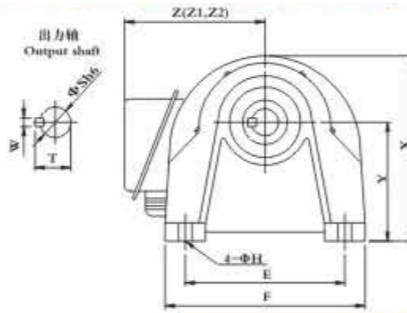
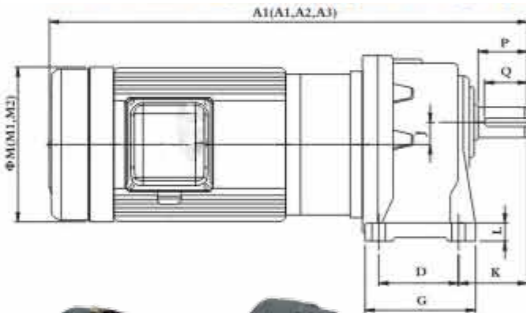

備註: A1, M1, Z1為三相馬達尺寸:
A3為三相帶剎車馬達尺寸
Note:A1,M1,Z1,are the sizes of three-phase motors,
A3 is the size of three-phase motors with brakes
A2, M2, Z2為單相馬達尺寸
A2, M2, Z2are the sizes of single-phase motors



出力軸尺寸 OUTPUT SHAFT					
出力軸 SHAFT	鍵槽 KEYWAY			鍵 KEY	
SH6	P	W	T	Q	SPEC
Φ28	45	7	31.1	40	7*7*40
Φ32	55	10	35.5	50	10*8*50
Φ40	65	10	43.5	60	10*8*60
Φ50	80	14	54	75	14*9*75

DIMENSIONS (M/M)

馬力 HP-4P	減速比 GEAR RATIO	本體 CODE	型號 TYPE	A1	A2	A3	D	E	F	G	H	L	J	K	M1	M2	X	Y	Z1	Z2	重量 KG
100W 1/4HP	250-1800	1#+3#	28	390	410	394	90	140	180	122	11	15	20.8	65	127	127	180	116	116	116	13.2
200W 1/4HP	250-1800	2#+4#	32	471	491	475	130	170	215	160	13	20	30.2	76	127	127	210	138.5	116	116	29.6
400W 1/2HP	250-1800	3#+5#	40	532	551	536	150	210	260	185	15	23	42.2	85	127	159	248	160	116	133	49
750W 1HP	250-1800	3#+6#	50	602	635	602	170	265	330	220	19	25	51.7	104	159	190	315	200	133	145	59

(6)GV立式高速比附三相、單相鋁殼(剎車)齒輪減速馬達

GH All cinemas vertical high-speed opponent single three-phase, aluminum (brake)Gear Motors...

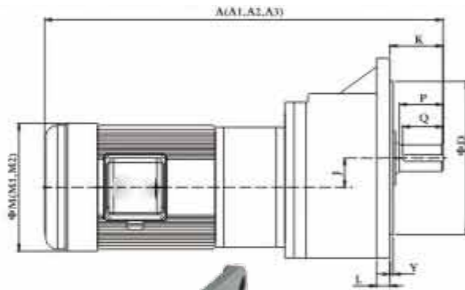

備註: A1, M1, Z1為三相馬達尺寸:
A3為三相帶剎車馬達尺寸
Note:A1,M1,Z1,are the sizes of three-phase motors,
A3 is the size of three-phase motors with brakes
A2, M2, Z2為單相馬達尺寸
A2, M2, Z2are the sizes of single-phase motors



出力軸尺寸 OUTPUT SHAFT					
出力軸 SHAFT	鍵槽 KEYWAY			鍵 KEY	
SH6	P	W	T	Q	SPEC
Φ28	45	7	31.1	40	7*7*40
Φ32	55	10	35.5	50	10*8*50
Φ40	65	10	43.5	60	10*8*60
Φ50	80	14	54	75	14*9*75

DIMENSIONS (M/M)

馬力 HP-4P	減速比 GEAR RATIO	本體 CODE	型號 TYPE	A1	A2	A3	D	E	F	G	H	L	J	K	M1	M2	Y	Z1	Z2	重量 KG
100W 1/8HP	250-1800	1#+3#	28	390	410	394	170	220	200	190	11	15	20.8	57	127	127	4	116	116	13.2
200W 1/4HP	250-1800	2#+4#	32	471	491	475	185	255	240	225	13	15	30.2	67	127	127	4	116	116	29.6
400W 1/2HP	250-1800	3#+5#	40	532	551	536	230	310	300	275	15	20	42.2	79	127	159	5	116	133	49
750W 1HP	250-1800	3#+6#	50	602	635	602	280	390	360	330	19	20	51.7	90	159	190	5	133	145	59

備註: A1, M1, Z1為三相馬達尺寸: A3為三相帶剎車馬達尺寸

Note:A1,M1,Z1,are the sizes of three-phase motors,A3 is the size of three-phase motors with brakes

A2、M2、Z2為單相馬達尺寸

A2、M2、Z2are the sizes of single-phase motors

■ 尺寸表
DIMENSIONS

(7)GH臥式附三相、單相鋁殼(剎車)縮框型齒輪減速馬達

GH horizontal attached single-phase three-phase, aluminum shell(brake)shrink box type gear reducer motors

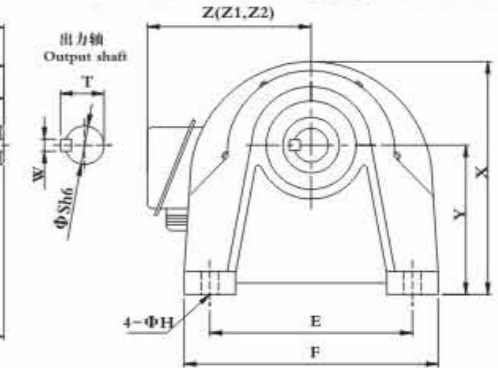
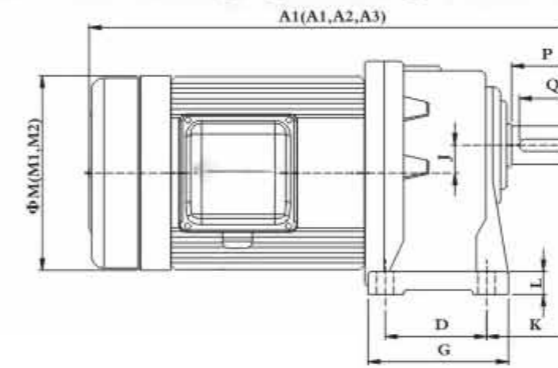

出力軸尺寸 OUTPUT SHAFT					
出力軸 SHAFT	鍵槽 KEYWAY			鍵 KEY	
SH6	P	W	T	Q	SPEC
Φ18	30	5	20.2	25	5*5*25
Φ22	40	7	25	35	7*7*35
Φ28	45	7	31.1	40	7*7*40
Φ32	55	10	35.5	50	10*8*50
Φ40	65	10	43.5	60	10*8*60

DIMENSIONS (M/M)

馬力 KW	減速比 GEAR-RATIO	本體 CODE	型號 TYPE	A1	A2	A3	D	E	F	G	H	L	J	K	M1	M2	X	Y	Z1	Z2	重量 KG
100W	50-200	1#	18	253	273	257	40	110	135	65	9	10	16	45	127	127	132	88.5	116	116	5.3
200W 1/4HP	15-90	1#	18	273	293	277	40	110	135	65	9	10	16	45	127	127	132	88.5	116	116	5.3
	100-200	2#	22	307	327	311	65	130	163	90	11	15	18.2	56	127	127	152	97.5	116	116	6.9
400W 1/2HP	3-10	1#	18	293	310	297	40	110	135	65	9	10	16	45	127	159	132	88.5	116	133	6.7
	15-90	2#	22	327	346	331	65	130	163	90	11	15	18.2	56	127	159	152	97.5	116	133	8.6
750W 1HP	100-200	3#	28	353	372	357	90	140	180	122	11	15	20.8	65	127	159	180	116	116	133	11
	3-25	2#	22	356	390	356	65	130	163	90	11	15	18.2	56	159	190	152	97.5	133	145	11
1500W 2HP	30-120	3#	28	382	414	382	90	140	180	122	11	15	20.8	65	159	190	180	116	133	145	14
	130-200	4#	32	417	449	417	130	170	215	160	13	25	30.2	76	159	190	210	138.5	133	145	26
2200W 3HP	4-25	3#	28	415		436	90	140	180	122	11	15	20.8	65	190	190	180	116	145		15
	30-120	4#	32	449		470	130	170	215	160	13	25	30.2	76	190		210	138.5	145		28
	130-200	5#	40	476		497	150	210	260	185	15	25	42.2	85	190		248	160	145		42
3700W 5HP	3-60	4#	32	455		481	130	170	215	160	13	25	30.2	76	190		210	138.5	153		34
	70-200	5#	40	482		508	150	210	260	185	15	25	42.2	85	217		248	160	153		47
	30-130	5#	40	498		524	150	210	260	185	15	25	42.2	85	217		248	160	153		52

備註: A1, M1, Z1為三相馬達尺寸: A3為三相帶剎車馬達尺寸

Note:A1,M1,Z1,are the sizes of three-phase motors,A3 is the size of three-phase motors with brakes

A2、M2、Z2為單相馬達尺寸

A2、M2、Z2are the sizes of single-phase motors

■尺寸表 DIMENSIONS

(8)GV立式附三相、單相鋁殼(剎車)縮框型齒輪減速馬達

GH All cinemas with single-phase three-phase, vertical aluminum shell(brake)shrink box type gear reducer motors

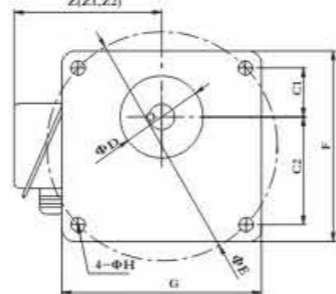
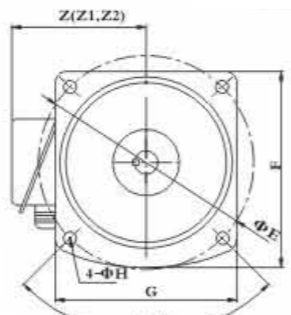
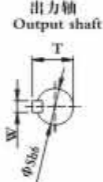
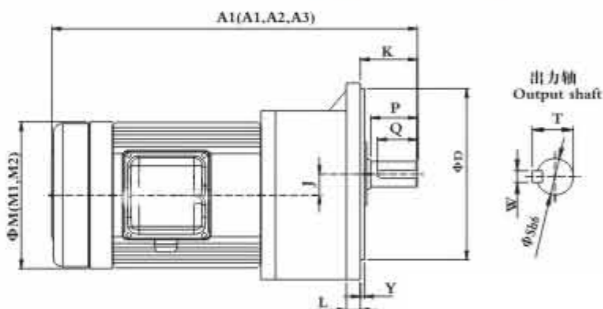

A-出力法蘭 (A-output Flange)

B-出力法蘭 (A-output Flange)

備注: 1.#本體(型號為18)C1為33.5, C2為65.5
1.#本體(型號為22)C1為40, C2為80



出力軸尺寸 OUTPUT SHAFT					
出力軸 SHAFT	鍵槽 KEYWAY			鍵 KEY	
SH6	P	W	T	Q	SPEC
Φ18	30	5	20.2	25	5*5*25
Φ22	40	7	25	35	7*7*35
Φ28	45	7	31.1	40	7*7*40
Φ32	55	10	35.5	50	10*8*50
Φ40	65	10	43.5	60	10*8*60

DIMENSIONS (M/M)

馬力 HP-4P	減速比 GEAR-RATIO	本體 CODE	型號 TYPE	A1	A2	A3	D	E	F	G	H	L	J	K	M1	M2	Y	Z1	Z2	重量 KG
100W	50-200	1#	18	253	273	257	50	140	120	120	9	12	16	38	127	127	5	116	116	5.3
200W 1/4HP	15-90	1#	*18	273	293	277	50	140	120	120	9	12	16	38	127	127	5	116	116	5.3
	100-200	2#	*22	307	327	311	55	170	156	146	11	12	18.2	49	127	127	3.5	116	116	6.9
400W 1/2HP	3-10	1#	*18	393	345	297	50	140	120	120	9	12	16	38	127	159	5	116	133	6.7
	15-90	2#	22	327	346	331	148	185	170	156	11	12	18.2	49	127	159	3.5	116	133	8.6
	15-90	2#	*22	327	346	331	55	170	146	146	11	12	18.2	49	127	127	3.5	116	133	8
750W 1HP	100-200	3#	28	353	372	357	170	220	200	190	11	15	20.8	57	127	159	4	116	133	11
	3-25	2#	22	355	395	355	148	185	170	156	11	12	18.2	49	159	190	3.5	133	145	11
	3-25	2#	*22	355	395	355	55	170	146	146	11	12	18.2	49	159	190	3.5	133	145	11
	30-120	3#	28	382	415	382	170	220	200	190	11	15	20.8	57	159	190	4	133	145	14
1500W 2HP	130-200	4#	32	417	449	417	185	255	240	225	13	17	30.2	67	159	190	4	133	145	26
	4-25	3#	28	415		436	170	220	200	190	11	15	20.8	57	190		4	145		15
2200W 3HP	30-120	4#	32	449		470	185	255	240	225	13	17	30.2	67	190		4	145		28
	130-200	5#	40	476		497	230	310	300	275	15	20	42.2	79	190		5	145		42
3700W 5HP	70-200	5#	40	482		508	230	310	300	275	15	20	42.2	79	217		5	153		47
	3-60	4#	32	455		481	185	255	240	225	13	17	30.2	67	190		4	153		34
3700W 5HP	70-200	5#	40	482		508	230	310	300	275	15	20	42.2	79	217		5	153		47
	30-130	5#	40	498		524	230	310	300	275	15	20	42.2	79	217		5	153		52

備注: A1、M1、Z1為三相馬達尺寸; A3為三相帶剎車馬達尺寸

Note: A1, M1, Z1 are the sizes of three-phase motors, A3 is the size of three-phase motors with brakes

A2、M2、Z2為單相馬達尺寸

A2、M2、Z2 are the sizes of single-phase

屬於B型號出力法蘭 BELONG TO B TYPE OUTPUT FLANGE

■尺寸表 DIMENSIONS

(9)GH臥式高速比附三相、單相鋁殼(剎車)縮框型齒輪減速馬達

GH horizontal high-speed opponent single-phase three-phase, aluminum shell(brake)shrink box type gear reducer motors

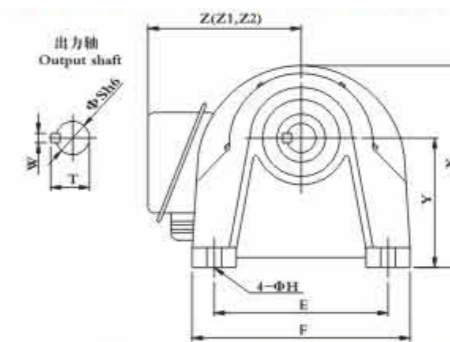
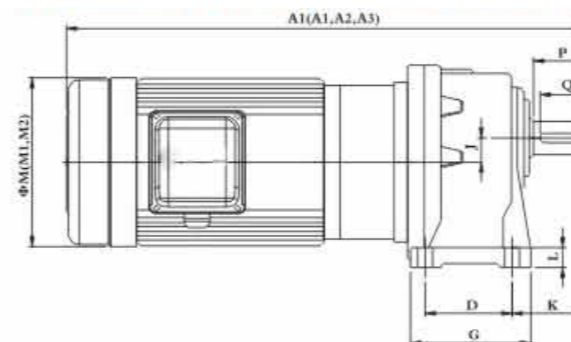

備注: A1、M1、Z1為三相馬達尺寸; A3為三相帶剎車馬達尺寸

Note: A1, M1, Z1 are the sizes of three-phase motors, A3 is the size of three-phase motors with brakes

A2、M2、Z2為單相馬達尺寸

A2、M2、Z2 are the sizes of single-phase motors

出力軸尺寸 OUTPUT SHAFT					
出力軸 SHAFT	鍵槽 KEYWAY			鍵 KEY	
SH6	P	W	T	Q	SPEC
Φ22	40	7	25	35	7*7*35
Φ28	45	7	31.1	40	7*7*40
Φ32	55	10	35.5	50	10*8*50
Φ40	65	10	43.5	60	10*8*60

DIMENSIONS (M/M)

馬力 HP-4P	減速比 GEAR RATIO	本體 CODE	型號 TYPE	A1	A2	A3	D	E	F	G	H	L	J	K	M1	M2	X	Y	Z1	Z2	重量 KG
100W 1/8HP	250-1800	1#+2#	22	365	385	369	65	130	163	90	11	15	18.2	56	127	127	152	97.5	116	116	13.2
200W 1/4HP	250-1800	2#+3#	28	410	430	414	90	140	180	122	11	15	20.8	65	127	127	180	116	116	116	29.6
400W 1/2HP	250-1800	2#+4#	32	491	510	495	130	170	215	160	13	25	30.2	76	127	159	210	138.5	116	133	49
750W 1HP	250-1800	3#+5#	40	561	594	561	150	210	260	185	15	25	42.2	85	159	190	248	160	133	145	59

(10)GV立式高速比附三相、單相鋁殼(剎車)縮框型齒輪減速馬達

GH All cinemas vertical high-speed opponent single-phase three-phase, aluminum shell(brake)shrink box type gear reducer motors

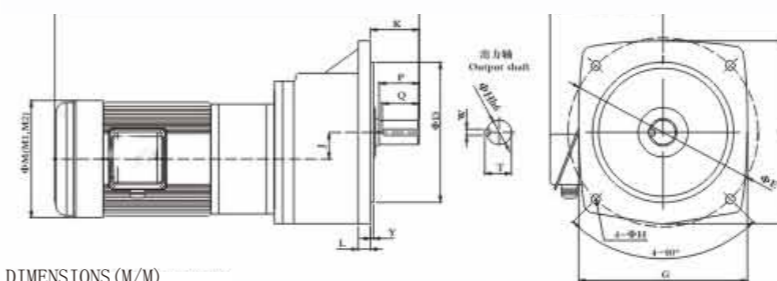

出力軸尺寸 OUTPUT SHAFT					
出力軸 SHAFT	鍵槽 KEYWAY			鍵 KEY	
SH6	P	W	T	Q	SPEC
Φ22	40	7	25	35	7*7*35
Φ28	45	7	31.1	40	7*7*40
Φ32	55	10	35.5	50	10*8*50
Φ40	65	10	43.5	60	10*8*60

DIMENSIONS (M/M)

馬力 HP-4P	減速比 GEAR RATIO	本體 CODE	型號 TYPE	A1	A2	A3	D	E	F	G	H	L	J	K	M1	M2	Y	Z1	Z2	重量 KG
100W 1/8HP	250-1800	1#+3#	22	364	384	368	148	185	170	156	11	12	18.2	49	127	127	3.5	116	116	13.2
200W 1/4HP	250-1800	2#+4#	28	410	430	414	170	220	200	190	11	15	20.8	57	127	127	4	116	116	29.6
400W 1/2HP	250-1800	3#+5#	32	491	510	495	185	255	240	225	13	17	30.2	67	127	159	4	116	133	49
750W 1HP	250-1800	3#+6#	40	561	594	561	230	310	300	275	15	20	42.2	79	159	190	4	133	145	59

備注: A1、M1、Z1為三相馬達尺寸; A3為三相帶剎車馬達尺寸

Note: A1, M1, Z1 are the sizes of three-phase motors, A3 is the size of three-phase motors with brakes

A2、M2、Z2為單相馬達尺寸

A2、M2、Z2 are the sizes of single-phase motors

■ 尺寸表
DIMENSIONS

(11) GHM 臥式直接型齒輪減速機
GHM horizontal straight type gear

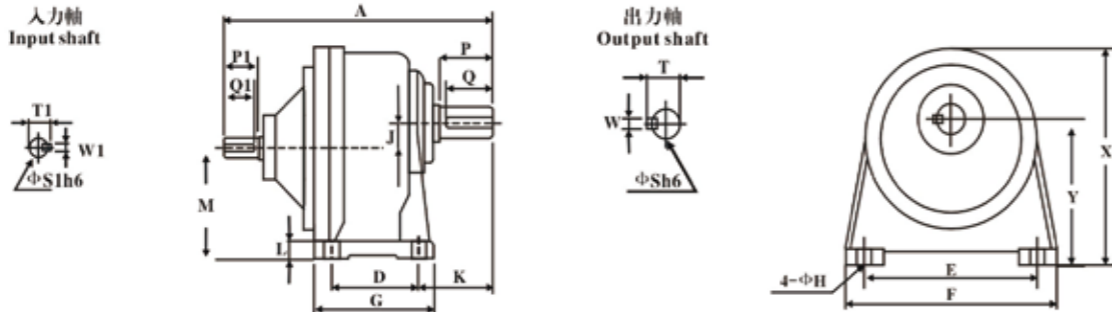

入力軸尺寸 INPUT BORE				出力軸尺寸 OUTPUT SHAFT							
馬力 KW	出力軸 SHAFT		鍵槽 KEYWAY		出力軸 SHAFT			鍵槽 KEYWAY			鍵 KEY
	S1	W1	SH6	P	W	T	Q	SPEC			
1/4HP	Φ11	4	12.5	Φ18	30	5	20.2	25	5*5*25		
1/2HP	Φ14	5	16.3	Φ22	40	7	25	35	7*7*35		
1HP	Φ19	6	21.8	Φ28	45	7	31.1	40	7*7*40		
2HP	Φ24	8	27.3	Φ32	55	10	35.5	50	10*8*50		
3HP	Φ28	8	31.3	Φ40	65	10	43.5	60	10*8*60		
5HP	Φ28	8	31.3	Φ50	80	14	54	75	14*9*75		

DIMENSIONS (M/M)

馬力 KW	減速比 GEAR-RATIO	型號 TYPE	A	B	C	D	E	F	G	H	I	J	K	L	N	X	Y	Z	重量 KG
200W 1/4HP	3-10	18	153	110	130	40	110	135	65	9	52.5	16	45	10	158	132	88.8	M8	4
	15-90	22	188	110	130	65	130	159	90	11	52.5	18.5	56	15	158	152	97.5	M8	6
	100-200	28	216	110	130	90	140	180	122	11	52.5	20.8	65	15	158	180	116	M8	8
400W 1/2HP	3-10	22	188	110	130	65	130	160	90	11	52.5	18.2	56	15	158	152	97.5	M8	6
	15-90	28	216	110	130	90	140	180	122	11	52.5	20.8	65	15	158	180	116	M8	8
	100-200	32	250	110	130	130	170	215	160	13	52.5	30.2	76	25	158	210	138.5	M8	21
750W 1HP	3-25	28	237	130	165	90	140	180	122	11	78	20.8	66	15	198	180	116	M10	11
	30-120	32	275	130	165	130	170	215	160	13	78	30.2	76	25	198	210	138.5	M10	26
	125-200	40	300	130	165	150	210	260	185	15	78	42.2	85	25	198	248	160	M10	38
1500W 2HP	3-25	32	275	130	165	130	170	215	160	13	78	30.2	76	25	198	210	138.5	M10	26
	30-120	40	300	130	165	150	210	260	185	15	78	42.2	85	25	198	248	160	M10	39
2200W 3HP	3-60	40	320	180	215	150	210	260	185	15	95	42.2	85	25	250	248	160	M12	40
	70-120	50	360	180	215	170	265	330	220	18	95	51.7	104	30	250	315	200	M12	45
3700W 5HP	3-25	40	320	180	215	150	210	260	185	15	95	42.2	85	25	250	248	160	M12	50
	30-80	50	360	180	215	170	265	330	220	18	95	51.7	104	30	250	315	200	M12	55

備注：配合IEG馬達為主，AVAILABLE FOR IEC METRIC MOTOR

■ 尺寸表
DIMENSIONS

(12) GVM 立式直接型齒輪減速機
GVM vertical straight type gear

備注：1.#本體(型號為18) C1為33.5, C2為65.5
1.#本體(型號為22) C1為40, C2為80

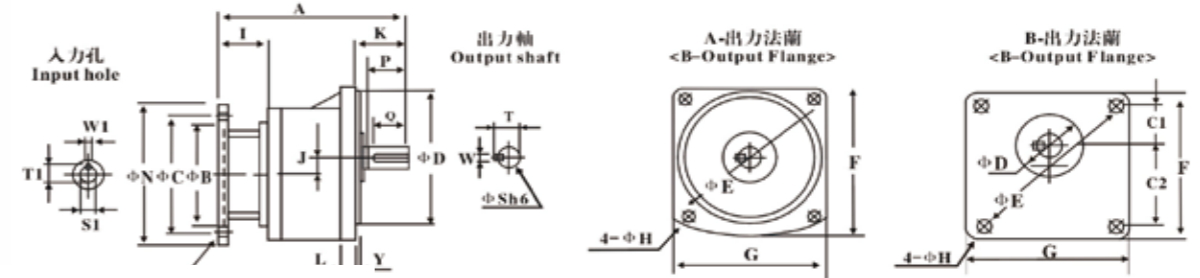

入力軸尺寸 INPUT BORE				出力軸尺寸 OUTPUT SHAFT							
馬力 KW	出力軸 SHAFT		鍵槽 KEYWAY		出力軸 SHAFT			鍵槽 KEYWAY			鍵 KEY
	S1	W1	SH6	P	W	T	Q	SPEC			
1/4HP	Φ11	4	12.5	Φ18	30	5	20.2	25	5*5*25		
1/2HP	Φ14	5	16.3	Φ22	40	7	25	35	7*7*35		
1HP	Φ19	6	21.8	Φ28	45	7	31.1	40	7*7*40		
2HP	Φ24	8	27.3	Φ32	55	10	35.5	50	10*8*50		
3HP	Φ28	8	31.3	Φ40	65	10	43.5	60	10*8*60		
5HP	Φ28	8	31.3	Φ50	80	14	54	75	14*9*75		

DIMENSIONS (M/M)

馬力 KW	減速比 GEAR-RATIO	型號 TYPE	A	B	C	D	E	F	G	H	I	J	K	L	N	Y	Z	重量 KG
200W 1/4HP	3-10	*18	153	110	130	50	140	120	120	9	52.5	16	38	12	158	5	M8	4
	15-90	22	188	110	130	148	185	170	156	11	52.5	18.2	49	12	158	3.5	M8	6
	15-90	*22	188	110	130	55	170	146	146	11	52.5	18.2	49	12	158	3.5	M8	6
	100-200	28	216	110	130	170	220	200	190	11	52.5	20.8	57	15	158	4	M8	8
400W 1/2HP	3-10	22	188	110	130	148	185	170	156	11	52.5	18.2	49	12	158	3.5	M8	6
	3-10	*22	188	110	130	55	170	146	146	11	52.5	18.2	49	12	158	3.5	M8	6
	15-90	28	216	110	130	170	220	200	190	11	52.5	20.8	57	15	158	4	M8	8
750W 1HP	100-200	32	250	110	130	185	255	240	225	13	52.5	30.2	67	17	158	4	M8	21
	3-25	28	237	130	165	170	220	200	190	11	78	20.8	57	15	198	4	M10	11
	30-120	32	275	130	165	185	255	240	225	13	78	30.2	67	17	198	5	M10	26
1500W 2HP	125-200	40	300	130	165	230	310	300	275	15	78	42.2	79	20	198	4	M10	38
	3-25	32	275	130	165	185	255	240	225	13	78	30.2	67	17	198	5	M10	26
	30-120	40	300	130	165	230	310	300	275	15	95	42.2	79	20	198	5	M10	39
2200W 3HP	3-60	40	320	180	215	230	310	300	275	15	95	42.2	79	20	250	5	M12	39
	70-120	50	360	180	215	280	390	360	330	19	95	51.7	90	20	250	5	M12	44
3700W 5HP	3-25	40	320	180	215	230	310	300	275	15	95	42.2	79	20	250	5	M12	55
	30-80	50	360	180	215	280	390	360	330	19	95	51.7	90	20	250	5	M12	60

備注：1.配合IEC馬達為主，AVAILABLE FOR IEC METRIC MOTOR
2.*屬於B型號出力法蘭*BELONG TO B TYPE OUTPUT FLANGE

定速電機

調速電機

定速電磁制動電機

調速電磁制動電機

中型齒輪減速電機

行星減速機

鋁合金刀減速機

■ 尺寸表
DIMENSIONS

(5)GHD臥式雙軸型齒輪減速馬達
GHD horizontal type dual axle gear

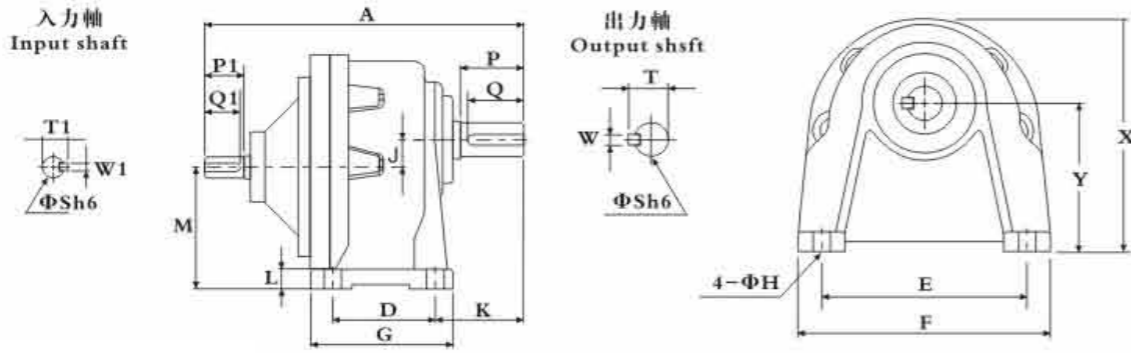

入力軸尺寸 INPUT BORE							出力軸尺寸 OUTPUT SHAFT					
入力軸 SHAFT			鍵槽 KEY WAY				鍵 KEY					
KW	Sh6	P1	W1	T1	Q1	SEPC	SH6	P	W	T	Q	SEPC
0.1/0.2	14	25	5	16.2	22	5*5*22	Φ18	30	5	20.2	25	5*5*22
0.4	14	30	5	16.2	25	5*5*22	Φ22	40	7	25	35	7*7*35
0.75	19	40	6	21.7	35	6*6*35	Φ28	45	7	31.1	40	7*7*40
1.5	24	50	8	27.1	45	8*7*45	Φ32	55	10	35.5	50	10*8*50
2.2	28	55	8	31.1	50	8*7*50	Φ40	65	10	43.5	60	10*8*60
3.7	28	55	8	31.1	50	8*7*50	Φ50	80	14	54	75	14*9*75

DIMENSIONS (M/M)

馬力 KW	減速比 GEAR-RATIO	型號 TYPE	A	D	E	F	G	H	J	K	L	M	X	Y	重量 KG
100W 1/4HP	3-50	18	168	40	110	135	65	9	16	45	10	72.5	132	88.8	3
	60-200	22	200	65	130	160	90	11	18.2	56	15	80	152	97.5	4
200W 1/2HP	3-10	18	168	40	110	135	65	9	16	45	10	72.5	132	88.5	3
	15-90	22	200	65	130	160	90	11	18.2	56	15	80	152	97.5	5
400W 1/2HP	100-200	28	258	90	140	180	120	11	20.8	65	15	95.2	180	116	7
	3-10	22	207	65	130	160	90	11	18.2	56	15	80	152	97.5	6
750W 1HP	15-90	28	263	90	140	180	120	11	20.8	65	15	95.2	180	116	7
	3-25	28	269	90	140	180	120	11	20.8	65	15	95.2	180	116	7
1500W 2HP	30-120	32	310	130	170	215	160	13	30.2	76	25	108.5	210	138.5	19
	3-25	32	320	130	170	215	160	13	30.2	76	25	108.5	210	138.5	21
3700W 5HP	125-200	40	336	150	210	260	185	15	42.2	85	25	117.8	248	160	35
	3-25	40	360	150	210	260	185	15	42.2	85	25	117.8	248	160	35
3700W 5HP	3-60	40	360	150	210	260	185	15	42.2	85	25	117.8	248	160	35
	70-120	50	410	170	265	330	220	19	51.7	104	30	148.6	315	200	43
	30-80	50	410	170	265	330	220	19	51.7	104	30	148.6	315	200	43

■ 尺寸表
DIMENSIONS

(5)GVD立式雙軸型齒輪減速馬達
GVD (gnu visual debugger) biaxial vertical
vertical type gear

備注: 1.#本體(型號為18) C1為33.5, C2為65.5
1.#本體(型號為22) C1為40, C2為80

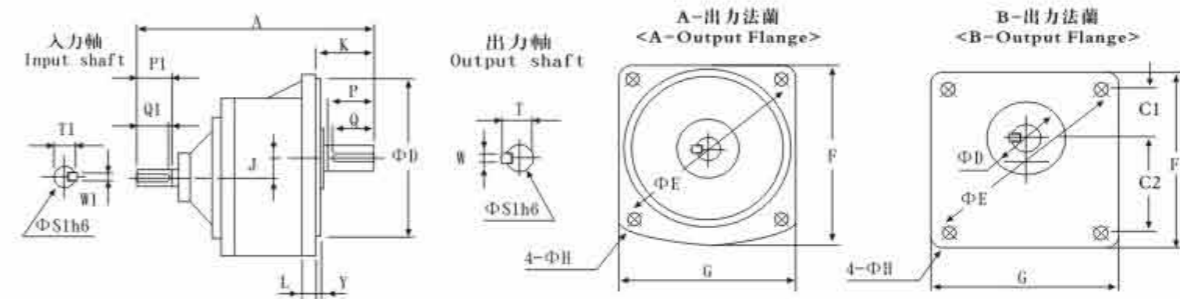

入力軸尺寸 INPUT BORE							出力軸尺寸 OUTPUT SHAFT					
入力軸 SHAFT			鍵槽 KEY WAY				鍵 KEY					
KW	Sh6	P1	W1	T1	Q1	SEPC	SH6	P	W	T	Q	SEPC
0.1/0.2	14	25	5	16.2	22	5*5*22	Φ18	30	5	20.2	25	5*5*22
0.4	14	30	5	16.2	25	5*5*22	Φ22	40	7	25	35	7*7*35
0.75	19	40	6	21.7	35	6*6*35	Φ28	45	7	31.1	40	7*7*40
1.5	24	50	8	27.1	45	8*7*45	Φ32	55	10	35.5	50	10*8*50
2.2	28	55	8	31.1	50	8*7*50	Φ40	65	10	43.5	60	10*8*60
3.7	28	55	8	31.1	50	8*7*50	Φ50	80	14	54	75	14*9*75

DIMENSIONS(M/M)

馬力 KW	減速比 GEAR-RATIO	型號 TYPE	A	D	E	F	G	H	J	K	L	Y	重量 KG
100W 1/8HP	3-50	18	168	50	140	120	120	9	16	38	12	5	3
	60-200	22	200	148	185	170	156	11	18.2	49	12	3.5	4
	60-200	22	200	55	170	146	146	11	18.2	49	12	3.5	4
200W 1/4HP	3-10	18	168	50	140	120	120	9	16	38	12	5	3
	15-90	22	200	148	185	170	156	11	18.2	49	12	3.5	5
	100-200	28	258	170	220	195	180	11	20.8	57	15	4	7
400W 1/2HP	3-10	22	207	148	185	170	156	11	18.2	49	12	3.5	6
	3-10	22	200	55	170	146	146	11	18.2	49	12	3.5	4
	15-90	28	263	170	220	195	180	11	20.8	57	15	4	7
750W 1HP	100-200	32	300	185	255	240	225	13	30.2	67	17	4	19
	3-25	28	268	170	220	195	180	11	20.8	57	15	4	7
	30-120	32	310	185	255	240	225	13	30.2	67	17	4	21
1500W 2HP	125-200	40	336	230	310	300	275	15	20.8	79	20	5	35
	3-25	32	320	185	255	240	275	13	30.2	67	17	4	21
	30-120	40	350	230	310	300	275	15	42.2	79	20	5	35
2200W 3HP	3-60	40	360	230	310	300	275	15	30.2	79	20	5	35
	70-120	50	400	280	390	360	330	19	51.7	90	20	5	43
3700W 5HP	3-25	40	360	230	310	300	275	15	42.2	79	20	5	35
	30-80	50	400	280	390	360	330	19	51.7	90	20	5	43

備注: 1. *屬於B型出力法蘭.*BELONG TO B TYPE OUTPUT FLANGE

零件剖面圖
DETAILS PARTS LIST

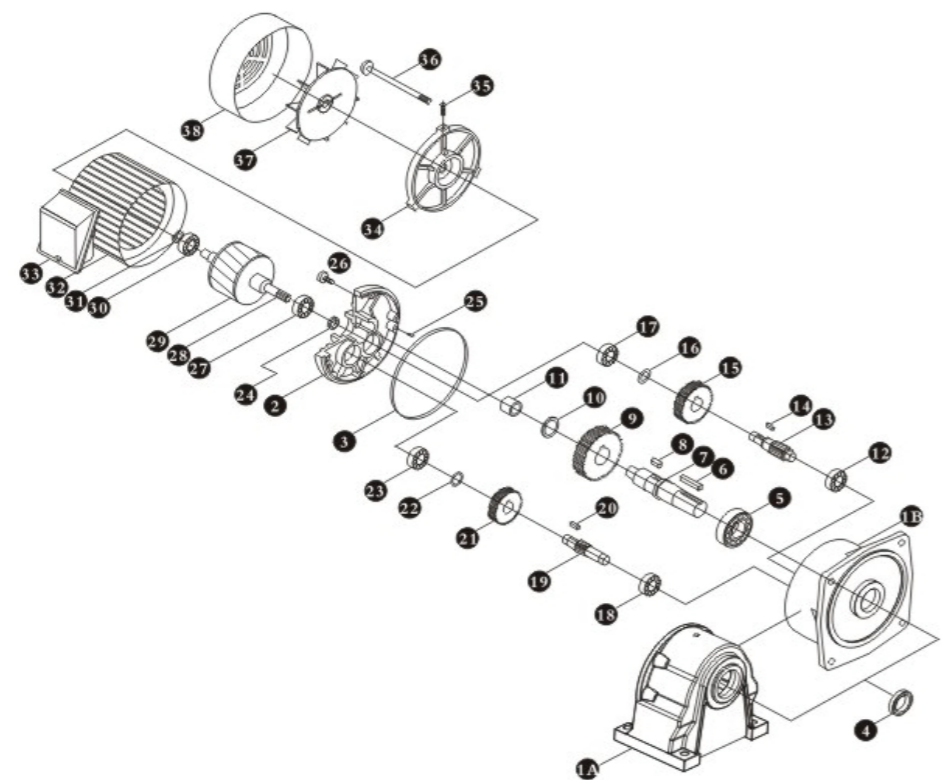

2段/3段式結構剖視圖 2 STAGES/3 STAGES SECTION DIA					
項次	零件名稱	項次	零件名稱	項次	零件名稱
1A	臥式本體 HORIZONTAL HOUSING	14	三段小齒軸鍵 KEY-3NDSTAGE PINION	28	馬達齒軸 MOTOR SHAFT
1B	立式本體 VERTICAL HOUSING	15	二段大齒輪 GEAR-2NDSTAGE	29	轉子 ROTOR
2	馬達前蓋 HOUSING COVER	16	C-扣環 O-RING	30	馬達軸培林 BEARING-MOTOR SHAFT
3	O型環 O-RING	17	三段齒軸培林 BEARING-3RDSTAGE PINION	31	波浪彈簧 WAVE SPRING
4	出力軸油封 OIL SEAL-OUTPUT SHAFT	18	二段齒軸培林 BEARING-3RDSTAGE PINION	32	繞線總成 COILASSEMBLY
5	出力軸培林 BEARING-OUTPUT SHAFT	19	二段小齒輪 POIN-2NDSTAGE	33	接線盒 WIRE BOX
6	出力軸鍵 KEY-OUTPUT SHAFT	20	二段小齒軸鍵 KEY-2RDPINION	34	馬達後蓋 REAR COVER-MOTOR
7	出力軸 OUTPUT SHAFT	21	一段大齒輪 GEAR-1NDSTAGE	35	風罩螺絲 SCREW-FAN COVER
8	3段小齒軸鍵 KEY-3RDPINION	22	C-扣環 O-RING	36	馬達螺栓 BOLT-MOTOR
9	3段大齒軸鍵 GEAR-3RDPINION	23	二段齒軸培林 BEARING-2NDSTAGE PINION	37	風葉 FAN
10	C-扣環 SNAP RING	24	入側油封 OIL SEAL-MOTOR SHAFT	38	風罩 FAN COVER-MOTOR
11	出力軸滾針軸承 THE OUTPUT SHAFT NEEDLE BEARING	25	定位銷 PIN		
12	二段齒軸培林 BEARING-2NDSTAGE PINION	26	內六角螺絲 HEX-HEAD SCREW		
13	三段小齒軸 PINION-3NDSTAGE	27	馬達軸培林 BEARING-MOTOR SHAFT		

零件剖面圖
DETAILS PARTS LIST

剎車零件分解圖 BRAKE UNIT SECTION DIAGRAM

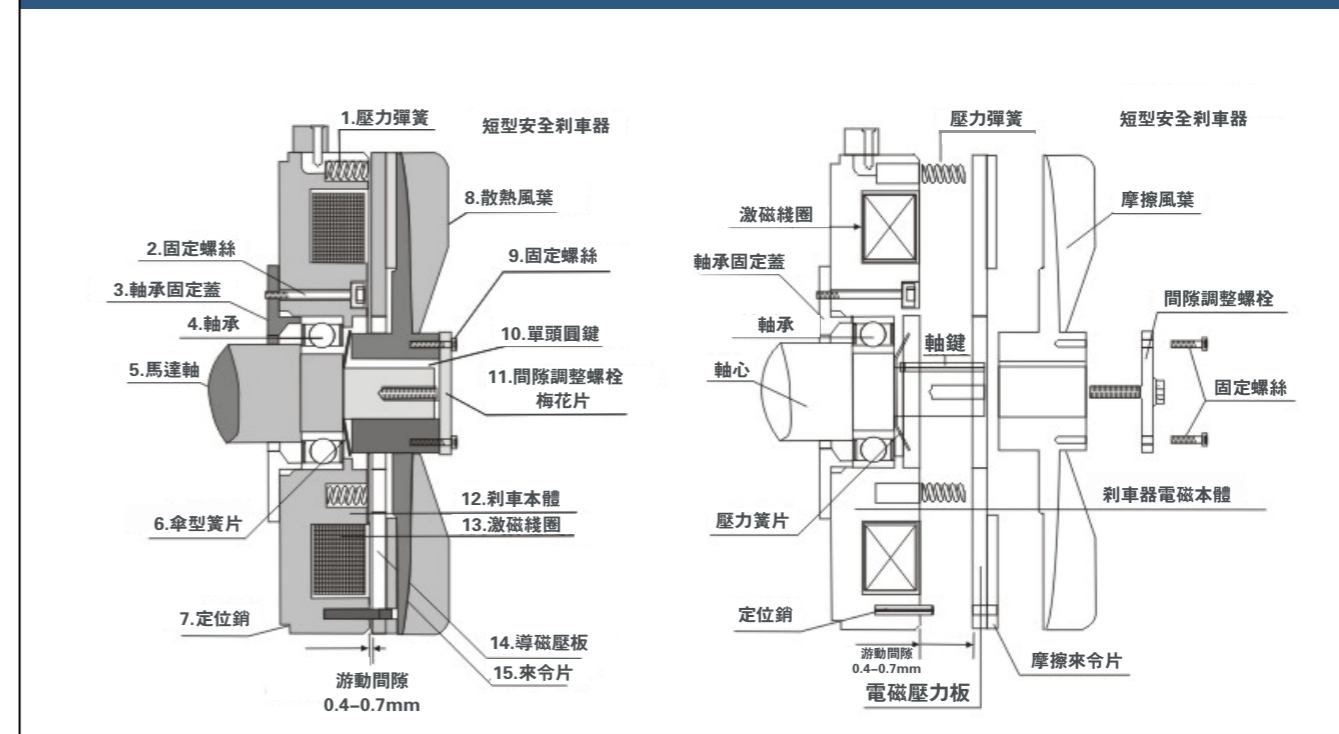

1	壓力螺絲 PRESSURE SPRING	9	固定螺絲 FIXED SCREW
2	固定螺絲 FIXED SCREW	10	固定鍵 KEY
3	軸承固定蓋 FIXED BEARING PLATE	11	調整螺栓 GAP ADJUSTMENT BOLT
4	軸承 BEARING	12	剎車本體 BRAKE HOUSING
5	馬達軸 MOTOR SHAFT	13	激磁繞圈 BRAKE COIL
6	傘型簧片 DISC SPRING	14	導磁壓板 FRICTION PLATE
7	定位銷 FIXED SHAFT	15	來令片 FRICTION BRAKE BRAKE DISC
8	散熱風葉 FAN		

剎車間隙調整 ADJUST BRAKE CLEARANCE



間隙調整螺栓正面圖
Front view of gap adjusting bolt

1. 請先移除固定螺絲
PLEASE REMOVE TWO PIECES FIXED SCREWS ADVANCE
2. 每向右調整一格，其間距縮小0.07-0.10MM
EVERY SINGLE POSITION ADJUSTMENT BRAKE CLEARANCE WILL REDUCE 0.07=0.10MM