

RoHS

MAPX

MODIFICATION

DRW

DATE

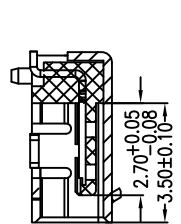
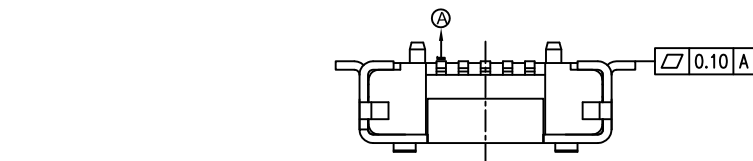

SECTION A-A'

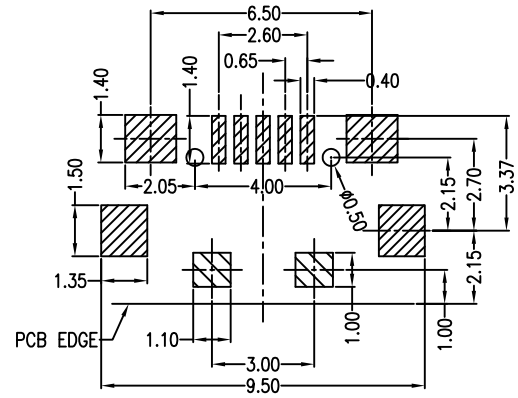
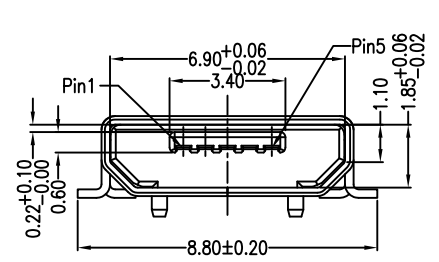
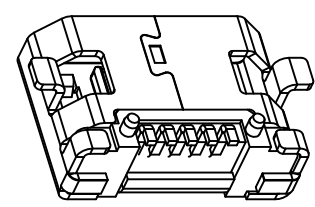
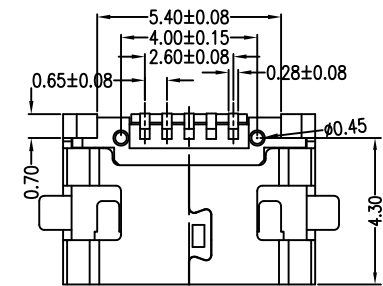
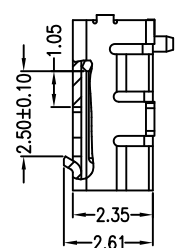
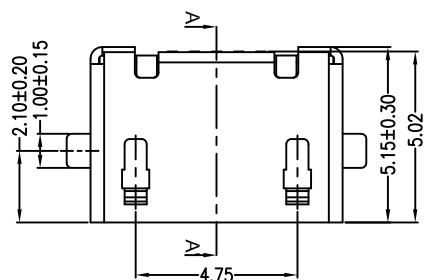

RECOMMENDED PCB LAYOUT PCB图仅供参考

- Note:
- Material:
 - Housing: High temperature thermoplastic with g.f,UL94v-0
 - Contact: copper alloy,t=0.20mm
 - Shell: copper alloy,t=0.25mm
 - Specification:
 - Current rating:1,5PIN 1.8A Max/2,3,4PIN 1A Max.
 - Dielectric withstanding voltage: 100 V(ac) for 1 min.
 - Contact resistance: 30 mΩ Max.
 - Insulation resistance: 100 MΩ Min.
 - Total mating force: 3.57 Kgf Max.
 - Total unmating force: 1.0 Kgf Min
 - Temperature range: -30°C~80°C

产品图
PRODUCT CHART DWG

深圳市精拓金电子有限公司
Shenzhen Jing Tuo Jin Electronics Co., Ltd.

公差一览表
TOLERANCE UNLESS OTHERWISE

X.	±0.35	X.	±5°
.X	±0.20	.X	±2°
.XX	±0.10	.XX	±1°
.XXX	±0.05	.XXX	±0.5°

单位 UNITS	MM	制图 DRAWING	许榕强	制图料号 PRODUCT PART NO.	920-D62A2021S10107
比例 SCALE	1:1	审核 CHKD	郭治富	产品名称 PRODUCT NO.	MICRO 5S/B型四脚全贴无导线有柱外焊 脚长8.7LCP黑胶短端
日期 DATE	2016-09-09	核准 APPD	黄国荣	角法 VIEW	版本 VER

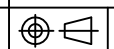

版本
VER

A0