

目錄 MAPX	设变内容 MODIFICATION	日期 DATE

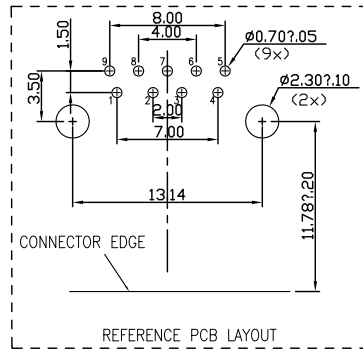
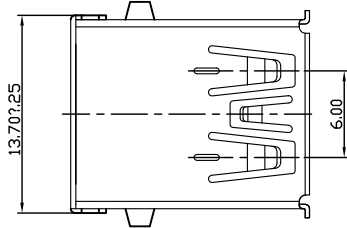
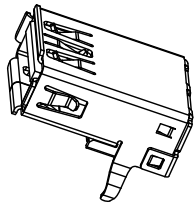

SPECIFICATIONS:

Contact current Rating:
1.8 Amperes for pin1&pin4.
0.25 Amperes other contacts

Dielectric Withstanding Voltage:AC 100V(RMS)
Insulation resistance:100Megohms Minimum.
Contact Resistance:
30mΩ Max for pin1&pin4
50mΩMax for other contacts

Mechanical Characteristics:
Mating Force:35 Newtons.Maximum
Unmating Force:10 Newtons.Minimum.

MATERIAL: 8N Min After Durability
Housing: PBT+30%GF 94V-0 COLOR:BLUE
Contact: copper alloy(T=0.25mm)
Shell: Brass

PLATING:
Contact: Au Plated on contact area
Tin Plated on solder area
Nickel underplating over all
Shell: Nickel Plated
operating Temperature: -55℃to+85°

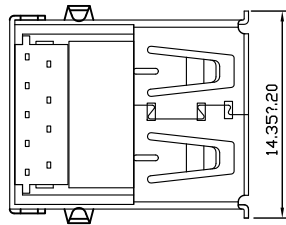
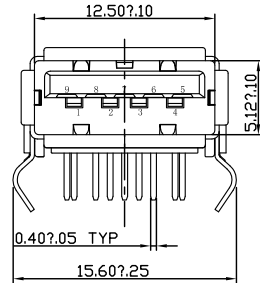
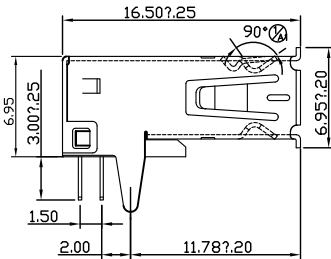
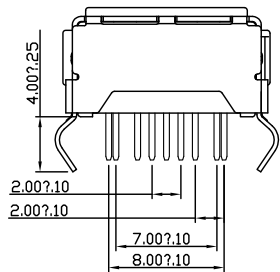

产品图 PRODUCT CHART DWG		深圳市精拓金电子有限公司						
公差一览表 TOLERANCE UNLESS OTHERWISE		单位 UNITS	MM	制图 DRAWING	徐榕强	产品料号 PRODUCT PART NO.	901-112A105AD10100	
X.	±0.25	X'	±5°	比例 SCALE	审核 CHKD	产品名称 PRODUCT NO.	AF90度3.0外扣弯脚有边内弹铜壳16.5蓝胶	
.X	±0.20	.X'	±2°					
.XX	±0.15	.XX'	±1°	日期 DATE	2009/10/20	核准 APPD	黄国荣	
.XXX	±0.10	.XXX'	±0.5°	角法 VIEW			版本 VER	A0