

## Through-beam sensor transmitter

O6S-00KG/AS/4P

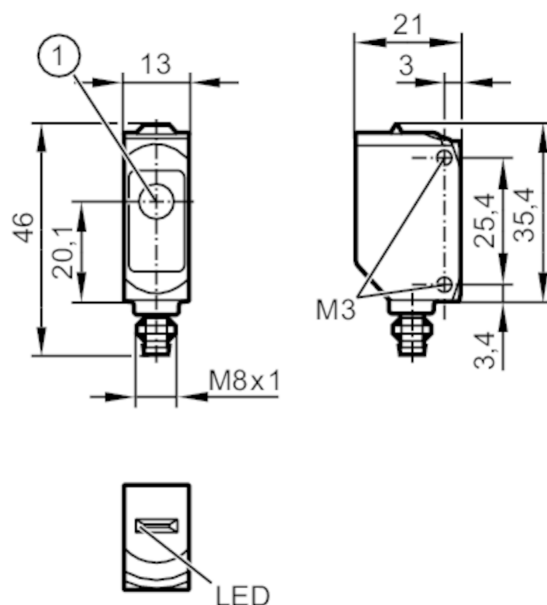

1: light emission



## Product characteristics

Type of light	red light
Housing	rectangular
Dimensions [mm]	35.4 x 13 x 21

## Application

Function principle	Through-beam sensor
--------------------	---------------------

## Electrical data

Operating voltage [V]	10...30 DC
Current consumption [mA]	11; ((24 V))
Protection class	III
Type of light	red light
Wave length [nm]	633

## Detection zone

Transmitter / receiver	transmitter
Range [m]	< 10
Max. light spot diameter [mm]	300
Light spot dimensions refer to	at maximum range

## Operating conditions

Ambient temperature [°C]	-25...60
Protection	IP 65; IP 67



## Through-beam sensor transmitter

O6S-00KG/AS/4P

Tests / approvals		
EMC	EN 60947-5-2	
MTTF [years]	2600	
UL approval	UL Approval no.	E002

Mechanical data		
Weight [g]	17.6	
Housing	rectangular	
Dimensions [mm]	35.4 x 13 x 21	
Materials	housing: ABS; PPSU	
Lens material	PMMA	
Lens alignment	side lens	
Sealing material	EPDM	
Tightening torque [Nm]	0.5	

Displays / operating elements		
Display	operation	1 x LED, green

Remarks		
Remarks	operating voltage "supply class 2" according to cULus	
Pack quantity	1 pcs.	

## Electrical connection

Connector: 1 x M8; Locking: brass, coated; Sealing: EPDM



## Connection

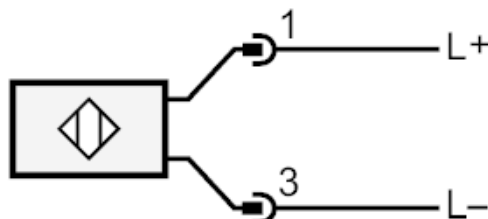



## Through-beam sensor transmitter

O6S-OOKG/AS/4P

### Diagrams and graphs

excess gain graph

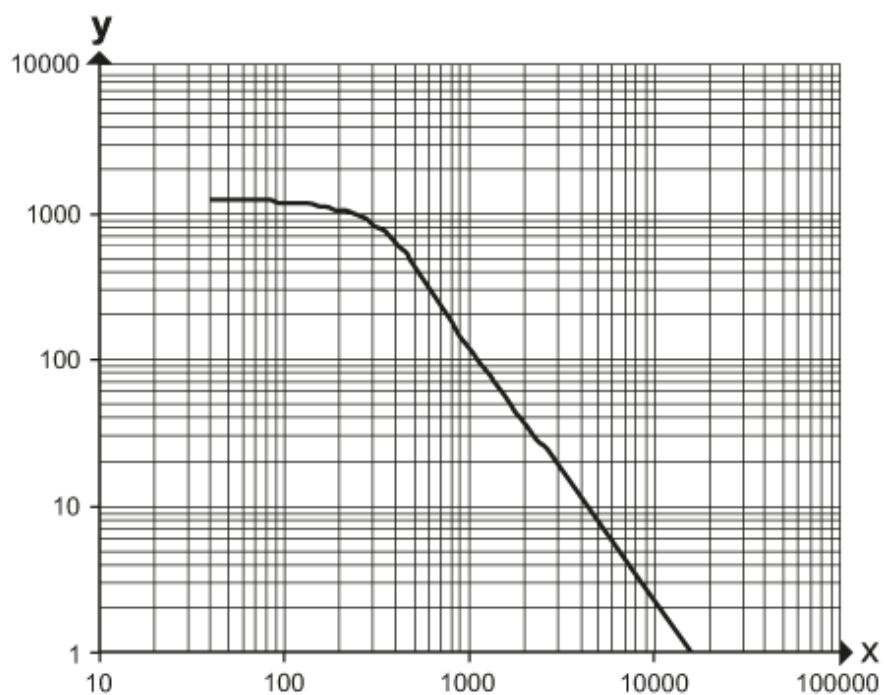

x: distance [mm]

y: excess gain factor