

客户确认
日期

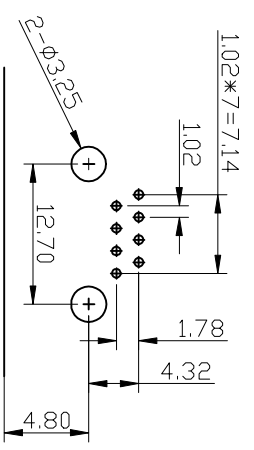
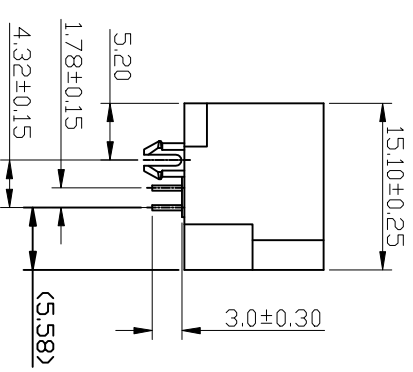
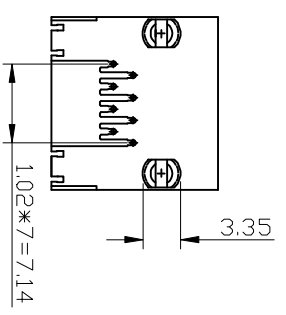
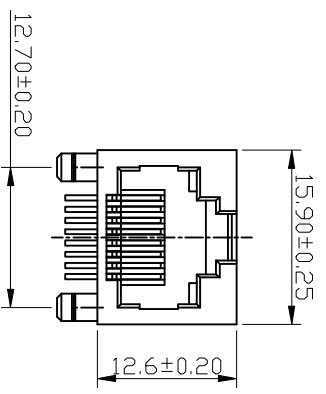

PC Board Layout
Component Side Shown

NOTES:

MATERIAL :

- 1 HOUSING MATERIAL : GLASS FILLED POLYESTER UL94V-0
- 2 CONTACT MATERIAL : PHOSPHOR BRONZE $\phi 0.46\text{mm}$
- 3 PLATING : GOLD PLATING OVER NICKEL.

ELECTRICAL:

- 1 VOLTAGE RATING : 125 VAC RMS.
- 2 CURRENT RATING : 15 AMP.
- 3 CONTACT RESISTANCE : 30 MILLIOHMS MAX.
- 4 INSULATION RESISTANCE : 500 MEGOHMS MIN @ 500V DC.
- 5 DIELECTRIC WITHSTANDING RESISTANCE : 1000V AC RMS 50Hz. MIN.

MECHANICAL:

- 1 DURABILITY : 750 CYCLES MIN.
- 2 PCB RETENTION PRE-SOLDER : 1 LB MIN.

ENVIRONMENTAL:

- 1 STORAGE : -40 $^{\circ}$ ~+85 $^{\circ}$
- 2 OPERATION : 0 $^{\circ}$ TO 70 $^{\circ}$ C.

TOLERANCE TABLE

.0	±0.30
.00	±0.20
.000	±0.05

核准:	日期:	深圳市灿科盟实业有限公司 CHANKEMENG INDUSTRYCO., LTD
业务:	日期:	
制图:	日期:	
LiLi-Liu	2015-05-20	
品名规格:		深圳市灿科盟实业有限公司 CHANKEMENG INDUSTRYCO., LTD
规格: RJ45-02/8C 全塑无铅 无灯 弯插 (2551A89-1)		
PART. NO.	R-RJ45R08P-A004	
单位	mm	比例
图纸编号	Chimtw-RJ45-0043	版本
	A	HY04