

- NOTES:
1. PARTS TO BE BULK PACKED.
  2. SOLDER CONTACTS ARE PRESSED INTO CONNECTOR.  
ALL SOLDER CUPS ARE TO BE FACING TOP KEY.
  3. ALL DIMENSIONS ARE REFERENCE ONLY  
DIMENSIONS IN BRACKETS [ ] ARE METRIC.

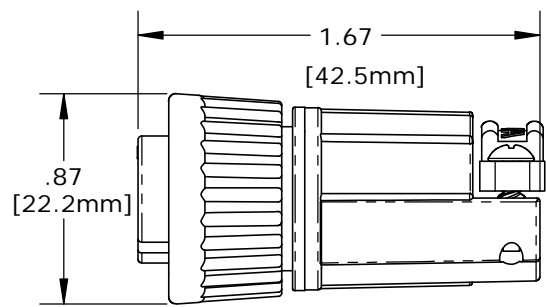

ASSEMBLED VIEW SHOWN  
WITH STANDARD COUPLING RING

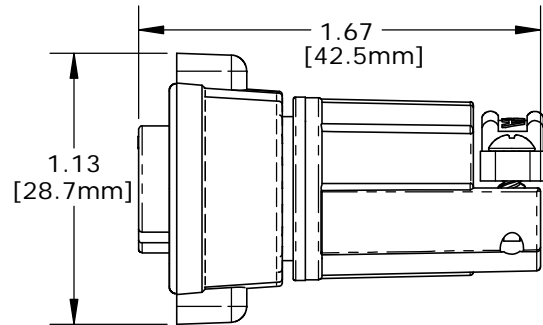

ASSEMBLED VIEW SHOWN  
WITH WINGED COUPLING RING

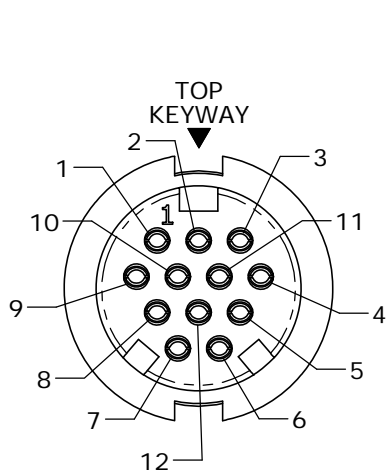

FACE VIEW  
W3282-12SG-5XX(W)

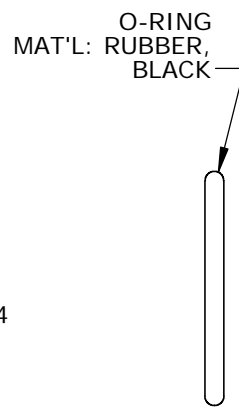

CABLE INSERT, FEMALE  
MAT'L: UV THERMOPLASTIC,  
BLACK

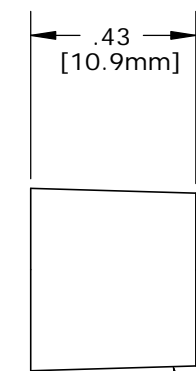
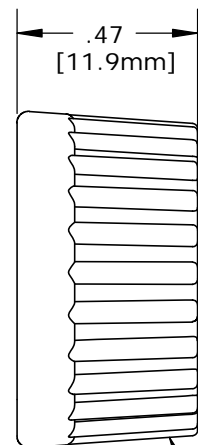
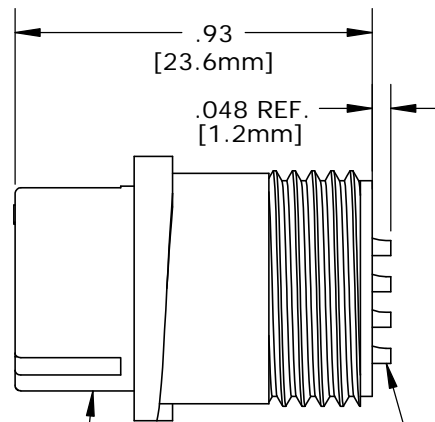

GROMMET,  
MAT'L: RUBBER,  
BLACK  
FOR CABLE O.D.  
SEE TABLE

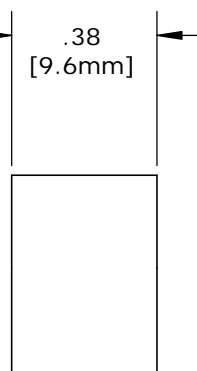

SLEEVE  
MAT'L: THERMOPLASTIC,  
BLACK

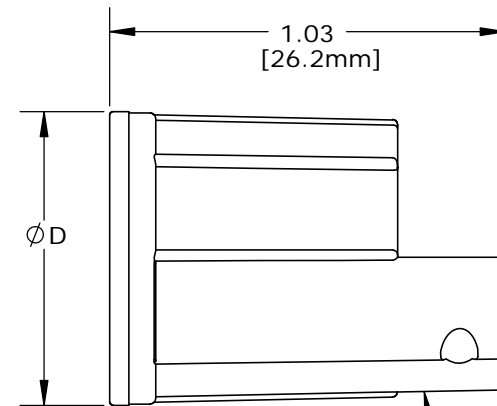

BACKSHELL  
MAT'L: UV THERMOPLASTIC,  
BLACK

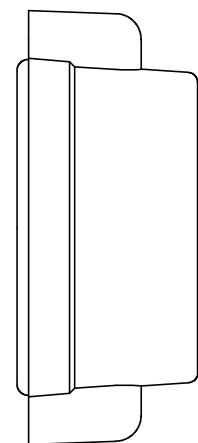

COUPLING RING, WINGED (OPTIONAL)  
MAT'L: UV THERMOPLASTIC,  
BLACK

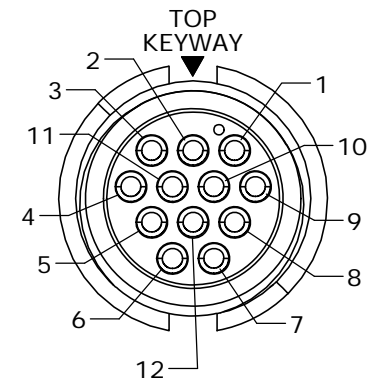

WIRE VIEW

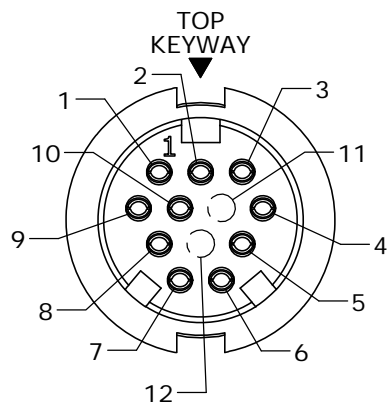

FACE VIEW  
W3282-10SG-5XX(W)

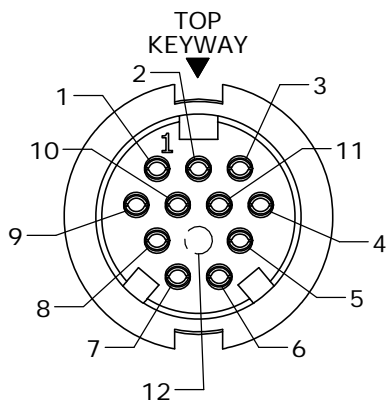

FACE VIEW  
W3282-11SG-5XX(W)

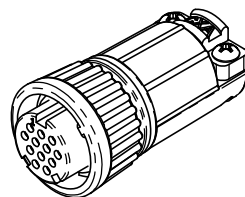

ASSEMBLED VIEW SHOWN  
WITH STANDARD  
COUPLING RING

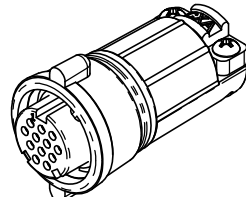

ASSEMBLED VIEW SHOWN  
WITH WINGED  
COUPLING RING

KIT PART NO.	GROMMET SIZE TO FIT CABLE O.D.	DIA. "D"
W3282-1XSG-518(W)	0.18 - 0.20 [4.6-5.1mm]	Ø0.77 [19.6mm]
W3282-1XSG-521(W)	0.21 - 0.23 [5.3-5.8mm]	Ø0.77 [19.6mm]
W3282-1XSG-524(W)	0.24 - 0.27 [6.1-6.8mm]	Ø0.77 [19.6mm]
W3282-1XSG-528(W)	0.28 - 0.29 [7.1-7.4mm]	Ø0.77 [19.6mm]
W3282-1XSG-530(W)	0.30 - 0.32 [7.6-8.1mm]	Ø0.77 [19.6mm]
W3282-1XSG-535(W)	0.35 - 0.40 [8.9-10.2mm]	Ø0.83 [21.1mm]

(WINGED COUPLING RING OPTION)  
NO. OF CONTACTS

#4 HI/LO SCREW  
MAT'L: STAINLESS STEEL

BACKSHELL STRAP  
MAT'L: UV THERMOPLASTIC,  
BLACK

KIT P/N	NO. OF CONTACTS
W3282-10SG-5XX	(10) - #20
W3282-11SG-5XX	(11) - #20
W3282-12SG-5XX	(12) - #20
W3282-10SG-5XXW	(10) - #20
W3282-11SG-5XXW	(11) - #20
W3282-12SG-5XXW	(12) - #20

ADD W SUFFIX FOR WINGED COUPLING RING  
OPTION

W3282-1XSG-5XX(W)

GROMMET SIZE  
SEE P/N LIST  
NO. OF CONTACTS

#### CUSTOMER APPROVAL

THIS DOCUMENT CONTAINS CONFIDENTIAL  
INFORMATION PROPRIETARY TO CONXALL  
CORPORATION. ANY REPRODUCTION,  
DISCLOSURE, OR USE OF THIS  
DOCUMENT /INFORMATION IS EXPRESSLY  
PROHIBITED UNLESS AUTHORIZED IN  
WRITING BY CONXALL CORPORATION.

APPROVED BY: \_\_\_\_\_

DATE: \_\_\_\_\_

A	PAK	08/15/19	DRAWING CREATED & RELEASED PER DOR 10-2523JS-1	
REV.	INIT.	DATE	DESCRIPTION	
	PAK	10/01/14	ORIG. DRAWN BY: DATE: 10/01/14	
ALL INFORMATION ILLUSTRATED IS THE PROPERTY OF "CONXALL CORPORATION". UNAUTHORIZED DUPLICATION OR DISTRIBUTION OF THIS DOCUMENT IS PROHIBITED.			CHECKED BY:	
ALL UNITS ARE IN FEET, INCHES, FRACTION OF INCHES AND DECIMALS.			APPROVED BY:	
UNLESS OTHERWISE SPECIFIED TOLERANCES: 3 PLACE DECIMALS ±.005 ANGLES ±1° FRACTIONS ±1/16			TITLE: CABLE CONNECTOR KIT #20 SOCKET CONTACTS (SOLDER), BACKSHELL CLAMP MULTI-CON-X, E-KEY, WEATHER RESISTANT STANDARD PRODUCT	
△ - CRITICAL CHARACTERISTIC FLAG PER SPEC. XXXX			SCALE NTS	SHEET 1 OF 1
			FILE: W3282-1XSG-5XX	DIRECTORY: SLW
			PART NUMBER: W3282-1XSG-5XX(W)	REV A