

# CCI-A



**APPLICATION:** Weighbridges and silos  
**CAPACITY RANGE:**  
 20t - 30t - 40t  
**MATERIAL:** Stainless Steel Housing.  
**ENVIRONMENTAL PROTECTION:** IP68  
**APPROVALS:**  
 CE 3000 Div - E.04.02.C04  
 OIML - R60/2000-ES1-13.03  
**应用:** 汽车衡和仓秤  
**称重范围:** 20t - 30t - 40t  
**材质:** 不锈钢外壳  
**保护等级:** IP68  
**认证:** CE 3000 Div - E.04.02.C04  
 OIML - R60/2000-ES1-13.03

**CHARACTERISTICS**  
 Construction using stainless steel.  
 The laser soldered closing protects from the typical environment in food and chemical industry. Mounting compatibility.  
**特征**  
 产品采用不锈钢材质，激光焊接密封技术，可以在复杂环境中应用，如工业和化工行业。拥有更多的兼容性。

**APPLICATIONS**  
 The CCI-A model is manufactured to maintain its performance capabilities in the environmental conditions existing in food industries, where tasks and cleaning demand special steel and a good environmental protection.  
**用途**  
 CCI-A 型是为适用于复杂的现场环境下制造的，在这些复杂的条件下产品都能保持良好的性能。

**OPTIONS**  
 Consult for special requirements.  
**可选项**  
 特殊要求可咨询。

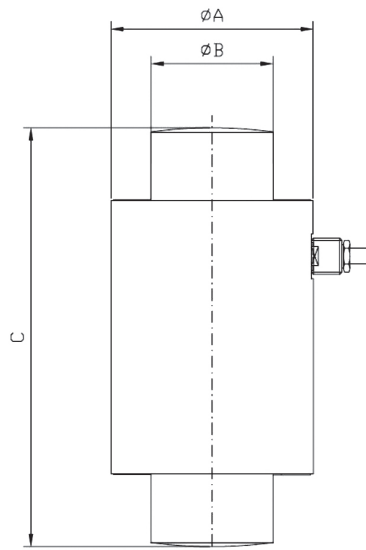

TEFLÓN® protects all the internal cables  
 特氟龙® 保护所有内部电缆

Capacity	A	B	C
20-40 T	73	44	150

Dimensions in mm 尺寸为毫米

