

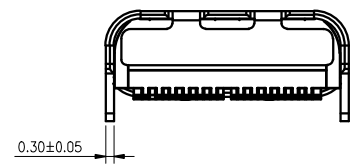

REV.	ECN NO OR DESCRIPTION	REVISED	DATE

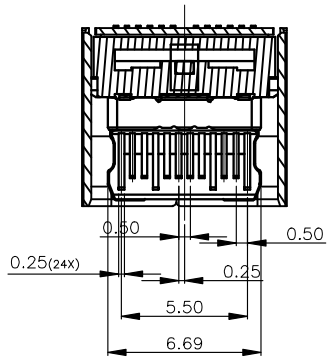

- 1-1.HOUSING: LCP UL94 V-0 BLACK.
- 1-2.CONTACTS: C7025-TM02/C18400-R540 T=0.15mm
- 1-3.EMI SPRING: SUS304-1/2H T=0.10mm
- 1-4.FRONT SHELL: SUS304-1/2H T=0.3mm
- 1-5.MIDDLE BLADE: SUS304-H T=0.15
- 2.PLATING SPECIFICATION:
- 2-1.CONTACTS:
Ni 30u" MIN. UNDER PLATED OVER ALL.
1-30u" Au PLATED ON THE FUNCTIONAL AREA OF CONTACT.
Au GOLD FLASH PLATED ON SOLDER AREA.
- 2-2.EMI SPRING:
CLEANING ONLY
- 2-3.FRONT SHELL:
Ni 50u" MIN. UNDER PLATED OVER ALL.
- 2-4.MIDDLE BLADE:
Ni 50u" MIN. UNDER PLATED OVER ALL.
Au G/F" Min PLATED ON SOLDER AREA.
- 3.MECHANICAL PERFORMANCE:
- 3-1.INSERTION FORCE: 5~20N
- 3-2.REMOVAL FORCE: 8~20N FROM 1 TO 1000 CYCLES
6~20N FROM 1001 TO 10000 CYCLES
- 3-3.DURABILITY: 10000 CYCLES.
- 4.ELECTRICAL PERFORMANCE:
- 4-1. CURRENT RATING: 5.0A FOR VBUS PINS (Pin A4,A9,B4,B9)
1.25A FOR GND PINS (PIN A1,A12,B1,B12)
0.25A FOR OTHER PINS (PIN A1,A12,B1,B12)

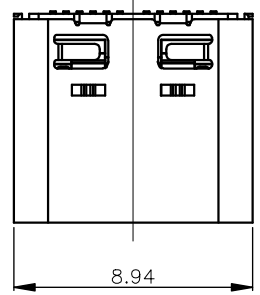
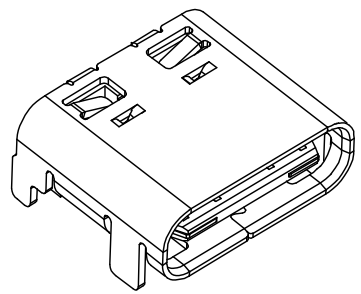
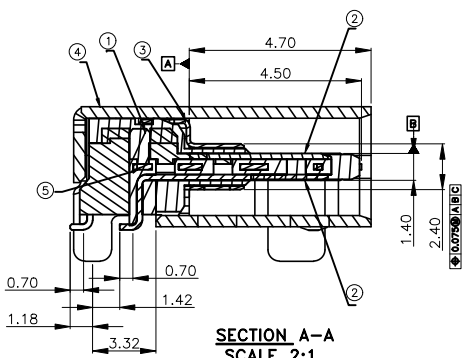
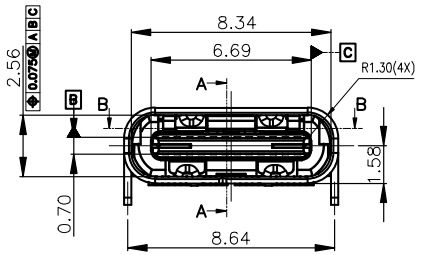

- 4-2. LLCR:
VBUS & GND PINS AND OTHER PINS: 40mA/PIN MAX.
SHIELD: 50mA/MAX.
LLCR MAX. CHANGE OF ALL PINS: 10mA
- 4-3.INSULATION RESISTANCE: 100MΩ MIN.
- 4-4.DIELECTRIC WITHSTAND VOLTAGE,AC 100V FOR 1 MINUTE.
- 5. ENVIRONMENTAL PERFORMANCE:
OPERATING TEMPERATURE: -30°C~+85°C.
- 6.IR REFLOW:
THE PEAK TEMPERATURE ON THE BOARD SHALL BE MAINTAINED FOR 10 SECONDS AT 260°C.

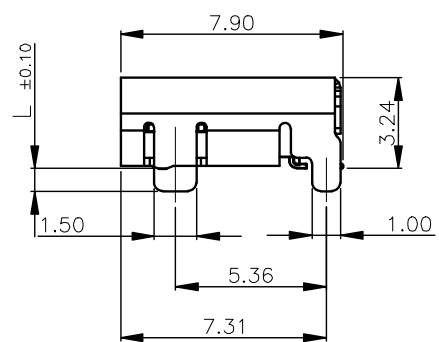
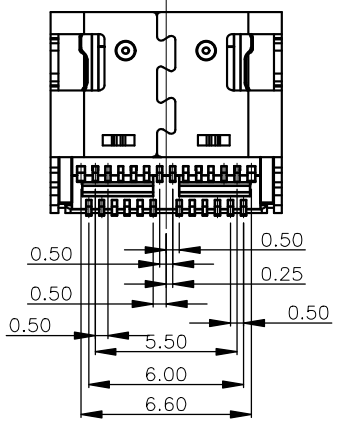

PIN ASSIGNMENT											
A1	A2	A3	A4	A5	A6	A7	A8	A9	A10	A11	A12
GND	TX1+	TX1-	VBUS	CC1	D+	D-	SBU1	VBUS	RX2-	RX2+	GND
GND	RX1+	RX1-	VBUS	SBU2	D-	D+	CC2	VBUS	TX2-	TX2+	GND
B12	B11	B10	B9	B8	B7	B6	B5	B4	B3	B2	B1

UNLESS OTHERWISE SPECIFIED TOLERANCES

DECIMALS: ANGLES:

X :±0.35 X :±2°

X.X :±0.25 X.X :±1°

X.XX :±0.15

东莞市汉博电子科技有限公司
DONGGUAN HANBO TECHNOLOGY CO., LTD

TITLE: TYPE C 母座双排贴片 24PIN四脚DIP L=7.9mm 贴片款

DWN xiong PART NO. MC-222D

CHKD lee SCALE:1:1 UNIT: mm

APVD wang SIZE: A4 SHEET:1OF 1 REV: A4

CUSTOMER COPY



REV.	ECN NO OR DESCRIPTION	REVISED	DATE

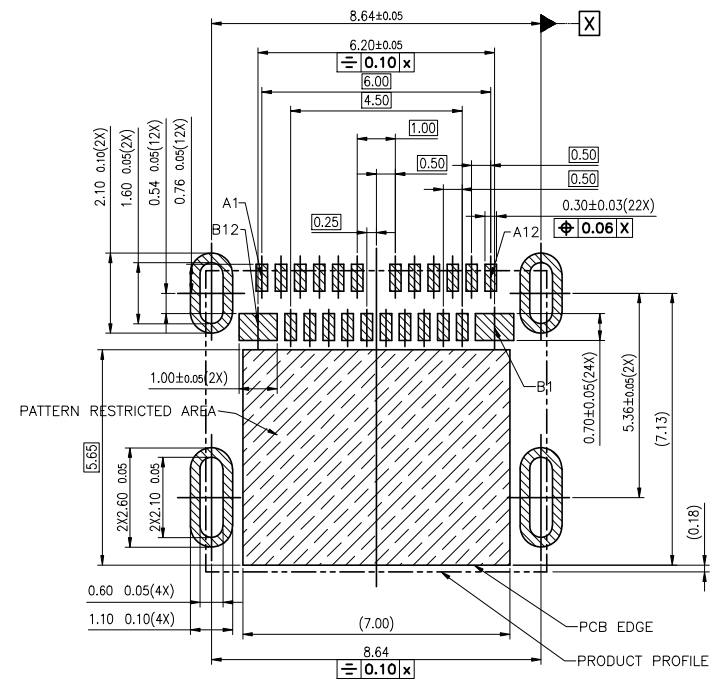
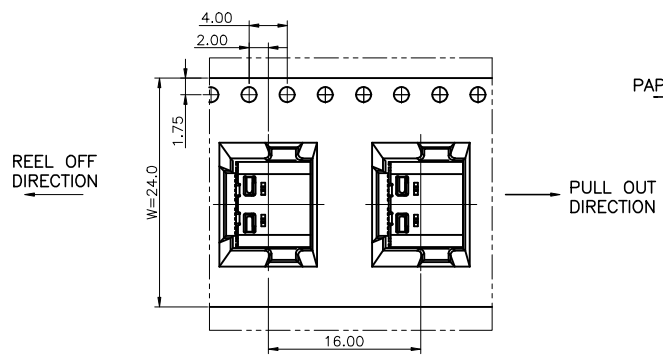
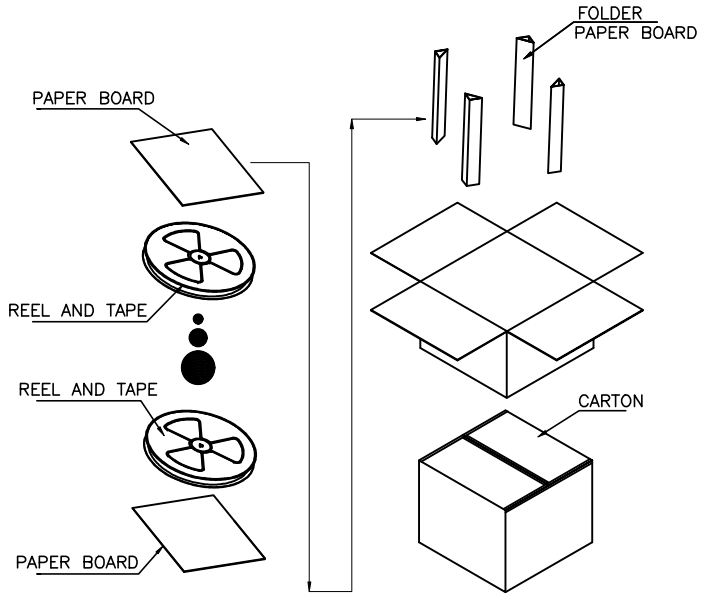
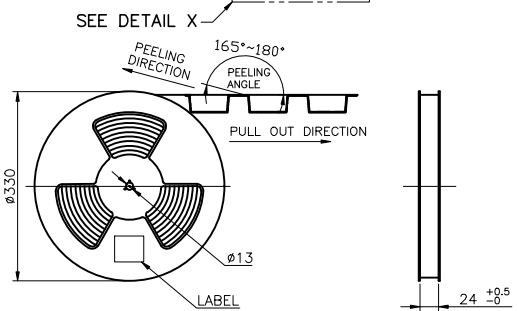
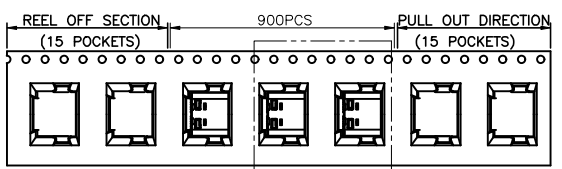

RECOMMENDED PCB LAYOUT(TOP VIEW)
DEFAULT TOLERANCE: ±0.05

UNLESS OTHERWISE SPECIFIED TOLERANCES		东莞市汉博电子科技有限公司 DONGGUAN HANBO TECHNOLOGY CO., LTD			
DECIMALS:	ANGLES:	TITLE	TYPE C等座双排贴片 24PIN四脚DIP L=7.9mm 真仕敏		
X : ±0.35	X : ±2°	DWN	xiong	PART NO. MC-222D	
X.X : ±0.25	X.X : ±1°	CHKD	lee	SCALE:1:1	UNIT: mm
X.XX : ±0.15		APVD	wang	SIZE: A4	SHEET:10F 1
		REV: A4			
CUSTOMER COPY					