

RECOMMENDED P.C.B LAYOUT
TOLERANCE UNSPECIFIED ±0.05mm

NOTES:

- MATERIAL:
MOLDING: LCP UL94V-0
CONTACT: COPPER ALLOY.
2. Finished: contact area: plating Au 0.8u", solder tail: plating Au 0.8u", all plating Ni 40u" SHELL: SUS201-1/2HT=0.30+0.03mm 50U' NICKEL PLATING OVER ALL.
- MECHANICAL:
INSERTION: 5-20N.
EXTRACTION: 8-20N AFTER TEST.
DURABILITY: 8000 CYCLES
- ELECTRICAL:
CURRENT: 5A FOR VBUS:
1.25A FOR GND PIN
0.25A FOR OTHER
VOLTAGE: 20 V MAX
WITHSTANDING VOLTAGE: 100V AC R.M.S.
CONTACT RESISTANCE: 40mΩ MAX.
INSULATION RESISTANCE: 100MΩ MIN.
- ENVIRONMENTAL
TEMPERATURE RANGE -25 ~+85

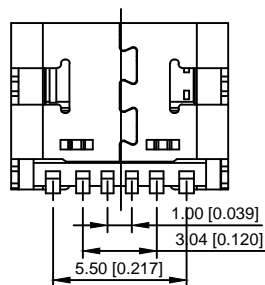
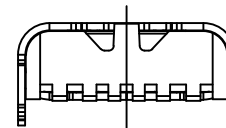
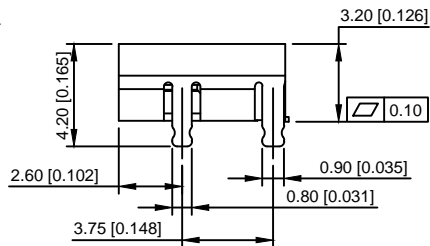
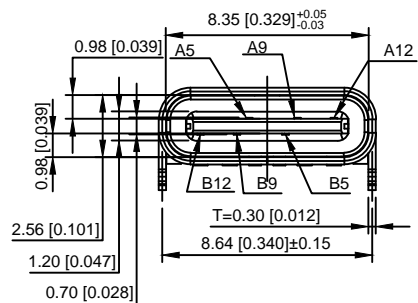
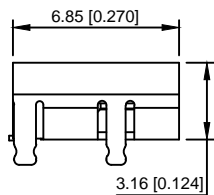

B12	GND
B9	VBUS
B5	CC2
A5	CC1
A9	VBUS
A12	GND
PIN	SIGNAL NAME

new		2015/5/3	A				
ECN BO.		DESCRIPTION.	DATE.		REV.		
DESIGNED	CHECKED	APPROVAL	DRAWING NUMBER	SCALT: 1/2	SCALE: 3:1		
Mikey	Tom	Jerry	PART NAME	HY1-4060568-002	UNLESS OTHERWISE SPECIFIED, TOLERANCE:	X	±0.25
			MODEL NAME	HY1-4060568-002		X.x	±0.20
			3RD ANGLE PROJ	HANYONES TECH CO.,LTD		X.xx	±0.15
				FILE. NO.		ANGULAR	±3'