

Feature

- Forward Current: 2A
- Reverse voltage: 40V
- Low forward voltage
- Low leakage current
- Trench MOS barrier Schottky technology
- Ultra Small mold type. (SOD-323F)

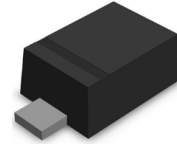

SOD-323F(Top View)

Applications

- Low current rectification
- Voltage clamping
- Protection circuits
- Ultra high-speed switching



Circuit Diagram



Marking (Top View)

Mechanical Characteristics

- Lead finish:100% matte Sn(Tin)
- Mounting position: Any
- Device meets MSL 1 requirements
- Qualified max reflow temperature:260℃

Electrical characteristics per line@25℃

| Parameter | Symbol | Min. | Typ. | Max. | Unit | Conditions |
|----------------------|--------|------|------|------|---------------|---------------------------------|
| Forward voltage | V_F | - | 0.38 | 0.42 | V | $I_F=500\text{mA}$ |
| Forward voltage | V_F | - | 0.42 | 0.46 | V | $I_F=1\text{A}$ |
| Forward voltage | V_F | - | 0.44 | 0.49 | V | $I_F=1.5\text{A}$ |
| Forward voltage | V_F | | 0.47 | 0.53 | V | $I_F=2\text{A}$ |
| Reverse current | I_R | - | - | 50 | μA | $V_R=40\text{V}$ |
| Junction Capacitance | C_J | - | 300 | - | pF | $V_R=0\text{V}$ $f=1\text{MHz}$ |

Absolute maximum rating@25°C

| Parameter | Symbol | limits | Unit |
|---------------------------------------------------------------------------------------------------|-----------|--------|------|
| Reverse voltage(repetitive peak) | V_{RM} | 40 | V |
| Reverse voltage (DC) | V_R | 40 | V |
| Average rectified forward current | I_o | 2 | A |
| Non-Repetitive Peak Forward Surge Current(8.3ms single half sine-wave superimposed on rated load) | I_{FSM} | 15 | A |

| Parameter | Symbol | limits | Unit |
|--------------------------------------|-----------------|------------|------|
| Power Dissipation | PD | 280 | mW |
| Thermal resistance,Note1 | $R_{\theta JA}$ | 350 | °C/W |
| Operating Junction temperature Range | T_J | -55 to 125 | °C |
| Storage temperature | T_{STG} | -55 to 125 | °C |

Note1: R-4 PCB, Minimum recommended pad layout.

Typical Characteristics

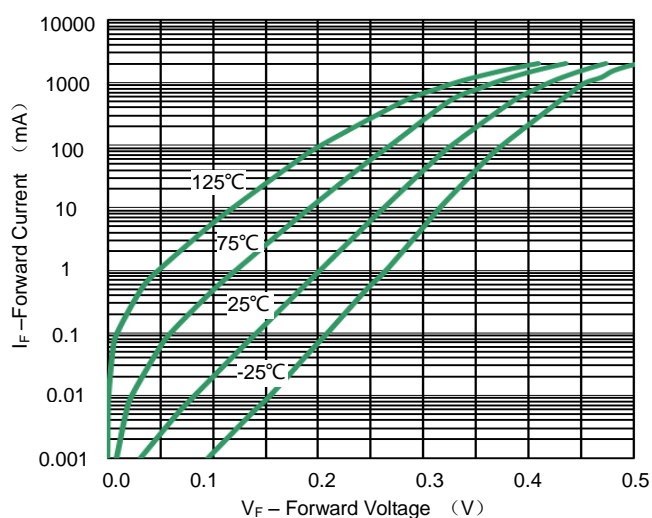

Fig 1. Forward Voltage

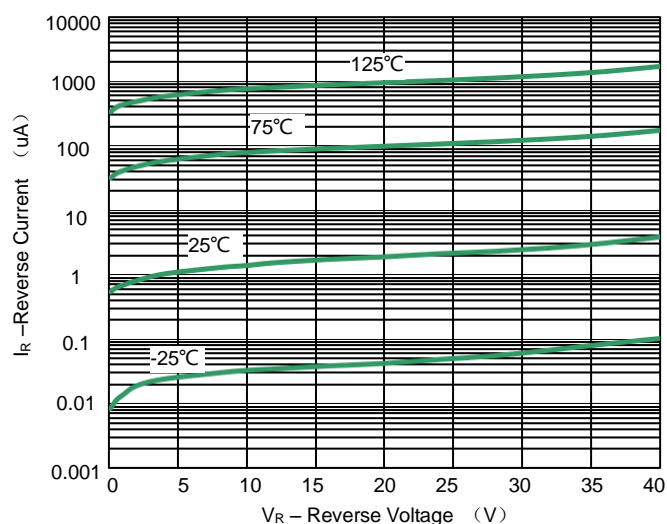

Fig 2. Leakage Current

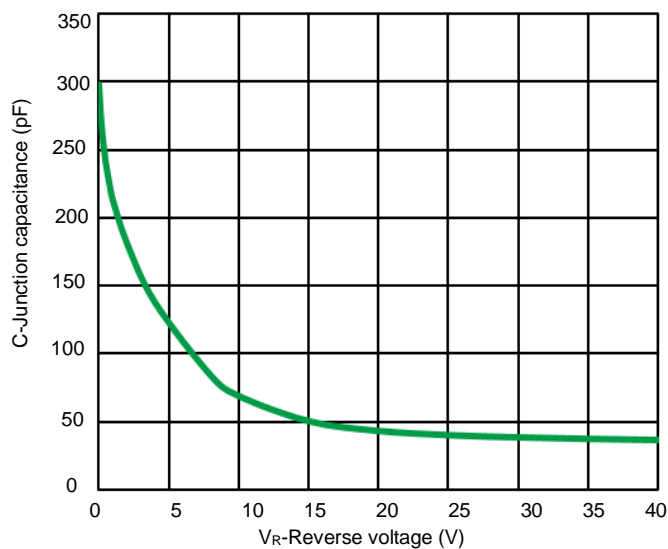
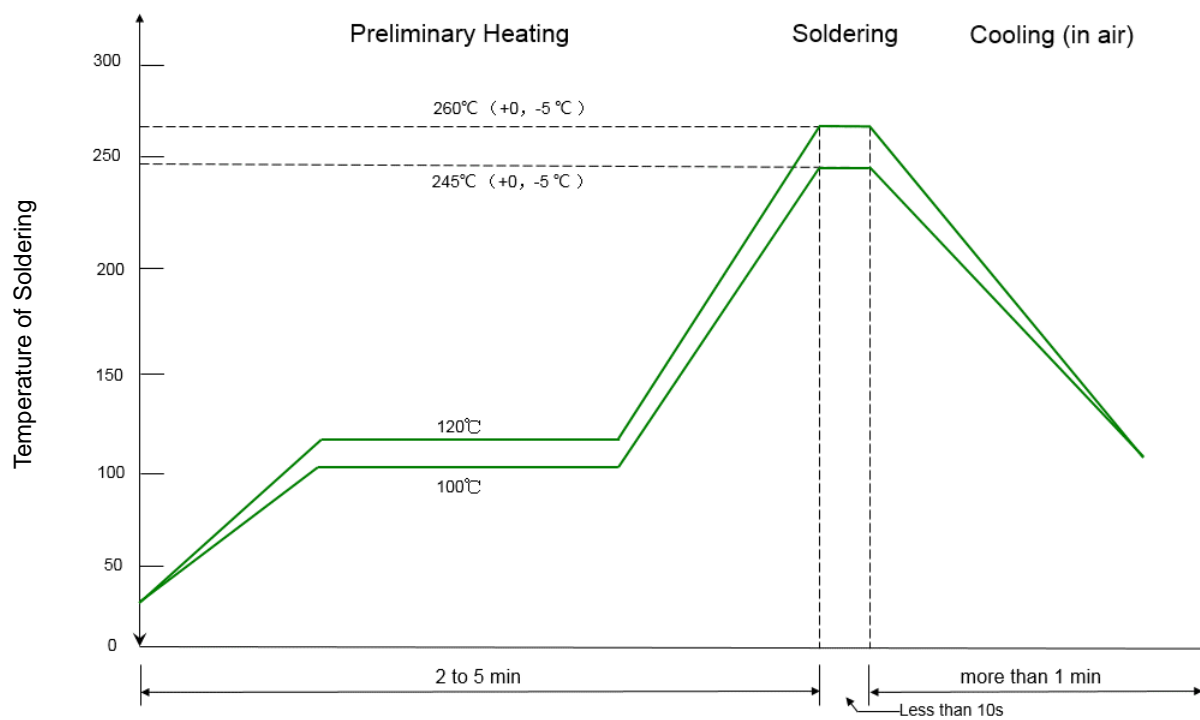

Fig 3. Capacitance vs. Reverse voltage

Solder Reflow Recommendation



Remark: Pb free for 260°C; Pb for 245°C.

Product dimension (SOD-323F)

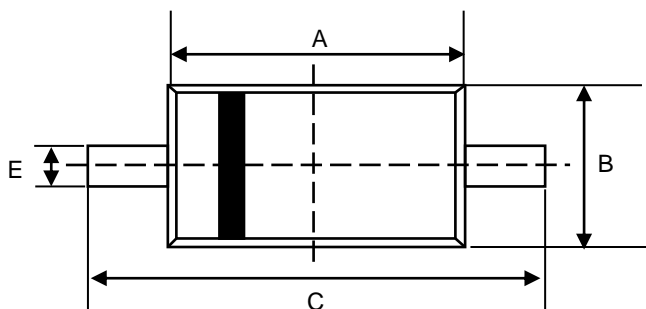

| Dim | Millimeters | | |
|-----|-------------|------|------|
| | MIN | TYP | MAX |
| A | 1.60 | 1.70 | 1.80 |
| B | 1.15 | 1.25 | 1.35 |
| C | 2.30 | 2.50 | 2.70 |
| D | 0.60 | 0.70 | 0.80 |
| E | 0.20 | 0.30 | 0.40 |
| F | 0.08 | 0.13 | 0.18 |

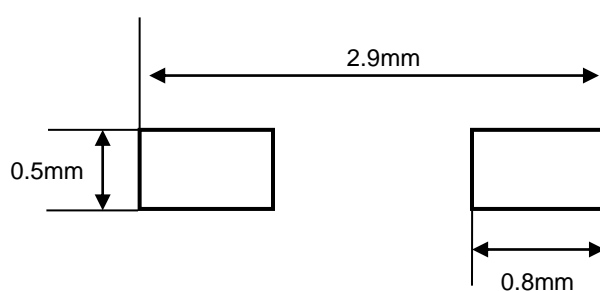
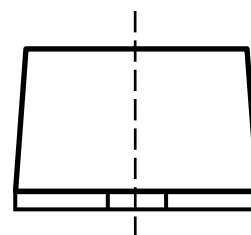
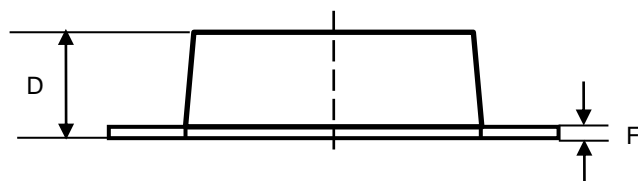

Suggested PCB Layout

Ordering information

| Device | Package | Reel | MPQ |
|--------------|-------------------|------|--------------------|
| PSBD3DF40V2H | SOD-323F(Pb-Free) | 7" | 3000 / Tape & Reel |

Load with information

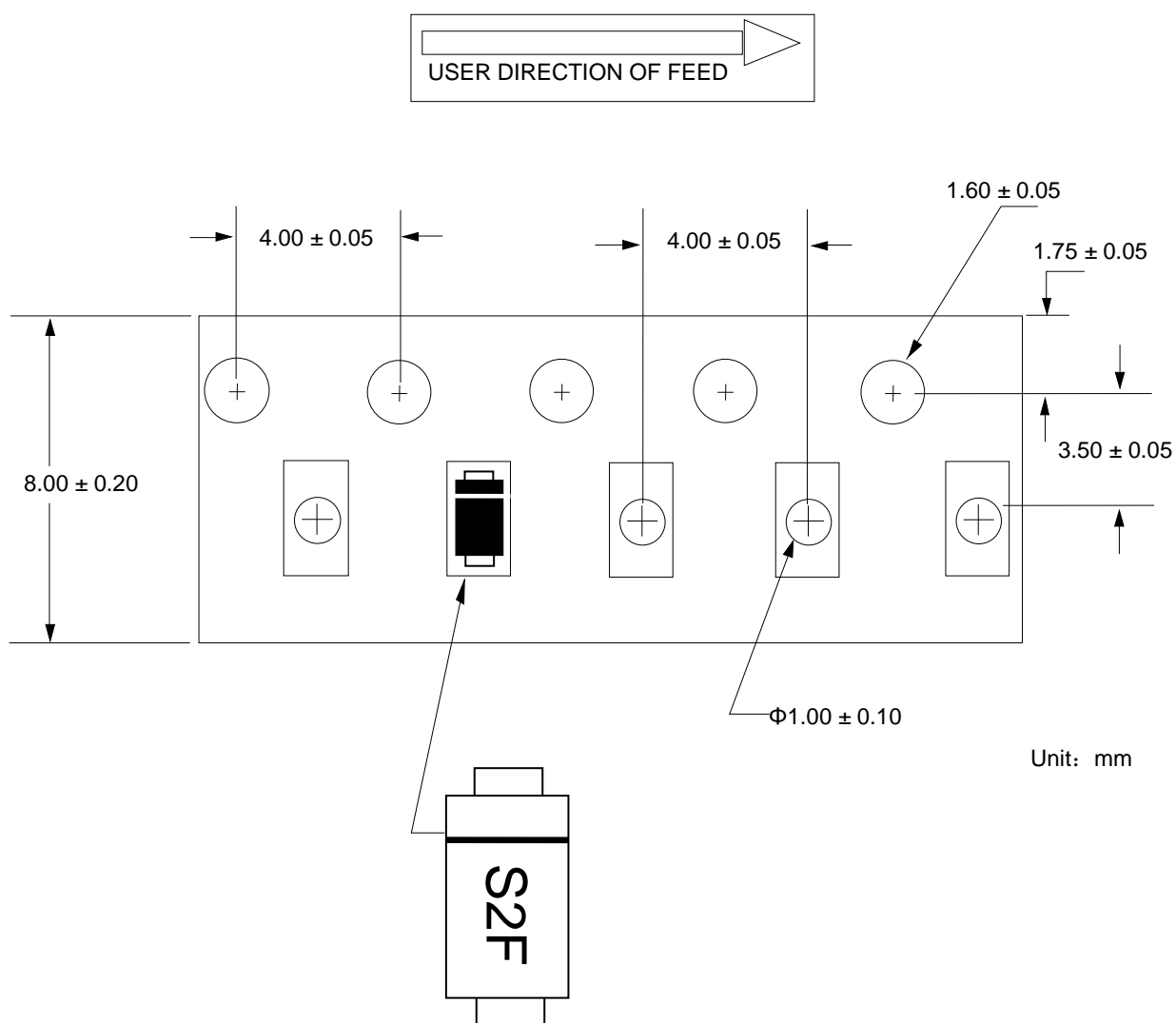

IMPORTANT NOTICE

 and **Prisemi**[®] are registered trademarks of **Prisemi Electronics Co., Ltd (Prisemi)** ,Prisemi reserves the right to make changes without further notice to any products herein. Prisemi makes no warranty, representation or guarantee regarding the suitability of its products for any particular purpose, nor does Prisemi assume any liability arising out of the application or use of any product or circuit, and specifically disclaims any and all liability, including without limitation special, consequential or incidental damages. “Typical” parameters which may be provided in Prisemi data sheets and/or specifications can and do vary in different applications and actual performance may vary over time. All operating parameters, including “Typicals” must be validated for each customer application by customer’s technical experts. Prisemi does not convey any license under its patent rights nor the rights of others. The products listed in this document are designed to be used with ordinary electronic equipment or devices, Should you intend to use these products with equipment or devices which require an extremely high level of reliability and the malfunction of with would directly endanger human life (such as medical instruments, aerospace machinery, nuclear-reactor controllers, fuel controllers and other safety devices), please be sure to consult with our sales representative in advance.

Website: <http://www.prisemi.com>

For additional information, please contact your local Sales Representative.

©Copyright 2009, Prisemi Electronics

 **Prisemi**[®] is a registered trademark of Prisemi Electronics.

All rights are reserved.