

Resistance thermometer measuring transducer - MCR-PT100-I-DC



2810337

<https://www.phoenixcontact.com/us/products/2810337>

Please be informed that the data shown in this PDF document is generated from our Online Catalog. Please find the complete data in the user documentation. Our General Terms of Use for Downloads are valid.



MCR temperature transducer, for Pt 100, 2-, 3-, 4-conductor technology; input: 0 ... 100°C, 0 ... 150°C, 0 ... 200°C, 0 ... 300°C, -50 ... +50°C, -50 ... 100°C, -50 ... 150°C, -50 ... 250°C, output signal: 0(4) ... 20 mA, electrically isolated auxiliary power

Your advantages

- With electrically isolated supply voltage as an option
- Wire-break detection
- Temperature range can be set via DIP switches
- ZERO/SPAN adjustment

Commercial Data

Item number	2810337
Packing unit	1 pc
Minimum order quantity	1 pc
Note	Made to Order (non-returnable)
Sales Key	C01
Product Key	CK1821
Catalog Page	Page 138 (C-7-2013)
Weight per Piece (including packing)	141.1 g
Weight per Piece (excluding packing)	140.4 g
Customs tariff number	85437090
Country of origin	DE

Resistance thermometer measuring transducer - MCR-PT100-I-DC



2810337

<https://www.phoenixcontact.com/us/products/2810337>

Technical Data

Notes

Utilization restriction

EMC note	EMC: class A product, see manufacturer's declaration in the download area
----------	---

Product properties

Product type	Temperature transmitter
--------------	-------------------------

Electrical properties

Alignment span	± 5 %
Alignment zero	± 5 %
Limit frequency (3 dB)	30 Hz
Maximum power dissipation for nominal condition	1.76 mW
Test voltage power supply/signal	750 V AC (50 Hz, 60 s)
Step response (10-90%)	11 ms
Maximum temperature coefficient	≤ 0.02 %/K
Maximum transmission error	≤ 0.4 % (of final value)

Supply

Supply voltage range	20 V DC ... 30 V DC
Max. current consumption	60 mA

Input data

Signal:

Input signal	Temperature
--------------	-------------

Measurement

Configurable/programmable	Yes
Sensor types (RTD) that can be used	Pt 100 (IEC 60751/EN 60751)
Temperature measuring range	0 °C ... 300 °C (0 ... 100/150/200/300) -50 °C ... 250 °C (-50 ... 50/100/150/250)
Sensor type:	-50 °C ... 50 °C (fixed setting) -50 °C ... 100 °C (fixed setting) -50 °C ... 150 °C (fixed setting) -50 °C ... 250 °C (fixed setting) 0 °C ... 100 °C (fixed setting) 0 °C ... 150 °C (fixed setting) 0 °C ... 200 °C (fixed setting) 0 °C ... 300 °C (fixed setting)
Sensor input current	approx. 1 mA

Resistance thermometer measuring transducer - MCR-PT100-I-DC



2810337

<https://www.phoenixcontact.com/us/products/2810337>

Connection technology	2-, 3-, 4-conductor
Connection method	Pluggable screw connection

Output data

Signal:

Current output signal	4 mA ... 20 mA
	0 mA ... 20 mA
Max. current output signal	30 mA
Output current with wire break	> 22 mA
Load/output load current output	$\leq 500 \Omega$

Connection data

Connection method	Screw connection
Stripping length	8 mm
Screw thread	M3
Conductor cross section solid	0.2 mm ² ... 2.5 mm ²
Conductor cross section flexible	0.2 mm ² ... 2.5 mm ²
Conductor cross section AWG	24 ... 14

Dimensions

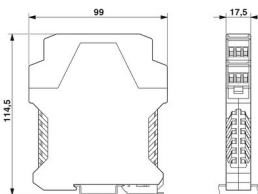
Dimensional drawing	
Width	17.5 mm
Height	99 mm
Depth	114.5 mm

Material specifications

Housing material	Polyamide PA non-reinforced
------------------	-----------------------------

Environmental and real-life conditions

Ambient conditions

Degree of protection	IP20
Ambient temperature (operation)	-20 °C ... 65 °C

Approval data

CE

Certificate	CE-compliant
-------------	--------------

Resistance thermometer measuring transducer - MCR-PT100-I-DC



2810337
<https://www.phoenixcontact.com/us/products/2810337>

UL, USA / Canada

Identification	UL 508 Recognized
----------------	-------------------

Mounting

Mounting position	any
-------------------	-----

Resistance thermometer measuring transducer - MCR-PT100-I-DC

2810337

<https://www.phoenixcontact.com/us/products/2810337>

Drawings

Circuit diagram

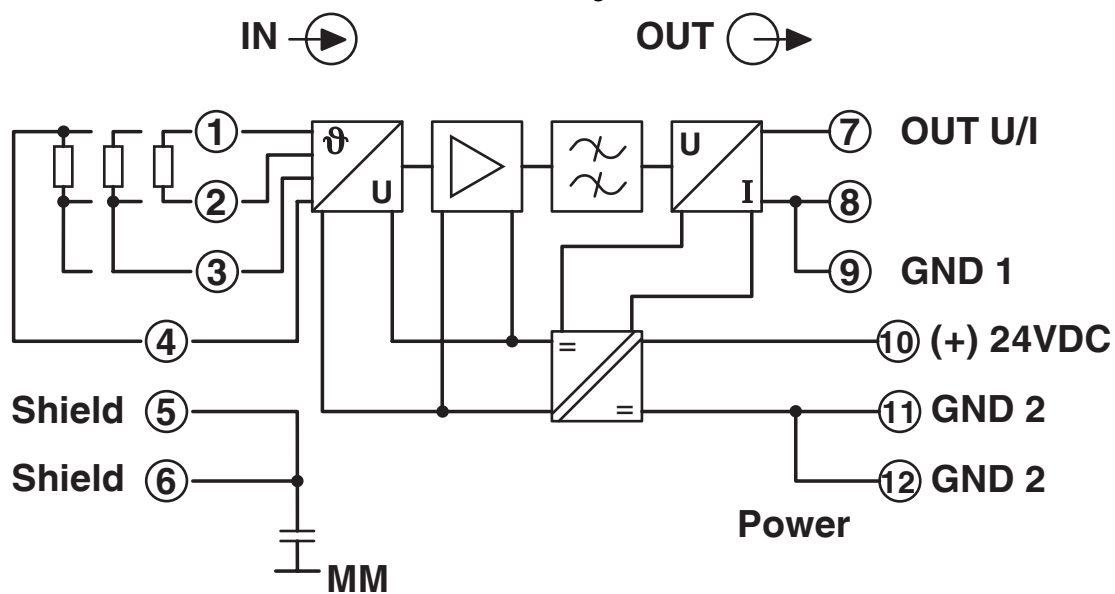

Dimensional drawing

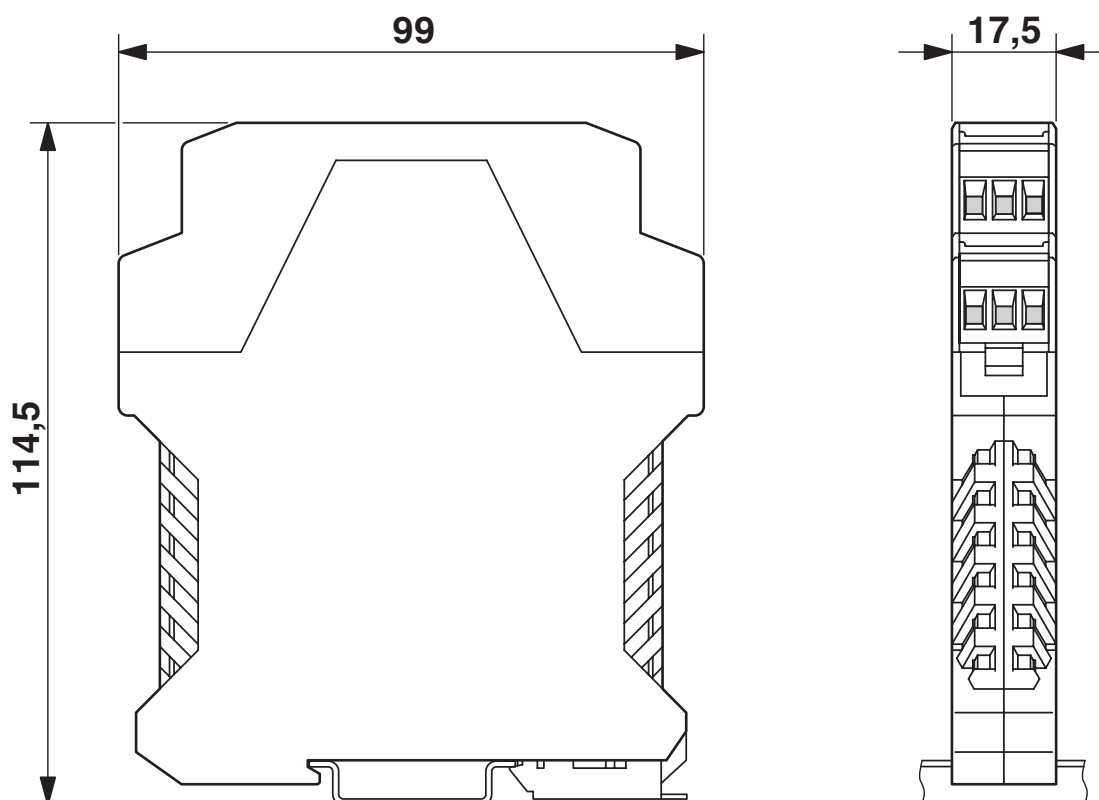

Resistance thermometer measuring transducer - MCR-PT100-I-DC

2810337

<https://www.phoenixcontact.com/us/products/2810337>

Application drawing

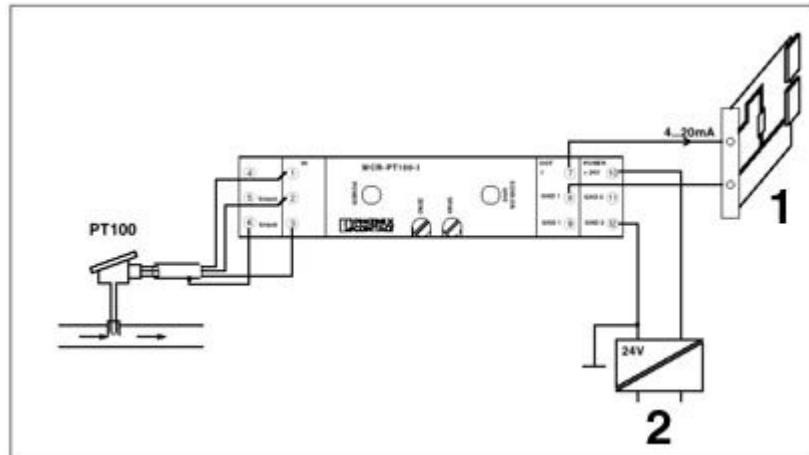

Application example: temperature measurement in 3-conductor technology

1 = controller

2 = mains voltage

Resistance thermometer measuring transducer - MCR-PT100-I-DC



2810337

<https://www.phoenixcontact.com/us/products/2810337>

Classifications

ECLASS

ECLASS-9.0	27210129
ECLASS-10.0.1	27210129
ECLASS-11.0	27210129

Resistance thermometer measuring transducer - MCR-PT100-I-DC



2810337
<https://www.phoenixcontact.com/us/products/2810337>

Environmental Product Compliance

China RoHS	Environmentally Friendly Use Period = 50 years
	For information on hazardous substances, refer to the manufacturer's declaration available under "Downloads"

Phoenix Contact 2022 © - all rights reserved
<https://www.phoenixcontact.com>

Phoenix Contact USA
586 Fulling Mill Road
Middletown, PA 17057, United States
(+717) 944-1300
info@phoenixcon.com