

PLEASE CHECK WWW.MOLEX.COM FOR LATEST PART INFORMATION

Part Number:

0622018682

Status:

Active

Overview:

Application Tooling

Description:

GbX I-Trac Enhanced Daughter Card Press-In Tool

Documents:

RoHS Certificate of Compliance (PDF)

General	
Product Family	Application Tooling
Series	207123
Comments	See Tooling Specification (PDF) Above
Function	Insertion
Geographic Area	Global
Level of Automation	Manual
More Detailed Tech Information	applicationtooling@molex.com
Overview	Application Tooling
Product Name	GbX I-Trac
Tool Type	Press-Fit Insertion Tool
UPC	884982788107
Warranty Disclaimer	CAUTION: Molex tooling crimp specifications are valid only when used with Molex terminals and tooling manufactured by Molex and sold by Molex or authorized distributors ("Molex Tooling"). When using tooling other than Molex Tooling with Molex specific connector systems listed in our ATS documents, the Molex tooling qualification does not apply and the responsibility for full qualification of the connector system is that of the customer. Molex accepts no liability for connector performance or tooling support where tooling other than Molex Tooling is used or where Molex Tooling is modified.

Material Info

Reference - Drawing Numbers

Application Tooling Documents

ATS-622018682

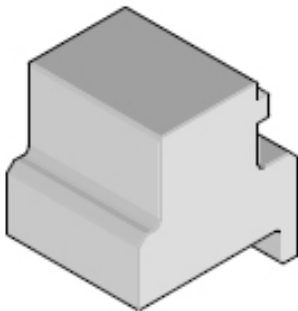

Series image - Reference only

EU ELV Not Reviewed	
EU RoHS Not Reviewed	China RoHS
REACH SVHC Not Reviewed	
Halogen-Free Status	
Not Reviewed	
For more information, please visit Contact US	
China ROHS	Not Reviewed
ELV	Not Reviewed
RoHS Phthalates	Not Reviewed

Search Parts in this Series

207123 Series

Use With

170660 GbX I-Trac Enhanced Daughtercard
Signal Module Assembly

PLEASE CHECK WWW.MOLEX.COM FOR LATEST PART INFORMATION