

DESCRIPTION: HIGH DENSITY FEMALE - VERTICAL DIP SOLDER

DIMENSIONS (inch/mm)

Insulator Material	No. OF PINS	A	B	C	D	E	F	G	H
PA9T	15	1.213	0.984	0.643	0.311	0.090	0.756	0.496	0.429
		30.80	24.99	16.34	7.90	2.29	19.20	12.60	10.90
PA9T	26	1.543	1.312	0.972	0.311	0.090	1.091	0.496	0.429
		39.20	33.32	24.70	7.90	2.29	27.70	12.60	10.90
PA9T	44	2.087	1.852	1.512	0.311	0.090	1.618	0.496	0.429
		53.00	47.04	38.40	7.90	2.29	41.10	12.60	10.90
PA6T	62	2.732	2.500	2.157	0.311	0.095	2.256	0.496	0.429
		69.40	63.50	54.80	7.90	2.41	57.30	12.60	10.90
PA6T	78	2.638	2.406	2.055	0.429	0.095	2.169	0.606	0.526
		67.00	61.10	52.20	10.90	2.41	55.10	15.40	13.35

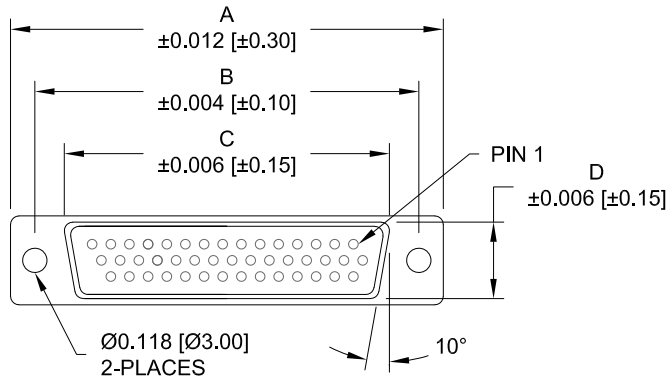

4 ROWS

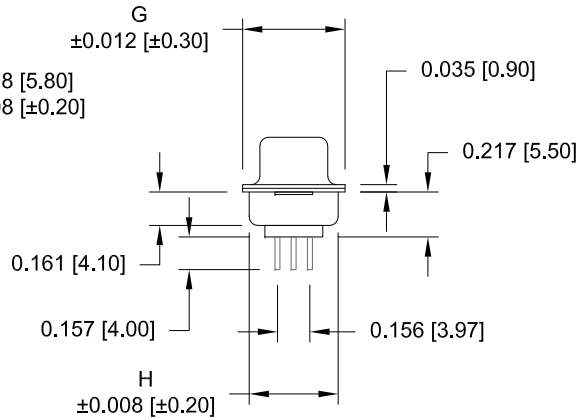
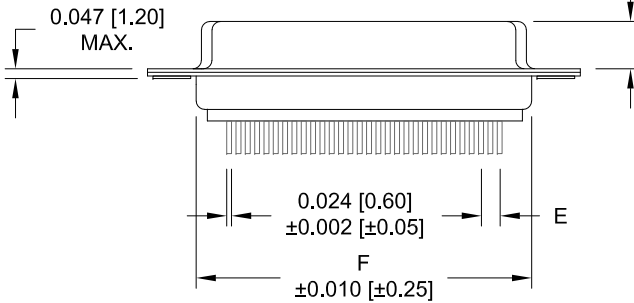

180-YYY-213RYY1

- SERIES
- POSITIONS
  - 015
  - 026
  - 044
  - 062
  - 078
- GENDER
- TERMINATION
  - 2 = FEMALE
  - 1 = VERTICAL DIP SOLDER
- SHELL PLATING
  - 2 = TIN (DISCONTINUED)
  - 3 = NICKEL
- RoHS COMPLIANT (260°C)
- HARDWARE OPTIONS
  - 00 = NO HARDWARE
  - 01 = .098" CLINCH NUT (BOARD SIDE)
  - 02 = .236" CLINCH NUT (BOARD SIDE)
  - 03 = .236" CLINCH NUT (MATING SIDE)
  - 05 = .237" 4-40 BOARD LOCK
  - 08 = .224" 4-40 BOARD LOCK
  - 90 = .237" 4-40 BOARD LOCK FOR 0.093" BOARD MAX.
  - 91 = .237" 4-40 SPACER/BOARD LOCK
  - 92 = .237" 4-40 SPACER/BOARD LOCK FOR 0.093" BOARD MAX.
- PLATING OPTIONS
  - 1 = GOLD FLASH
  - A = 30u" GOLD MATING AREA, GOLD FLASH OVERALL

**MATERIAL:**

- SHELL: NICKEL PLATED STEEL
- INSULATOR: GLASS FILLED THERMOPLASTIC, UL94 V-0
- CONTACT: GOLD PLATED BRASS OVER NICKEL

**ELECTRICAL:**

- CURRENT RATING: 3 AMPS
- CONTACT RESISTANCE: 15 mOhms Max.
- INSULATION RESISTANCE: 1,000 MOhms min.
- VOLTAGE: 500VAC FOR 1 MINUTE
- TEMPERATURE: -50° C TO 100° C

UNITS = inch [mm]

**DO NOT SCALE FROM DRAWING**

**RoHS COMPLIANT**



THESE DRAWINGS AND SPECIFICATIONS ARE THE PROPERTY OF NorComp AND SHALL NOT BE REPRODUCED, COPIED OR USED AS THE BASIS FOR THE MANUFACTURE OF SALE OF APPARATUS WITHOUT WRITTEN PERMISSION.

**NorComp**

DRAWN: PAM JENKINS		DATE: 09-12-05	
SCALE: NTS	SHEET 1 OF 3	REV 24	
DWG NO. 180-YYY-213RYY1			

DESCRIPTION: PCB LAYOUT - VERTICAL - FEMALE

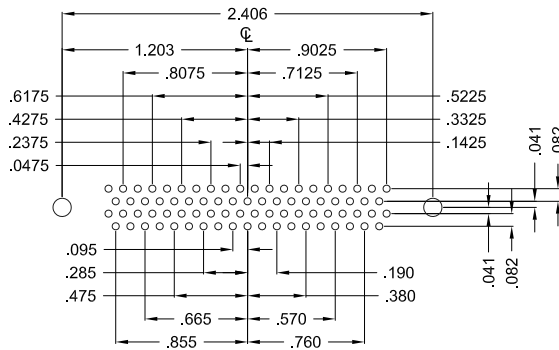
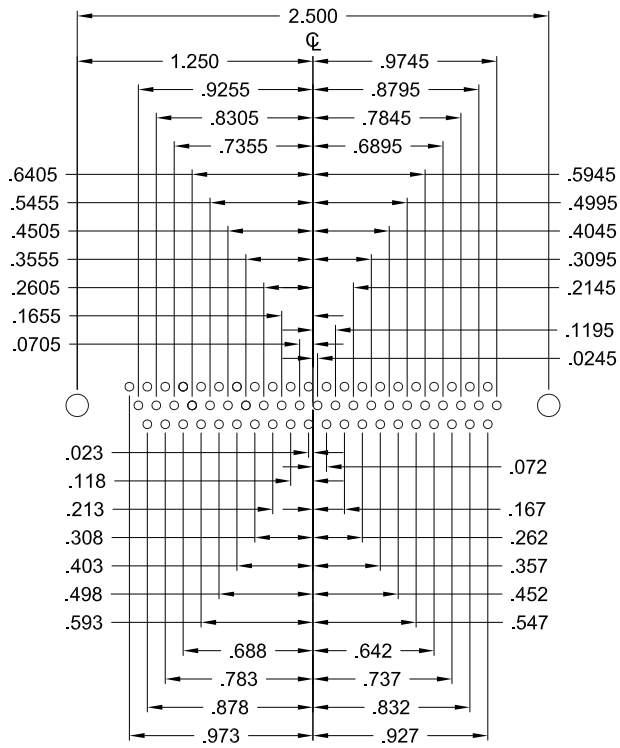
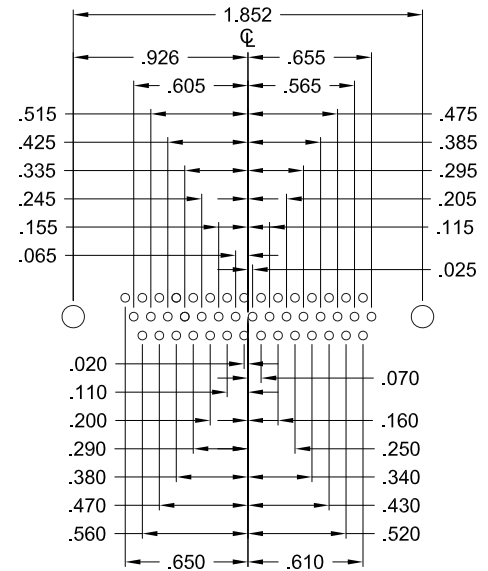
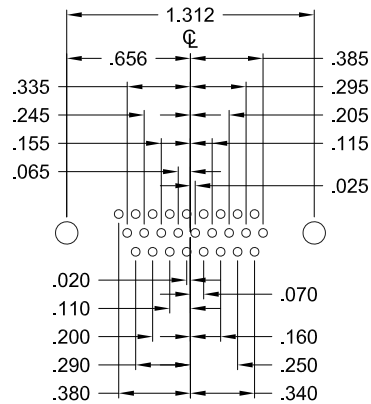
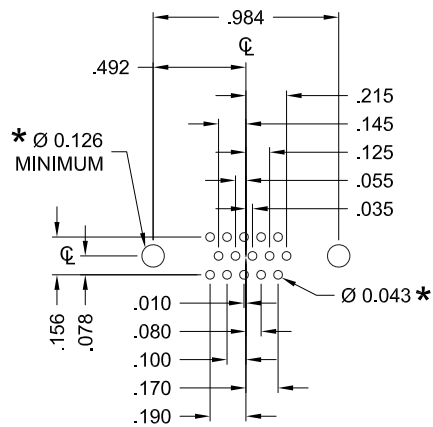

HOLE PATTERN SHOWN ARE FOR FEMALE

UNITS = inch

\* TYP. SUGGESTED SIZE MAY NOT BE SUITABLE FOR ALL APPLICATIONS

DO NOT SCALE FROM DRAWING



THESE DRAWINGS AND SPECIFICATIONS ARE THE PROPERTY OF NorComp AND SHALL NOT BE REPRODUCED, COPIED OR USED AS THE BASIS FOR THE MANUFACTURE OF SALE OF APPARATUS WITHOUT WRITTEN PERMISSION.

DRAWN:		DATE:	
PAM JENKINS		09-12-05	

NorComp

SCALE:	SHEET	OF	REV
NTS	2	3	24

DWG NO. 180-YYY-213RYY1

ALL CLINCH-NUTS ARE 4-40 INTERNAL THREADS

01X ..... 0.098" (BOARD SIDE)

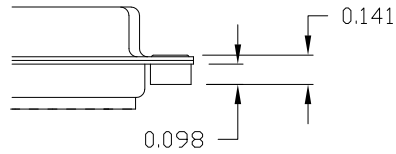

02X ..... 0.236" (BOARD SIDE)

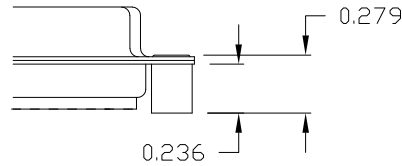

03X..... 0.236" (MATING SIDE)

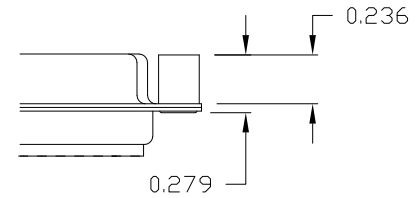

05X ..... 0.237" (BOARD SIDE)

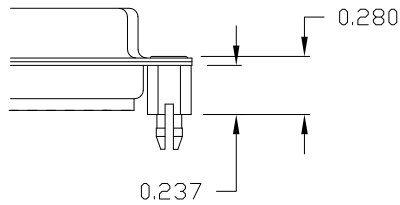

08X ..... 0.228" (BOARD SIDE)

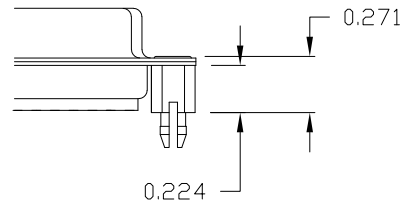

91X ..... 0.237" BOARD SIDE

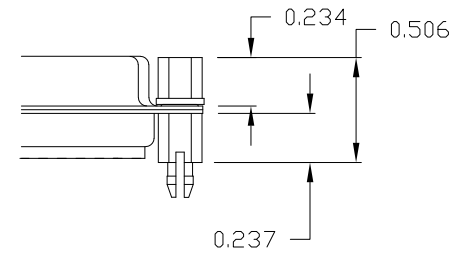

NOTE: 4-40 FEMALE SCREW LOCK IS REMOVABLE

90X ..... 0.237" (BOARD SIDE)

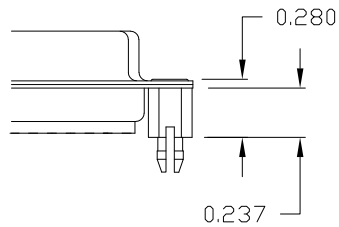

92X ..... 0.237" BOARD SIDE

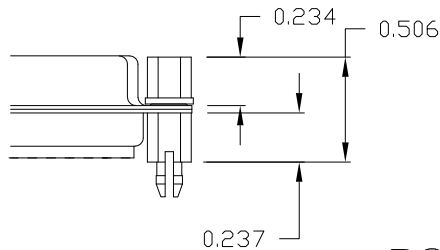

NOTE: 4-40 FEMALE SCREW LOCK IS REMOVABLE

UNITS = inch

**TOLERANCE:**

ALL DIMENSIONS ARE ±0.010

**DO NOT SCALE FROM DRAWING**

NOTE: 90 & 92 OPTION FOR 0.093" MAX. BOARD THICKNESS



THESE DRAWINGS AND SPECIFICATIONS ARE THE PROPERTY OF NorComp AND SHALL NOT BE REPRODUCED, COPIED OR USED AS THE BASIS FOR THE MANUFACTURE OF SALE OF APPARATUS WITHOUT WRITTEN PERMISSION.

DRAWN:

PAM JENKINS

DATE:

09-12-05

**NorComp**

SCALE:

NTS

SHEET

3

OF

3

REV

24

DWG NO.

180-YYY-213RYY1

**RoHS COMPLIANT**