

## 2 Elements Power Protection Arrester AE D17 Series

ACPA AE Ø11.8mm, 17.0mm long

### SPECIFICATION

Model Name	DC Breakdown Voltage	Maximum Impulse Breakdown Voltage		Maximum Impulse Discharge Current		Normal Alternating Discharge Current		Impulse Life	DC Holdover Voltage	Minimum Insulation Resistance	Maximum Capacitance
	(V)	(V)		(8/20 $\mu$ s) (KA)		(A)		(10/1000 $\mu$ s) (500A)	(V)	(G $\Omega$ )	(pf)
	100V/s	100V/ $\mu$ s	1000V/ $\mu$ s	1 time	5 times	50Hz, 1sec	Single 9cycles	times	<150ms	Note 2	1MHZ
<b>D17-230</b>	230 $\pm$ 20%	600	700	100	60	60	300	400	135	1	10
<b>D17-250</b>	250 $\pm$ 20%	600	700	100	60	60	300	400	135	1	10
<b>D17-300</b>	300 $\pm$ 20%	700	800	100	60	60	300	400	135	1	10
<b>D17-350</b>	350 $\pm$ 20%	800	900	100	60	60	300	400	135	1	10
<b>D17-420</b>	420 $\pm$ 20%	900	1000	100	60	60	300	400	135	1	10
<b>D17-470</b>	470 $\pm$ 20%	900	1100	100	60	60	300	400	135	1	10
<b>D17-600</b>	600 $\pm$ 20%	1100	1300	100	60	60	300	400	135	1	10
<b>D17-700</b>	700 $\pm$ 20%	1200	1400	100	60	60	300	400	135	1	10
<b>D17-800</b>	800 $\pm$ 20%	1300	1500	100	60	60	300	400	135	1	10

### NOTE

1 : UL1449 C-UL 4th Recognized, File E315423

2 : DC Breakdown Voltage

DC Measuring Voltage

230-350V

100V

420-800V

250V

### Dimensions Unit: mm

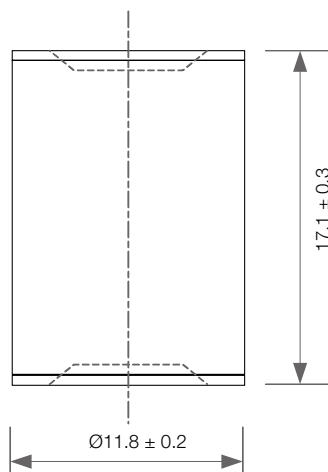

### Marking

